



THE COUNTY OF GALVESTON

RUFUS G. CROWDER, CPPO CPPB
PURCHASING AGENT

GWEN MCLAREN, CPPB
ASST. PURCHASING AGENT

COUNTY COURTHOUSE
722 Moody (21st Street)
Fifth (5th) Floor
GALVESTON, TEXAS 77550
(409) 770-5371

April 4, 2017

RE: ADDENDUM #1
Bid #B171018 San Leon Roads Reconstruction

To All Prospective Bidders,

Attached you will find Addendum #1 for Bid #B171018 San Leon Roads Reconstruction.

QUESTION DEADLINE:

Questions regarding this bid must be submitted via email to Rufus Crowder at rufus.crowder@co.galveston.tx.us, by April 7, 2017 at 5:00 p.m. CST.

As a reminder, all questions regarding this bid must be submitted in writing to:

Rufus G. Crowder, CPPO CPPB
Galveston County Purchasing Agent
722 Moody, Fifth (5th) Floor
Galveston, Texas 77550
E-mail: rufus.crowder@co.galveston.tx.us

If you have any further questions regarding this bid, please address them to Rufus Crowder, CPPO CPPB, Purchasing Agent, via e-mail at rufus.crowder@co.galveston.tx.us, or contact the Purchasing Department at (409) 770-5371.

Please excuse us for any inconvenience that this may have caused.

Sincerely,

A handwritten signature in black ink, appearing to read "Rufus", with a long horizontal flourish extending to the right.

Rufus G. Crowder, CPPO CPPB
Purchasing Agent
Galveston County

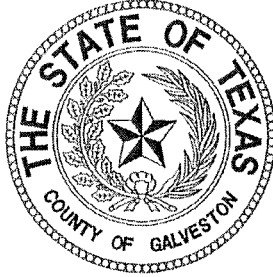

COUNTY OF GALVESTON

ADDENDUM No. 1
APRIL 4, 2017

PROJECT NAME: SAN LEON ROADS RECONSTRUCTION

BID NO: B171018

ORIGINAL BID DATE: 4/20/2017

REVISED BID DATE: N/A

CONSULTANT CONTACT: JOSHUA NETARDUS, P.E.

This Addendum forms a part of the Bidding Documents and will be incorporated into the Contract documents, as applicable. This Addendum addresses comments and questions made in writing. Insofar as the original Project Manual and Drawings are inconsistent, this Addendum governs.

CONSTRUCTION CONTRACT DOCUMENTS

CHANGES:

1. Replace page 42 of Project Manual with the attached page 42. The following changes have been made:
 - a. Revised Contract Period from 180 calendar days to 210 calendar days.
2. Replace the Bid Form (pages 54-78 of the Project Manual) in its entirety with the attached Bid Form. The following changes have been made:
 - a. 14th Street Bid Items:
 - i. Removed "Select Fill" Bid Item
 - ii. Revised Item 3 "Excavation (Roadway and Roadside Ditches)" quantity to 1,200 CY.

- iii. Added Item 20 – 7” Thick Flexible Base, Type A or D, Grade 1 or 2.
- b. 15th Street Section Bid Items:
 - i. Revised Item 3 “Excavation (Roadway and Roadside Ditches)” quantity to 4,250 CY.
 - ii. Added Item 27 – 7” Thick Flexible Base, Type A or D, Grade 1 or 2.
- c. 16th Street Section:
 - i. Removed “Select Fill” Bid Item
 - ii. Revised Item 3 “Excavation (Roadway and Roadside Ditches)” quantity to 4,100 CY.
 - iii. Added Item 25 – 7” Thick Flexible Base, Type A or D, Grade 1 or 2.
- d. Avenue D Section:
 - i. Revised Item 3 “Excavation (Roadway and Roadside Ditches)” quantity to 2,100 CY.
 - ii. Revised Item 4 “Select Fill” quantity to 1,600 CY.
 - iii. Added Item 26 – 7” Thick Flexible Base, Type A or D, Grade 1 or 2.

- 3. Add attached page 88a of 105 “Certification Regarding Lobbying” to Project Manual.

TECHNICAL SPECIFICATIONS

N/A

CONSTRUCTION DRAWINGS

REPLACEMENTS:

- 1. Replace plan sheet 5 and 7-30 with the attached revised plan sheets 5 and 7-30.

QUESTIONS AND CLARIFICATIONS

N/A

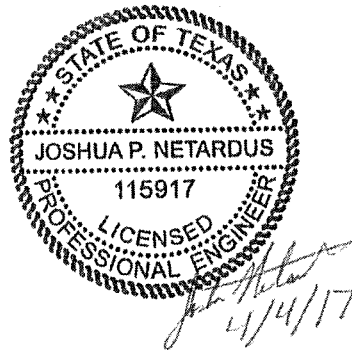

Acknowledgment of this Addendum is required for official submittal for the bidding process.

END OF ADDENDUM NO. 1

37. Contract Documents and Drawings

The Local Public Agency will furnish the Contractor without charge copies of the Contract Documents, including Technical Specifications and Drawings. Additional copies requested by the Contractor will be furnished at cost.

38. Contract Period

The work to be performed under this contract shall commence within the time stipulated by the Owner in the Notice to Proceed, and shall be fully completed within 210 calendar days thereafter.

39. Keeping Of Plans And Specifications Accessible

The Contractor shall keep one (1) copy of all Plans and Specifications constantly accessible at the work site and available for inspection at all times.

40. Utilities

Contractor shall be responsible for any charges which may be made by any city or utility companies for the work to be performed by Contractor.

41. Parking

Contractor shall be responsible for the expense of parking the Contractor's vehicle(s) in a legal manner and at no expense or inconvenience to the County.

42. Fire And Safety

Contractor is completely responsible for fire protection at the job site as well as the safety of its own employees as well as those entering onto the job site.

43. Contractor's Buildings

The building of structures for housing men, or the erection of tents or other forms of protection will be permitted only at such places as the County shall permit, and the sanitary conditions of the grounds in or about such structures shall at all times be maintained in the manner satisfactory to the County.

44. Worksite Security

Contractor shall maintain the security of the worksite.

Contractor shall provide adequate protection to persons on the worksite, adjacent properties, and utilities as is necessary to keep each free of damage or injury. Contractor shall furnish all barricades, warning lights and other safety devices necessary for the safety and protection of the public and shall remove them upon completion of the work performed on those premises under the terms of this contract.

Contractor will have complete control over the work site and shall be fully responsible for any loss of or damage to any County property from any cause and will reimburse County in the event of any loss or damage to County's property from any cause.

Contractor shall take proper means to protect adjacent or adjoining properties which might be injured or seriously affected by construction undertaken under this Agreement from any damage or injury by reason of

**BID FORM
SAN LEON STREETS
RECONSTRUCTION
GALVESTON COUNTY**

SITE PERPARATION AND EARTHWORK (14TH STREET)

ITEM NUMBER	SPEC. NUMBER	DESCRIPTION	UNIT	QTY	UNIT PRICE IN WORDS	UNIT COST	TOTAL COST
1	500	Mobilization	LS	1	Dollars and _____ Cents	\$ _____	\$ _____
2	100	Preparation of Right of Way	AC	2	Dollars and _____ Cents	\$ _____	\$ _____
3	110	Excavation (Roadway and Roadside Ditches)	CY	1,200	Dollars and _____ Cents	\$ _____	\$ _____
4	105	Remove and Dispose of Existing Asphalt Pavement and Base (all depths)	SY	900	Dollars and _____ Cents	\$ _____	\$ _____
5	105	Remove and Dispose of Existing Gravel Roadway (all depths)	SY	1,576	Dollars and _____ Cents	\$ _____	\$ _____
6	104, 105, 400	Remove and Dispose of Ex. Driveway (all materials, all depths)	SY	581	Dollars and _____ Cents	\$ _____	\$ _____
7	496	Remove and Dispose of Ex. 15" Culvert (all materials)	LF	170	Dollars and _____ Cents	\$ _____	\$ _____
8	496	Remove and Dispose of Ex. 18" Culvert (all materials)	LF	260	Dollars and _____ Cents	\$ _____	\$ _____
9	496	Remove and Dispose of Ex. 24" Culvert (all materials)	LF	72	Dollars and _____ Cents	\$ _____	\$ _____
10	496	Remove and Dispose of Ex. 30" Culverts (all materials)	LF	11	Dollars and _____ Cents	\$ _____	\$ _____
Site Preparation and Earthwork Subtotal							\$ _____

**BID FORM
SAN LEON STREETS
RECONSTRUCTION
GALVESTON COUNTY**

STORM SEWER AND DRAINAGE ITEMS (14TH STREET)

ITEM NUMBER	SPEC. NUMBER	DESCRIPTION	UNIT	QTY	UNIT PRICE IN WORDS	UNIT COST	TOTAL COST
11	464	18" RCP Culvert	LF	471	Dollars and _____ Cents	\$ _____	\$ _____
12	464	24" RCP Culvert	LF	70	Dollars and _____ Cents	\$ _____	\$ _____
13	COG 02619	30" HDPE Storm Sewer	LF	120	Dollars and _____ Cents	\$ _____	\$ _____
14	462	5' x 3' RCB (including bedding & backfill)	LF	38	Dollars and _____ Cents	\$ _____	\$ _____
15	760	Regrade Ex. Roadside Ditches	LF	88	Dollars and _____ Cents	\$ _____	\$ _____
16	466	Structural Concrete, Headwalls	CY	44	Dollars and _____ Cents	\$ _____	\$ _____
17	Per Project Manual/D	Diversion Pumping	LS	1	Dollars and _____ Cents	\$ _____	\$ _____
Storm Sewer Subtotal							\$ _____

PAVING ITEMS (14TH STREET)

ITEM NUMBER	SPEC. NUMBER	DESCRIPTION	UNIT	QTY	UNIT PRICE IN WORDS	UNIT COST	TOTAL COST
18	260	Lime Stabilized Subgrade Manipulation (6" depth)	SY	3,970	Dollars and _____ Cents	\$ _____	\$ _____
19	260	Hydrated Lime for Stabilization (7%)	TON	69	Dollars and _____ Cents	\$ _____	\$ _____
20	247	7" Flexible Base, Type A or D, Grade 1 or 2	SY	3,970	Dollars and _____ Cents	\$ _____	\$ _____
21	341	HMAC Type "D" Surface Course, 2" Thick	SY	3,300	Dollars and _____ Cents	\$ _____	\$ _____
22	310	Prime Coat (0.30 GAL/SY) for Roadway	GAL	990	Dollars and _____ Cents	\$ _____	\$ _____

**BID FORM
SAN LEON STREETS
RECONSTRUCTION
GALVESTON COUNTY**

ITEM NUMBER	SPEC. NUMBER	DESCRIPTION	UNIT	QTY	UNIT PRICE IN WORDS	UNIT COST	TOTAL COST
23	530	Replace Ex. Driveways with Gravel to ROW (includes subgrade and base preparation)	SY	481	Dollars and _____ Cents	\$ _____	\$ _____
24	530	Replace Ex. Driveways with Concrete to ROW (includes subgrade and base preparation)	SY	104	Dollars and _____ Cents	\$ _____	\$ _____
Paving Subtotal							\$ _____

SIGNING AND PAVEMENT MARKINGS ITEMS (14TH STREET)

ITEM NUMBER	SPEC. NUMBER	DESCRIPTION	UNIT	QTY	UNIT PRICE IN WORDS	UNIT COST	TOTAL COST
25	666	REFL MRK TY II (W) 24" (SLD)	LF	15	Dollars and _____ Cents	\$ _____	\$ _____
26	666	REFL MRK TY II (Y) 4" (SLD)	LF	2,730	Dollars and _____ Cents	\$ _____	\$ _____
27	636	SMALL SIGNS	EA	1	Dollars and _____ Cents	\$ _____	\$ _____
Signing and Pavement Markings Subtotal							\$ _____

Traffic Control Items (14th Street)

ITEM NUMBER	SPEC. NUMBER	DESCRIPTION	UNIT	QTY	UNIT PRICE IN WORDS	UNIT COST	TOTAL COST
28	247	Temporary Pavement, for Gravel Roads	SY	72	Dollars and _____ Cents	\$ _____	\$ _____
29	341	Temporary Pavement, for Asphalt Roads	SY	217	Dollars and _____ Cents	\$ _____	\$ _____

**BID FORM
SAN LEON STREETS
RECONSTRUCTION
GALVESTON COUNTY**

ITEM NUMBER	SPEC. NUMBER	DESCRIPTION	UNIT	QTY	UNIT PRICE IN WORDS	UNIT COST	TOTAL COST
30	247	Temporary Driveways	EA	16	Dollars and _____ Cents	\$ _____	\$ _____
31	502	Barricades, Signs, and Traffic Handling (includes the installation, maintenance, and removal of all traffic control devices)	LS	1	Dollars and _____ Cents	\$ _____	\$ _____
32	502	Portable Message Signs	EA	2	Dollars and _____ Cents	\$ _____	\$ _____
Traffic Control Subtotal							\$ _____

STORM WATER POLLUTION PREVENTION PLAN ITEMS (14TH STREET)

ITEM NUMBER	SPEC. NUMBER	DESCRIPTION	UNIT	QTY	UNIT PRICE IN WORDS	UNIT COST	TOTAL COST
33	164	Turf Establishment by Hydromulch Seeding of All Areas Affected by Construction and Vehicle Traffic	AC	1.1	Dollars and _____ Cents	\$ _____	\$ _____
34	162	Sodding	SY	404	Dollars and _____ Cents	\$ _____	\$ _____
35	506	Stabilized Construction Entry/Exit	EA	2	Dollars and _____ Cents	\$ _____	\$ _____
36	506	Rock Filter Dams, Type II	EA	4	Dollars and _____ Cents	\$ _____	\$ _____
37	506	Reinforced Filter Fabric Fence	LF	170	Dollars and _____ Cents	\$ _____	\$ _____
Storm Water Pollution Prevention Plan Subtotal							\$ _____

SUPPLEMENTAL ITEMS (14TH STREET)⁽¹⁾

ITEM NUMBER	SPEC. NUMBER	DESCRIPTION	UNIT	QTY	UNIT PRICE IN WORDS	UNIT COST	TOTAL COST
38	COG 02627	Remove and Relocate Water Meters	EA	2	Dollars and _____ Cents	\$ _____	\$ _____
39	COG 02627	Adjust Water Meters to Established Grade	EA	14	Dollars and _____ Cents	\$ _____	\$ _____

**BID FORM
SAN LEON STREETS
RECONSTRUCTION
GALVESTON COUNTY**

ITEM NUMBER	SPEC. NUMBER	DESCRIPTION	UNIT	QTY	UNIT PRICE IN WORDS	UNIT COST	TOTAL COST
40	479	Adjust Manhole Rims to Established Grade	EA	1	Dollars and _____ Cents	\$ _____	\$ _____
41	480	Remove and Replace Sanitary Service Connections	EA	14	Dollars and _____ Cents	\$ _____	\$ _____
42	400	Extra Cement Stabilized Sand	CY	50	Dollars and _____ Cents	\$ _____	\$ _____
43	132	Extra Select Fill	CY	500	Dollars and _____ Cents	\$ _____	\$ _____
Supplemental Items Subtotal							\$ _____

Total Bid Amount (14th Street) \$ _____

**BID FORM
SAN LEON STREETS
RECONSTRUCTION
GALVESTON COUNTY**

BID SUMMARY FOR 14TH STREET

SITE PREPARATION AND EARTHWORK SUBTOTAL	\$ _____
STORM SEWER AND DRAINAGE SUBTOTAL	\$ _____
PAVING SUBTOTAL	\$ _____
SIGNING AND PAVEMENT MARKINGS SUBTOTAL	\$ _____
TRAFFIC CONTROL SUBTOTAL	\$ _____
STORM WATER POLLUTION PREVENTION PLAN SUBTOTAL	\$ _____
SUPPLEMENTAL SUBTOTAL	\$ _____
TOTAL BID AMOUNT FOR 14TH STREET	\$ _____

Footnotes:

(1) Contractor must obtain written approval from Galveston County Project Manager before work is performed for these items

**BID FORM
SAN LEON STREETS
RECONSTRUCTION
GALVESTON COUNTY**

SITE PERPARATION AND EARTHWORK (15TH STREET)

ITEM NUMBER	SPEC. NUMBER	DESCRIPTION	UNIT	QTY	UNIT PRICE IN WORDS	UNIT COST	TOTAL COST
1	500	Mobilization	LS	1	Dollars and _____ Cents	\$ _____	\$ _____
2	100	Preparation of Right of Way	AC	5.6	Dollars and _____ Cents	\$ _____	\$ _____
3	110	Excavation (Roadway and Roadside Ditches)	CY	4,250	Dollars and _____ Cents	\$ _____	\$ _____
4	105	Remove and Dispose of Existing Asphalt Pavement and Base (all depths)	SY	1,385	Dollars and _____ Cents	\$ _____	\$ _____
5	105	Remove and Dispose of Existing Gravel Roadway (all depths)	SY	3,432	Dollars and _____ Cents	\$ _____	\$ _____
6	104, 105, 400	Remove and Dispose of Ex. Driveway (all materials, all depths)	SY	783	Dollars and _____ Cents	\$ _____	\$ _____
7	496	Remove and Dispose of Ex. Inlets (all types, all depths)	EA	1	Dollars and _____ Cents	\$ _____	\$ _____
8	496	Remove and Dispose of Ex. 6" Culvert (all materials)	LF	5	Dollars and _____ Cents	\$ _____	\$ _____
9	496	Remove and Dispose of Ex. 8" Culvert (all materials)	LF	22	Dollars and _____ Cents	\$ _____	\$ _____
10	496	Remove and Dispose of Ex. 12" Culvert (all materials)	LF	113	Dollars and _____ Cents	\$ _____	\$ _____
11	496	Remove and Dispose of Ex. 15" Culvert (all materials)	LF	298	Dollars and _____ Cents	\$ _____	\$ _____
12	496	Remove and Dispose of Ex. 18" Culvert (all materials)	LF	276	Dollars and _____ Cents	\$ _____	\$ _____
13	496	Remove and Dispose of Ex. 20" Culvert (all materials)	LF	127	Dollars and _____ Cents	\$ _____	\$ _____
14	496	Remove and Dispose of Ex. 24" Culvert (all materials)	LF	125	Dollars and _____ Cents	\$ _____	\$ _____

**BID FORM
SAN LEON STREETS
RECONSTRUCTION
GALVESTON COUNTY**

ITEM NUMBER	SPEC. NUMBER	DESCRIPTION	UNIT	QTY	UNIT PRICE IN WORDS	UNIT COST	TOTAL COST
15	496	Remove and Dispose of Ex. 36" Culverts (all materials)	LF	22	Dollars and _____ Cents	\$ _____	\$ _____
16	496	Remove and Dispose of Ex. 42" Culverts (all materials)	LF	42	Dollars and _____ Cents	\$ _____	\$ _____
17	636	Remove Existing Traffic Signs	EA	3	Dollars and _____ Cents	\$ _____	\$ _____
Site Preparation and Earthwork Subtotal							
						\$ _____	\$ _____

STORM SEWER AND DRAINAGE ITEMS (15TH STREET)

ITEM NUMBER	SPEC. NUMBER	DESCRIPTION	UNIT	QTY	UNIT PRICE IN WORDS	UNIT COST	TOTAL COST
18	464	18" RCP Culvert	LF	941	Dollars and _____ Cents	\$ _____	\$ _____
19	464	24" RCP Culvert	LF	262	Dollars and _____ Cents	\$ _____	\$ _____
20	464	36" RCP Culvert	LF	90	Dollars and _____ Cents	\$ _____	\$ _____
21	COG 02619	30" HDPE Storm Sewer	LF	210	Dollars and _____ Cents	\$ _____	\$ _____
22	462	5' x 3' RCB (including bedding & backfill)	LF	72	Dollars and _____ Cents	\$ _____	\$ _____
23	466	Structural Concrete, Headwalls	CY	46	Dollars and _____ Cents	\$ _____	\$ _____
24	Per Project Manual/DWG	Diversion Pumping	LS	1	Dollars and _____ Cents	\$ _____	\$ _____
Storm Sewer Subtotal						\$ _____	\$ _____

**BID FORM
SAN LEON STREETS
RECONSTRUCTION
GALVESTON COUNTY**

PAVING ITEMS (15TH STREET)

ITEM NUMBER	SPEC. NUMBER	DESCRIPTION	UNIT	QTY	UNIT PRICE IN WORDS	UNIT COST	TOTAL COST
25	260	Lime Stabilized Subgrade Manipulation (6" depth)	SY	12,119	Dollars and _____ Cents	\$ _____	\$ _____
26	260	Hydrated Lime for Stabilization (7%)	TON	209	Dollars and _____ Cents	\$ _____	\$ _____
27	247	7" Flexible Base, Type A or D, Grade 1 or 2	SY	12,119	Dollars and _____ Cents	\$ _____	\$ _____
28	341	HMAC Type "D" Surface Course, 2" Thick	SY	10,320	Dollars and _____ Cents	\$ _____	\$ _____
29	310	Prime Coat (0.30 GAL/SY) for Roadway	GAL	3,096	Dollars and _____ Cents	\$ _____	\$ _____
30	530	Replace Ex. Driveways with Gravel to ROW (includes subgrade and base preparation)	SY	967	Dollars and _____ Cents	\$ _____	\$ _____
31	530	Replace Ex. Driveways with Asphalt to ROW (includes subgrade and base preparation)	SY	94	Dollars and _____ Cents	\$ _____	\$ _____
32	530	Replace Ex. Driveways with Concrete to ROW (includes subgrade and base preparation)	SY	53	Dollars and _____ Cents	\$ _____	\$ _____
Paving Subtotal							\$ _____

SIGNING AND PAVEMENT MARKINGS ITEMS (15TH STREET)

ITEM NUMBER	SPEC. NUMBER	DESCRIPTION	UNIT	QTY	UNIT PRICE IN WORDS	UNIT COST	TOTAL COST
33	666	REFL MRK TY II (W) 24" (SLD)	LF	48	Dollars and _____ Cents	\$ _____	\$ _____
34	666	REFL MRK TY II (Y) 4" (SLD)	LF	7,882	Dollars and _____ Cents	\$ _____	\$ _____

**BID FORM
SAN LEON STREETS
RECONSTRUCTION
GALVESTON COUNTY**

ITEM NUMBER	SPEC. NUMBER	DESCRIPTION	UNIT	QTY	UNIT PRICE IN WORDS	UNIT COST	TOTAL COST
35	636	SMALL SIGNS	EA	4	Dollars and _____ Cents	\$ _____	\$ _____
Signing and Pavement Markings Subtotal							
						\$ _____	\$ _____

TRAFFIC CONTROL ITEMS (15TH STREET)							
ITEM NUMBER	SPEC. NUMBER	DESCRIPTION	UNIT	QTY	UNIT PRICE IN WORDS	UNIT COST	TOTAL COST
36	247	Temporary Pavement, for Gravel Roads	SY	491	Dollars and _____ Cents	\$ _____	\$ _____
37	341	Temporary Pavement, for Asphalt Roads	SY	661	Dollars and _____ Cents	\$ _____	\$ _____
38	247	Temporary Driveways	EA	35	Dollars and _____ Cents	\$ _____	\$ _____
39	502	Barricades, Signs, and Traffic Handling (includes the installation, maintenance, and removal of all traffic control devices)	LS	1	Dollars and _____ Cents	\$ _____	\$ _____
40	502	Portable Message Signs	EA	2	Dollars and _____ Cents	\$ _____	\$ _____
Traffic Control Subtotal						\$ _____	\$ _____

STORM WATER POLLUTION PREVENTION PLAN ITEMS (15TH STREET)							
ITEM NUMBER	SPEC. NUMBER	DESCRIPTION	UNIT	QTY	UNIT PRICE IN WORDS	UNIT COST	TOTAL COST
41	164	Turf Establishment by Hydromulch Seeding of All Areas Affected by Construction and Vehicle Traffic	AC	3.0	Dollars and _____ Cents	\$ _____	\$ _____
42	162	Sodding	SY	1,367	Dollars and _____ Cents	\$ _____	\$ _____

**BID FORM
SAN LEON STREETS
RECONSTRUCTION
GALVESTON COUNTY**

ITEM NUMBER	SPEC. NUMBER	DESCRIPTION	UNIT	QTY	UNIT PRICE IN WORDS	UNIT COST	TOTAL COST
43	506	Stabilized Construction Entry/Exit	EA	2	Dollars and _____ Cents	\$ _____	\$ _____
44	506	Rock Filter Dams, Type II	EA	12	Dollars and _____ Cents	\$ _____	\$ _____
45	506	Reinforced Filter Fabric Fence	LF	665	Dollars and _____ Cents	\$ _____	\$ _____
Storm Water Pollution Prevention Plan Subtotal							\$ _____

SUPPLEMENTAL ITEMS (15TH STREET)⁽¹⁾							
ITEM NUMBER	SPEC. NUMBER	DESCRIPTION	UNIT	QTY	UNIT PRICE IN WORDS	UNIT COST	TOTAL COST
46	COG 02627	Remove and Relocate Water Meters	EA	7	Dollars and _____ Cents	\$ _____	\$ _____
47	COG 02645	Remove and Relocate Fire Hydrant	EA	1	Dollars and _____ Cents	\$ _____	\$ _____
48	COG 02627	Adjust Water Meters to Established Grade	EA	28	Dollars and _____ Cents	\$ _____	\$ _____
49	479	Adjust Manhole Rims to Established Grade	EA	2	Dollars and _____ Cents	\$ _____	\$ _____
50	COG 02762	Remove and Replace Sanitary Service Connections	EA	35	Dollars and _____ Cents	\$ _____	\$ _____
51	400	Extra Cement Stabilized Sand	CY	50	Dollars and _____ Cents	\$ _____	\$ _____
52	132	Extra Select Fill	CY	500	Dollars and _____ Cents	\$ _____	\$ _____
Supplemental Items Subtotal							\$ _____

Total Bid Amount (15th Street) \$ _____

Page 64 of 105

BID FORM
SAN LEON STREETS
RECONSTRUCTION
GALVESTON COUNTY

BID SUMMARY FOR 15TH STREET

SITE PREPARATION AND EARTHWORK SUBTOTAL	\$
STORM SEWER AND DRAINAGE SUBTOTAL	\$
PAVING SUBTOTAL	\$
SIGNING AND PAVEMENT MARKINGS SUBTOTAL	\$
TRAFFIC CONTROL SUBTOTAL	\$
STORM WATER POLLUTION PREVENTION PLAN SUBTOTAL	\$
SUPPLEMENTAL SUBTOTAL	\$
TOTAL BID AMOUNT FOR 15TH STREET	\$

Footnotes:

⁽¹⁾ Contractor must obtain written approval from Galveston County Project Manager before work is performed for these items

**BID FORM
SAN LEON STREETS
RECONSTRUCTION
GALVESTON COUNTY**

SITE PERPARATION AND EARTHWORK (16TH STREET)		DESCRIPTION		UNIT	QTY	UNIT PRICE IN WORDS	UNIT COST	TOTAL COST
ITEM NUMBER	SPEC. NUMBER							
1	550	Mobilization		LS	1	Dollars and _____ Cents	\$ _____	\$ _____
2	100	Preparation of Right of Way		AC	7	Dollars and _____ Cents	\$ _____	\$ _____
3	110	Excavation (Roadway and Roadside Ditches)		CY	4,100	Dollars and _____ Cents	\$ _____	\$ _____
4	105	Remove and Dispose of Existing Asphalt Pavement and Base (all depths)		SY	2,565	Dollars and _____ Cents	\$ _____	\$ _____
5	105	Remove and Dispose of Existing Gravel Roadway (all depths)		SY	1,137	Dollars and _____ Cents	\$ _____	\$ _____
6	104, 105, 400	Remove and Dispose of Ex. Driveway (all materials, all depths)		SY	1,651	Dollars and _____ Cents	\$ _____	\$ _____
7	496	Remove and Dispose of Ex. Inlets (all types, all depths)		EA	2	Dollars and _____ Cents	\$ _____	\$ _____
8	496	Remove and Dispose of Ex. 12" Culvert (all materials)		LF	92	Dollars and _____ Cents	\$ _____	\$ _____
9	496	Remove and Dispose of Ex. 15" Culvert (all materials)		LF	531	Dollars and _____ Cents	\$ _____	\$ _____
10	496	Remove and Dispose of Ex. 18" Culvert (all materials)		LF	425	Dollars and _____ Cents	\$ _____	\$ _____
11	496	Remove and Dispose of Ex. 24" Culvert (all materials)		LF	118	Dollars and _____ Cents	\$ _____	\$ _____
12	636	Remove Existing Traffic Signs		EA	2	Dollars and _____ Cents	\$ _____	\$ _____
Site Preparation and Earthwork Subtotal								\$ _____

BID FORM
SAN LEON STREETS
RECONSTRUCTION
GALVESTON COUNTY

STORM SEWER AND DRAINAGE ITEMS (16TH STREET)

ITEM NUMBER	SPEC. NUMBER	DESCRIPTION	UNIT	QTY	UNIT PRICE IN WORDS	UNIT COST	TOTAL COST
13	464	18" RCP Culvert	LF	1,184	Dollars and _____ Cents	\$ _____	\$ _____
14	464	24" RCP Culvert	LF	166	Dollars and _____ Cents	\$ _____	\$ _____
15	464	36" RCP Culvert	LF	74	Dollars and _____ Cents	\$ _____	\$ _____
16	COG 02619	30" HDPE Storm Sewer	LF	110	Dollars and _____ Cents	\$ _____	\$ _____
17	462	5' x 3' RCB (including bedding & backfill)	LF	66	Dollars and _____ Cents	\$ _____	\$ _____
18	465	Type "D" Inlet (all depths)	EA	2	Dollars and _____ Cents	\$ _____	\$ _____
19	760	Regrade Ex. Roadside Ditches	LF	194	Dollars and _____ Cents	\$ _____	\$ _____
20	760	Regrade Ex. Drainage Channel	LF	145	Dollars and _____ Cents	\$ _____	\$ _____
21	466	Structural Concrete, Headwalls	CY	46	Dollars and _____ Cents	\$ _____	\$ _____
22	Per Project Manual/D WG	Diversion Pumping	LS	1	Dollars and _____ Cents	\$ _____	\$ _____
Storm Sewer Subtotal							\$ _____

**BID FORM
SAN LEON STREETS
RECONSTRUCTION
GALVESTON COUNTY**

PAVING ITEMS (16TH STREET)

ITEM NUMBER	SPEC. NUMBER	DESCRIPTION	UNIT	QTY	UNIT PRICE IN WORDS	UNIT COST	TOTAL COST
23	260	Lime Stabilized Subgrade Manipulation (6" depth)	SY	13,611	Dollars and _____ Cents	\$ _____	\$ _____
24	260	Hydrated Lime for Stabilization (7%)	TON	236	Dollars and _____ Cents	\$ _____	\$ _____
25	247	7" Flexible Base, Type A or D, Grade 1 or 2	SY	13,611	Dollars and _____ Cents	\$ _____	\$ _____
26	341	HMAC Type "D" Surface Course, 2" Thick	SY	11,973	Dollars and _____ Cents	\$ _____	\$ _____
27	310	Prime Coat (0.30 GAL/SY) for Roadway	GAL	3,592	Dollars and _____ Cents	\$ _____	\$ _____
28	530	Replace Ex. Driveways with Gravel to ROW (includes subgrade and base preparation)	SY	1,276	Dollars and _____ Cents	\$ _____	\$ _____
29	530	Replace Ex. Driveways with Concrete to ROW (includes subgrade and base preparation)	SY	90	Dollars and _____ Cents	\$ _____	\$ _____
Paving Subtotal							\$ _____

**BID FORM
SAN LEON STREETS
RECONSTRUCTION
GALVESTON COUNTY**

SIGNING AND PAVEMENT MARKINGS ITEMS (16TH STREET)

ITEM NUMBER	SPEC. NUMBER	DESCRIPTION	UNIT	QTY	UNIT PRICE IN WORDS	UNIT COST	TOTAL COST
30	666	REFL MRK TY II (W) 24" (SLD)	LF	63	Dollars and _____ Cents	\$ _____	\$ _____
31	666	REFL MRK TY II (Y) 4" (SLD)	LF	8,920	Dollars and _____ Cents	\$ _____	\$ _____
32	636	SMALL SIGNS	EA	5	Dollars and _____ Cents	\$ _____	\$ _____
Signing and Pavement Markings Subtotal							\$ _____

TRAFFIC CONTROL ITEMS (16TH STREET)

ITEM NUMBER	SPEC. NUMBER	DESCRIPTION	UNIT	QTY	UNIT PRICE IN WORDS	UNIT COST	TOTAL COST
33	341	Temporary Pavement, for Asphalt Roads	SY	853	Dollars and _____ Cents	\$ _____	\$ _____
34	247	Temporary Driveways	EA	38	Dollars and _____ Cents	\$ _____	\$ _____
35	502	Barricades, Signs, and Traffic Handling (includes the installation, maintenance, and removal of all traffic control devices)	LS	1	Dollars and _____ Cents	\$ _____	\$ _____
36	502	Portable Message Signs	EA	2	Dollars and _____ Cents	\$ _____	\$ _____
Traffic Control Subtotal							\$ _____

STORM WATER POLLUTION PREVENTION PLAN ITEMS (16TH STREET)

ITEM NUMBER	SPEC. NUMBER	DESCRIPTION	UNIT	QTY	UNIT PRICE IN WORDS	UNIT COST	TOTAL COST
37	164	Turf Establishment by Hydromulch Seeding of All Areas Affected by Construction and Vehicle Traffic	AC	4	Dollars and _____ Cents	\$ _____	\$ _____
38	162	Sodding	SY	1,534	Dollars and _____ Cents	\$ _____	\$ _____

**BID FORM
SAN LEON STREETS
RECONSTRUCTION
GALVESTON COUNTY**

ITEM NUMBER	SPEC. NUMBER	DESCRIPTION	UNIT	QTY	UNIT PRICE IN WORDS	UNIT COST	TOTAL COST
39	506	Stabilized Construction Entry/Exit	EA	2	Dollars and _____ Cents	\$ _____	\$ _____
40	506	Rock Filter Dams, Type II	EA	12	Dollars and _____ Cents	\$ _____	\$ _____
41	506	Reinforced Filter Fabric Fence	LF	750	Dollars and _____ Cents	\$ _____	\$ _____
Storm Water Pollution Preventionaon Plan Subtotal							

SUPPLEMENTAL ITEMS (16TH STREET)⁽¹⁾							
ITEM NUMBER	SPEC. NUMBER	DESCRIPTION	UNIT	QTY	UNIT PRICE IN WORDS	UNIT COST	TOTAL COST
42	COG 02627	Remove and Relocate Water Meters	EA	6	Dollars and _____ Cents	\$ _____	\$ _____
43	COG 02627	Adjust Water Meters to Established Grade	EA	32	Dollars and _____ Cents	\$ _____	\$ _____
44	479	Adjust Manhole Rims to Established Grade	EA	1	Dollars and _____ Cents	\$ _____	\$ _____
45	COG 02762	Remove and Replace Sanitary Service Connections	EA	38	Dollars and _____ Cents	\$ _____	\$ _____
46	400	Extra Cement Stabilized Sand	CY	50	Dollars and _____ Cents	\$ _____	\$ _____
47	132	Extra Select Fill	CY	500	Dollars and _____ Cents	\$ _____	\$ _____
Supplemental Items Subtotal							

Total Bid Amount (16th Street) \$ _____

**BID FORM
SAN LEON STREETS
RECONSTRUCTION
GALVESTON COUNTY**

BID SUMMARY FOR 16TH STREET

SITE PREPARATION AND EARTHWORK SUBTOTAL	\$ _____
STORM SEWER AND DRAINAGE SUBTOTAL	\$ _____
PAVING SUBTOTAL	\$ _____
SIGNING AND PAVEMENT MARKINGS SUBTOTAL	\$ _____
TRAFFIC CONTROL SUBTOTAL	\$ _____
STORM WATER POLLUTION PREVENTION PLAN SUBTOTAL	\$ _____
SUPPLEMENTAL SUBTOTAL	\$ _____
TOTAL BID AMOUNT FOR 16TH STREET	\$ _____

Footnotes:

⁽¹⁾ Contractor must obtain written approval from Galveston County Project Manager before work is performed for these items

**BID FORM
SAN LEON STREETS
RECONSTRUCTION
GALVESTON COUNTY**

SITE PERPARATION AND EARTHWORK (AVENUE D)

ITEM NUMBER	SPEC. NUMBER	UNIT	QTY	UNIT PRICE IN WORDS	UNIT COST	TOTAL COST
1	500	LS	1	Dollars and _____ Cents	\$ _____	\$ _____
2	100	AC	5.1	Dollars and _____ Cents	\$ _____	\$ _____
3	110	CY	2,100	Dollars and _____ Cents	\$ _____	\$ _____
4	132	CY	1,600	Dollars and _____ Cents	\$ _____	\$ _____
5	105	SY	1,292	Dollars and _____ Cents	\$ _____	\$ _____
6	105	SY	925	Dollars and _____ Cents	\$ _____	\$ _____
7	104, 105, 400	SY	446	Dollars and _____ Cents	\$ _____	\$ _____
8	496	LF	31	Dollars and _____ Cents	\$ _____	\$ _____
9	496	LF	232	Dollars and _____ Cents	\$ _____	\$ _____
10	496	LF	65	Dollars and _____ Cents	\$ _____	\$ _____
11	496	LF	118	Dollars and _____ Cents	\$ _____	\$ _____
12	496	EA	1	Dollars and _____ Cents	\$ _____	\$ _____
13	636	EA	4	Dollars and _____ Cents	\$ _____	\$ _____
Site Preparation and Earthwork Subtotal						\$ _____

**BID FORM
SAN LEON STREETS
RECONSTRUCTION
GALVESTON COUNTY**

STORM SEWER AND DRAINAGE ITEMS (AVENUE D)

ITEM NUMBER	SPEC. NUMBER	DESCRIPTION	UNIT	QTY	UNIT PRICE IN WORDS	UNIT COST	TOTAL COST
14	464	18" RCP Culvert	LF	363	Dollars and _____ Cents	\$ _____	\$ _____
15	464	24" RCP Culvert	LF	316	Dollars and _____ Cents	\$ _____	\$ _____
16	464	54" RCP Culvert	LF	5	Dollars and _____ Cents	\$ _____	\$ _____
17	462	5' x 5' RCB (including bedding and backfill)	LF	178	Dollars and _____ Cents	\$ _____	\$ _____
18	462, 465	Junction Box at Ave D and 20th Street	LS	1	Dollars and _____ Cents	\$ _____	\$ _____
19	760	Regrade Ex. Roadside Ditches	LF	292	Dollars and _____ Cents	\$ _____	\$ _____
20	466	Structural Concrete, Headwalls	CY	23	Dollars and _____ Cents	\$ _____	\$ _____
21	466	Structural Concrete, Wingwalls	CY	28	Dollars and _____ Cents	\$ _____	\$ _____
22	432	Riprap (Apron for Wingwalls)	SY	47	Dollars and _____ Cents	\$ _____	\$ _____
23	Per Project Manual/DWG	Diversion Pumping	LS	1	Dollars and _____ Cents	\$ _____	\$ _____
Storm Sewer Subtotal							\$ _____

PAVING ITEMS (AVENUE D)

ITEM NUMBER	SPEC. NUMBER	DESCRIPTION	UNIT	QTY	UNIT PRICE IN WORDS	UNIT COST	TOTAL COST
24	260	Lime Stabilized Subgrade Manipulation (6" depth)	SY	11,375	Dollars and _____ Cents	\$ _____	\$ _____

**BID FORM
SAN LEON STREETS
RECONSTRUCTION
GALVESTON COUNTY**

ITEM NUMBER	SPEC. NUMBER	DESCRIPTION	UNIT	QTY	UNIT PRICE IN WORDS	UNIT COST	TOTAL COST
25	260	Hydrated Lime for Stabilization (7%)	TON	198	Dollars and _____ Cents	\$ _____	\$ _____
26	247	7" Flexible Base, Type A or D, Grade 1 or 2	SY	11,375	Dollars and _____ Cents	\$ _____	\$ _____
27	341	HMAC Type "D" Surface Course, 2" Thick	SY	9,548	Dollars and _____ Cents	\$ _____	\$ _____
28	310	Prime Coat (0.30 GAL/SY) for Roadway	GAL	2,865	Dollars and _____ Cents	\$ _____	\$ _____
29	530	Replace Ex. Driveways with Gravel to ROW (includes subgrade and base preparation)	SY	156	Dollars and _____ Cents	\$ _____	\$ _____
30	530	Replace Ex. Driveways with Asphalt to ROW (includes subgrade and base preparation)	SY	96	Dollars and _____ Cents	\$ _____	\$ _____
31	530	Replace Ex. Driveways with Concrete to ROW (includes subgrade and base preparation)	SY	118	Dollars and _____ Cents	\$ _____	\$ _____
32	540	Metal Beam Guard Fence	LF	63	Dollars and _____ Cents	\$ _____	\$ _____
33	544	Single Guardrail End Treatment	EA	1	Dollars and _____ Cents	\$ _____	\$ _____
34	544	Downstream Anchor Terminal Section	EA	1	Dollars and _____ Cents	\$ _____	\$ _____
Paving Subtotal							\$ _____

**BID FORM
SAN LEON STREETS
RECONSTRUCTION
GALVESTON COUNTY**

SIGNING AND PAVEMENT MARKINGS ITEMS (AVENUE D)

ITEM NUMBER	SPEC. NUMBER	DESCRIPTION	UNIT	QTY	UNIT PRICE IN WORDS	UNIT COST	TOTAL COST
35	666	REFL MRK TY II (W) 24" (SLD)	LF	148	Dollars and _____ Cents	\$ _____	\$ _____
36	666	REFL MRK TY II (Y) 4" (SLD)	LF	6,432	Dollars and _____ Cents	\$ _____	\$ _____
37	636	SMALL SIGNS	EA	16	Dollars and _____ Cents	\$ _____	\$ _____
Signing and Pavement Markings Subtotal							\$ _____

TRAFFIC CONTROL ITEMS (AVENUE D)

ITEM NUMBER	SPEC. NUMBER	DESCRIPTION	UNIT	QTY	UNIT PRICE IN WORDS	UNIT COST	TOTAL COST
38	247	Temporary Pavement, for Gravel Roads	SY	48	Dollars and _____ Cents	\$ _____	\$ _____
39	341	Temporary Pavement, for Asphalt Roads	SY	78	Dollars and _____ Cents	\$ _____	\$ _____
40	247	Temporary Driveways	EA	12	Dollars and _____ Cents	\$ _____	\$ _____
41	502	Barricades, Signs, and Traffic Handling (includes the installation, maintenance, and removal of all traffic control devices)	LS	1	Dollars and _____ Cents	\$ _____	\$ _____
42	502	Portable Message Signs	EA	2	Dollars and _____ Cents	\$ _____	\$ _____
Traffic Control Subtotal							\$ _____

**BID FORM
SAN LEON STREETS
RECONSTRUCTION
GALVESTON COUNTY**

STORM WATER POLLUTION PREVENTION PLAN ITEMS (AVENUE D)

ITEM NUMBER	SPEC. NUMBER	DESCRIPTION	UNIT	QTY	UNIT PRICE IN WORDS	UNIT COST	TOTAL COST																																																								
43	164	Turf Establishment by Hydromulch Seeding of All Areas Affected by Construction and Vehicle Traffic	AC	3	Dollars and _____ Cents	\$ _____	\$ _____																																																								
44	162	Sodding	SY	934	Dollars and _____ Cents	\$ _____	\$ _____																																																								
45	506	Stabilized Construction Entry/Exit	EA	3	Dollars and _____ Cents	\$ _____	\$ _____																																																								
46	506	Rock Filter Dams, Type II	EA	2	Dollars and _____ Cents	\$ _____	\$ _____																																																								
47	506	Reinforced Filter Fabric Fence	LF	2,040	Dollars and _____ Cents	\$ _____	\$ _____																																																								
Storm Water Pollution Prevention Plan Subtotal																																																															
<table border="1" style="width:100%; border-collapse: collapse;"> <thead> <tr> <th>ITEM NUMBER</th> <th>SPEC. NUMBER</th> <th>DESCRIPTION</th> <th>UNIT</th> <th>QTY</th> <th>UNIT PRICE IN WORDS</th> <th>UNIT COST</th> <th>TOTAL COST</th> </tr> </thead> <tbody> <tr> <td>48</td> <td>COG 02627</td> <td>Adjust Water Meters to Established Grade</td> <td>EA</td> <td>12</td> <td>Dollars and _____ Cents</td> <td>\$ _____</td> <td>\$ _____</td> </tr> <tr> <td>49</td> <td>479</td> <td>Adjust Manhole Rims to Established Grade</td> <td>EA</td> <td>1</td> <td>Dollars and _____ Cents</td> <td>\$ _____</td> <td>\$ _____</td> </tr> <tr> <td>50</td> <td>COG 02762</td> <td>Remove and Replace Sanitary Service Connections</td> <td>EA</td> <td>12</td> <td>Dollars and _____ Cents</td> <td>\$ _____</td> <td>\$ _____</td> </tr> <tr> <td>51</td> <td>400</td> <td>Extra Cement Stabilized Sand</td> <td>CY</td> <td>50</td> <td>Dollars and _____ Cents</td> <td>\$ _____</td> <td>\$ _____</td> </tr> <tr> <td>52</td> <td>132</td> <td>Extra Select Fill</td> <td>CY</td> <td>500</td> <td>Dollars and _____ Cents</td> <td>\$ _____</td> <td>\$ _____</td> </tr> <tr> <td colspan="8">Supplemental Items Subtotal</td> </tr> </tbody> </table>								ITEM NUMBER	SPEC. NUMBER	DESCRIPTION	UNIT	QTY	UNIT PRICE IN WORDS	UNIT COST	TOTAL COST	48	COG 02627	Adjust Water Meters to Established Grade	EA	12	Dollars and _____ Cents	\$ _____	\$ _____	49	479	Adjust Manhole Rims to Established Grade	EA	1	Dollars and _____ Cents	\$ _____	\$ _____	50	COG 02762	Remove and Replace Sanitary Service Connections	EA	12	Dollars and _____ Cents	\$ _____	\$ _____	51	400	Extra Cement Stabilized Sand	CY	50	Dollars and _____ Cents	\$ _____	\$ _____	52	132	Extra Select Fill	CY	500	Dollars and _____ Cents	\$ _____	\$ _____	Supplemental Items Subtotal							
ITEM NUMBER	SPEC. NUMBER	DESCRIPTION	UNIT	QTY	UNIT PRICE IN WORDS	UNIT COST	TOTAL COST																																																								
48	COG 02627	Adjust Water Meters to Established Grade	EA	12	Dollars and _____ Cents	\$ _____	\$ _____																																																								
49	479	Adjust Manhole Rims to Established Grade	EA	1	Dollars and _____ Cents	\$ _____	\$ _____																																																								
50	COG 02762	Remove and Replace Sanitary Service Connections	EA	12	Dollars and _____ Cents	\$ _____	\$ _____																																																								
51	400	Extra Cement Stabilized Sand	CY	50	Dollars and _____ Cents	\$ _____	\$ _____																																																								
52	132	Extra Select Fill	CY	500	Dollars and _____ Cents	\$ _____	\$ _____																																																								
Supplemental Items Subtotal																																																															
Total Bid Amount (Avenue D)																																																															
\$ _____																																																															

**BID FORM
SAN LEON STREETS
RECONSTRUCTION
GALVESTON COUNTY**

BID SUMMARY FOR AVENUE D

SITE PREPARATION AND EARTHWORK SUBTOTAL	\$ _____
STORM SEWER AND DRAINAGE SUBTOTAL	\$ _____
PAVING SUBTOTAL	\$ _____
SIGNING AND PAVEMENT MARKINGS SUBTOTAL	\$ _____
TRAFFIC CONTROL SUBTOTAL	\$ _____
STORM WATER POLLUTION PREVENTION PLAN SUBTOTAL	\$ _____
SUPPLEMENTAL SUBTOTAL	\$ _____
TOTAL BID AMOUNT FOR AVENUE D	\$ _____

Footnotes: (1) Contractor must obtain written approval from Galveston County Project Manager before work is performed for these items

BID FORM
SAN LEON STREETS
RECONSTRUCTION
GALVESTON COUNTY

BID SUMMARY FOR SAN LEON RECONSTRUCTION

14th Street Bid Amount	\$
15th Street Bid Amount	\$
16th Street Bid Amount	\$
Avenue D Bid Amount	\$
Total Bid Amount (14th Street, 15th Street, 16th Street, and Avenue D) for San Leon Street Reconstruction Project	\$

CERTIFICATION REGARDING LOBBYING

(31 U.S.C.A. § 1352)

**This Certification must be completed, signed, dated and
returned to the Galveston County Purchasing Agent**

Procurement Number and Description: _____

BID #B171018 SAN LEON ROADS RECONSTRUCTION

Proposer **CERTIFIES**, to the best of its knowledge and belief, that:

1. No Federal appropriated funds have been paid or will be paid, by or on behalf of the proposer, to any person for influencing or attempting to influence an officer or employee of an agency, a Member of Congress, an officer or employee of Congress, or an employee of a Member of Congress in connection with the awarding of any Federal contract, the making of any Federal grant, the making of any Federal loan, the entering into of any cooperative agreement, and the extension, continuation, renewal, amendment, or modification of any Federal contract, grant, loan, or cooperative agreement.
2. If any funds other than Federal appropriated funds have been paid or will be paid to any person for influencing or attempting to influence an officer or employee of any agency, a Member of Congress, an officer or employee of Congress, or an employee of a Member of Congress in connection with this Federal contract, grant, loan, or cooperative agreement, the proposer shall complete and submit **Standard Form LLL**, "Disclosure Form to Report Lobbying", in accordance with its instructions.
3. Proposer shall require that the language of this certification be included in the award documents for all subawards at all tiers (including subcontracts, subgrants, and contracts under grants, loans, and cooperative agreements) and that all subrecipients shall certify and disclose accordingly.

This certification is a material representation of fact upon which reliance was placed when this transaction was made or entered into. Submission of this certification is a prerequisite for making or entering into this transaction imposed by Section 1352, Title 31, U.S. Code. Any person who fails to file the required certification shall be subject to a civil penalty of not less than \$10,000 and not more than \$100,000 for each such failure.

Name of Organization/Corporation: _____

Address: _____

City: _____ State: _____ Zip Code: _____

Signature of Authorized Signatory for Proposer: _____ Date Signed: _____

Title of Authorized Signatory of Proposer: _____

PAVING CONSTRUCTION NOTES

1. PAVING CONSTRUCTION NOTES
2. CONCRETE CURBWAYS AFFECTED BY CONSTRUCTION WILL BE REPLACED WITH 8" CONCRETE PAVEMENT TO R.O.W.
3. DRIVEWAYS AFFECTED BY CONSTRUCTION WILL BE REPLACED WITH 4" FLEXIBLE BASE, TYPE "A" OR "B", GRADE "1", 114' x 24'.
4. APPLICABLE DRIVWAYS AFFECTED BY CONSTRUCTION WILL BE REPAIRED UP TO THE DRIVEWAY FINISH GRADE TO MATCH THE DRIVEWAY SURFACE TO BE REPAIRED. THE DRIVEWAY SHALL BE REPAIRED TO THE DRIVEWAY SURFACE TO BE REPAIRED. NO SEPARATE PAY FOR ADDITIONAL CEMENT SHALL BE REQUIRED.
5. CONTRACTOR TO BRACK AND DISPOSE OF ALL EXISTING ROADWAY MATERIAL WITHIN PROJECT LIMITS.
6. FILE BASE COURSE FOR ROADWAY SHALL COMPLY WITH ITEM #47, ELEMENTAL BASE, TYPE "A" OR "B", GRADE "1" OR "2".
7. FILE CURB/STREET CURB SHALL COMPLY WITH ITEM #47, ELEMENTAL CURB, TYPE "A" OR "B", GRADE "1" OR "2".
8. FILE DRIVEWAY/STREET DRIVEWAY SHALL COMPLY WITH ITEM #47, ELEMENTAL DRIVEWAY, TYPE "A" OR "B", GRADE "1", 114' x 24'.
9. DRIVEWAY SURFACE SHALL COMPLY WITH ITEM #47, ELEMENTAL DRIVEWAY SURFACE, TYPE "A" OR "B", GRADE "1", 114' x 24'.

CONTRACTOR TO BE RESPONSIBLE FOR OBTAINING ALL NECESSARY PERMITS FROM ALL AFFECTED AGENCIES AND TO COMPLY WITH ALL APPLICABLE REGULATIONS AND ORDINANCES. CONTRACTOR TO BE RESPONSIBLE FOR OBTAINING ALL NECESSARY PERMITS FROM ALL AFFECTED AGENCIES AND TO COMPLY WITH ALL APPLICABLE REGULATIONS AND ORDINANCES. CONTRACTOR TO BE RESPONSIBLE FOR OBTAINING ALL NECESSARY PERMITS FROM ALL AFFECTED AGENCIES AND TO COMPLY WITH ALL APPLICABLE REGULATIONS AND ORDINANCES.

1. EXISTING CURBWAYS AFFECTED BY CONSTRUCTION WILL BE REPLACED WITH 8" CONCRETE PAVEMENT TO R.O.W.
2. DRIVEWAYS AFFECTED BY CONSTRUCTION WILL BE REPLACED WITH 4" FLEXIBLE BASE, TYPE "A" OR "B", GRADE "1", 114' x 24'.
3. APPLICABLE DRIVWAYS AFFECTED BY CONSTRUCTION WILL BE REPAIRED UP TO THE DRIVEWAY FINISH GRADE TO MATCH THE DRIVEWAY SURFACE TO BE REPAIRED. THE DRIVEWAY SHALL BE REPAIRED TO THE DRIVEWAY SURFACE TO BE REPAIRED. NO SEPARATE PAY FOR ADDITIONAL CEMENT SHALL BE REQUIRED.
4. CONTRACTOR TO BRACK AND DISPOSE OF ALL EXISTING ROADWAY MATERIAL WITHIN PROJECT LIMITS.
5. FILE BASE COURSE FOR ROADWAY SHALL COMPLY WITH ITEM #47, ELEMENTAL BASE, TYPE "A" OR "B", GRADE "1" OR "2".
6. FILE CURB/STREET CURB SHALL COMPLY WITH ITEM #47, ELEMENTAL CURB, TYPE "A" OR "B", GRADE "1" OR "2".
7. FILE DRIVEWAY/STREET DRIVEWAY SHALL COMPLY WITH ITEM #47, ELEMENTAL DRIVEWAY, TYPE "A" OR "B", GRADE "1", 114' x 24'.
8. DRIVEWAY SURFACE SHALL COMPLY WITH ITEM #47, ELEMENTAL DRIVEWAY SURFACE, TYPE "A" OR "B", GRADE "1", 114' x 24'.

LOWESTAR NOTES

AT LEAST 48 HOURS BEFORE EXCAVATING IN STREET R.O.W. OF EASEMENTS CALL THE TOLL FREE NOTIFICATION 713-223-4367.

GENERAL CONSTRUCTION NOTES (CONT.)

1. THESE PLANS, PREPARED BY COSTELLO, INC., DO NOT EXTEND TO OR INCLUDE DESIGN OR SYSTEMS PERTAINING TO THE SAFETY OF THE ROADWAY. THE CONTRACTOR SHALL BE RESPONSIBLE FOR THE PERFORMANCE OF THE WORK. THE SEAL OF THE REGISTERED PROFESSIONAL ENGINEER'S DESIGN DOES NOT EXTEND TO ANY SUCH PLANS. THE CONTRACTOR SHALL PREPARE OR OBTAIN THE APPROPRIATE DESIGN PERMITS FROM THE CITY OF SAN ANTONIO, TEXAS, AND THE TEXAS DEPARTMENT OF TRANSPORTATION. THE CONTRACTOR SHALL BE RESPONSIBLE FOR OBTAINING ALL NECESSARY PERMITS FROM ALL AFFECTED AGENCIES AND TO COMPLY WITH ALL APPLICABLE REGULATIONS AND ORDINANCES.

CONSTRUCTION NOTES

SAN LEON ROADS RECONSTRUCTION
(14th, 15th, 16th, & AVE. D)
Engineering and Surveying
9890 Richmond Road, Suite 450 N
Houston, Texas 77042
(713) 785-7788 (713) 785-3580 Fax
TBPPE FIRM REG. No. 290
TBPPE FIRM REG. No. 100496



GENERAL CONSTRUCTION NOTES

1. PAVING, WATER LINES, WASTE/WATER COLLECTION SYSTEMS AND SANITATION SHALL BE INSTALLED IN ACCORDANCE WITH THE SAN ANTONIO CITY REGULATIONS UNLESS OTHERWISE NOTED ON THESE PLANS.

CONTRACTOR TO BE RESPONSIBLE FOR OBTAINING ALL NECESSARY PERMITS FROM ALL AFFECTED AGENCIES AND TO COMPLY WITH ALL APPLICABLE REGULATIONS AND ORDINANCES.

2. CONTRACTOR SHALL BE FULLY RESPONSIBLE FOR ANY AND ALL UNEXPECTED CONDITIONS ENCOUNTERED DURING CONSTRUCTION, INCLUDING BUT NOT LIMITED TO UNEXPECTED UTILITIES, WATER COLLECTION SYSTEMS AND STORM SEWERS DURING CONSTRUCTION. CONTRACTOR SHALL BE RESPONSIBLE FOR OBTAINING ALL NECESSARY PERMITS FROM ALL AFFECTED AGENCIES AND TO COMPLY WITH ALL APPLICABLE REGULATIONS AND ORDINANCES.

CONTRACTOR TO BE RESPONSIBLE FOR OBTAINING ALL NECESSARY PERMITS FROM ALL AFFECTED AGENCIES AND TO COMPLY WITH ALL APPLICABLE REGULATIONS AND ORDINANCES.

3. THE CONTRACTOR SHALL BE RESPONSIBLE FOR OBTAINING ALL NECESSARY PERMITS FROM ALL AFFECTED AGENCIES AND TO COMPLY WITH ALL APPLICABLE REGULATIONS AND ORDINANCES.

CONTRACTOR TO BE RESPONSIBLE FOR OBTAINING ALL NECESSARY PERMITS FROM ALL AFFECTED AGENCIES AND TO COMPLY WITH ALL APPLICABLE REGULATIONS AND ORDINANCES.

4. CONTRACTOR SHALL BE RESPONSIBLE FOR OBTAINING ALL NECESSARY PERMITS FROM ALL AFFECTED AGENCIES AND TO COMPLY WITH ALL APPLICABLE REGULATIONS AND ORDINANCES.

CONTRACTOR TO BE RESPONSIBLE FOR OBTAINING ALL NECESSARY PERMITS FROM ALL AFFECTED AGENCIES AND TO COMPLY WITH ALL APPLICABLE REGULATIONS AND ORDINANCES.

5. CONTRACTOR SHALL BE RESPONSIBLE FOR OBTAINING ALL NECESSARY PERMITS FROM ALL AFFECTED AGENCIES AND TO COMPLY WITH ALL APPLICABLE REGULATIONS AND ORDINANCES.

CONTRACTOR TO BE RESPONSIBLE FOR OBTAINING ALL NECESSARY PERMITS FROM ALL AFFECTED AGENCIES AND TO COMPLY WITH ALL APPLICABLE REGULATIONS AND ORDINANCES.

6. CONTRACTOR SHALL BE RESPONSIBLE FOR OBTAINING ALL NECESSARY PERMITS FROM ALL AFFECTED AGENCIES AND TO COMPLY WITH ALL APPLICABLE REGULATIONS AND ORDINANCES.

CONTRACTOR TO BE RESPONSIBLE FOR OBTAINING ALL NECESSARY PERMITS FROM ALL AFFECTED AGENCIES AND TO COMPLY WITH ALL APPLICABLE REGULATIONS AND ORDINANCES.

7. CONTRACTOR SHALL BE RESPONSIBLE FOR OBTAINING ALL NECESSARY PERMITS FROM ALL AFFECTED AGENCIES AND TO COMPLY WITH ALL APPLICABLE REGULATIONS AND ORDINANCES.

CONTRACTOR TO BE RESPONSIBLE FOR OBTAINING ALL NECESSARY PERMITS FROM ALL AFFECTED AGENCIES AND TO COMPLY WITH ALL APPLICABLE REGULATIONS AND ORDINANCES.

8. CONTRACTOR SHALL BE RESPONSIBLE FOR OBTAINING ALL NECESSARY PERMITS FROM ALL AFFECTED AGENCIES AND TO COMPLY WITH ALL APPLICABLE REGULATIONS AND ORDINANCES.

CONTRACTOR TO BE RESPONSIBLE FOR OBTAINING ALL NECESSARY PERMITS FROM ALL AFFECTED AGENCIES AND TO COMPLY WITH ALL APPLICABLE REGULATIONS AND ORDINANCES.

9. CONTRACTOR SHALL BE RESPONSIBLE FOR OBTAINING ALL NECESSARY PERMITS FROM ALL AFFECTED AGENCIES AND TO COMPLY WITH ALL APPLICABLE REGULATIONS AND ORDINANCES.

CONTRACTOR TO BE RESPONSIBLE FOR OBTAINING ALL NECESSARY PERMITS FROM ALL AFFECTED AGENCIES AND TO COMPLY WITH ALL APPLICABLE REGULATIONS AND ORDINANCES.

10. CONTRACTOR SHALL BE RESPONSIBLE FOR OBTAINING ALL NECESSARY PERMITS FROM ALL AFFECTED AGENCIES AND TO COMPLY WITH ALL APPLICABLE REGULATIONS AND ORDINANCES.

CONTRACTOR TO BE RESPONSIBLE FOR OBTAINING ALL NECESSARY PERMITS FROM ALL AFFECTED AGENCIES AND TO COMPLY WITH ALL APPLICABLE REGULATIONS AND ORDINANCES.

11. CONTRACTOR SHALL BE RESPONSIBLE FOR OBTAINING ALL NECESSARY PERMITS FROM ALL AFFECTED AGENCIES AND TO COMPLY WITH ALL APPLICABLE REGULATIONS AND ORDINANCES.

CONTRACTOR TO BE RESPONSIBLE FOR OBTAINING ALL NECESSARY PERMITS FROM ALL AFFECTED AGENCIES AND TO COMPLY WITH ALL APPLICABLE REGULATIONS AND ORDINANCES.

12. CONTRACTOR SHALL BE RESPONSIBLE FOR OBTAINING ALL NECESSARY PERMITS FROM ALL AFFECTED AGENCIES AND TO COMPLY WITH ALL APPLICABLE REGULATIONS AND ORDINANCES.

CONTRACTOR TO BE RESPONSIBLE FOR OBTAINING ALL NECESSARY PERMITS FROM ALL AFFECTED AGENCIES AND TO COMPLY WITH ALL APPLICABLE REGULATIONS AND ORDINANCES.

13. CONTRACTOR SHALL BE RESPONSIBLE FOR OBTAINING ALL NECESSARY PERMITS FROM ALL AFFECTED AGENCIES AND TO COMPLY WITH ALL APPLICABLE REGULATIONS AND ORDINANCES.

CONTRACTOR TO BE RESPONSIBLE FOR OBTAINING ALL NECESSARY PERMITS FROM ALL AFFECTED AGENCIES AND TO COMPLY WITH ALL APPLICABLE REGULATIONS AND ORDINANCES.

14. CONTRACTOR SHALL BE RESPONSIBLE FOR OBTAINING ALL NECESSARY PERMITS FROM ALL AFFECTED AGENCIES AND TO COMPLY WITH ALL APPLICABLE REGULATIONS AND ORDINANCES.

CONTRACTOR TO BE RESPONSIBLE FOR OBTAINING ALL NECESSARY PERMITS FROM ALL AFFECTED AGENCIES AND TO COMPLY WITH ALL APPLICABLE REGULATIONS AND ORDINANCES.

15. CONTRACTOR SHALL BE RESPONSIBLE FOR OBTAINING ALL NECESSARY PERMITS FROM ALL AFFECTED AGENCIES AND TO COMPLY WITH ALL APPLICABLE REGULATIONS AND ORDINANCES.

CONTRACTOR TO BE RESPONSIBLE FOR OBTAINING ALL NECESSARY PERMITS FROM ALL AFFECTED AGENCIES AND TO COMPLY WITH ALL APPLICABLE REGULATIONS AND ORDINANCES.

16. CONTRACTOR SHALL BE RESPONSIBLE FOR OBTAINING ALL NECESSARY PERMITS FROM ALL AFFECTED AGENCIES AND TO COMPLY WITH ALL APPLICABLE REGULATIONS AND ORDINANCES.

CONTRACTOR TO BE RESPONSIBLE FOR OBTAINING ALL NECESSARY PERMITS FROM ALL AFFECTED AGENCIES AND TO COMPLY WITH ALL APPLICABLE REGULATIONS AND ORDINANCES.

17. CONTRACTOR SHALL BE RESPONSIBLE FOR OBTAINING ALL NECESSARY PERMITS FROM ALL AFFECTED AGENCIES AND TO COMPLY WITH ALL APPLICABLE REGULATIONS AND ORDINANCES.

CONTRACTOR TO BE RESPONSIBLE FOR OBTAINING ALL NECESSARY PERMITS FROM ALL AFFECTED AGENCIES AND TO COMPLY WITH ALL APPLICABLE REGULATIONS AND ORDINANCES.

18. CONTRACTOR SHALL BE RESPONSIBLE FOR OBTAINING ALL NECESSARY PERMITS FROM ALL AFFECTED AGENCIES AND TO COMPLY WITH ALL APPLICABLE REGULATIONS AND ORDINANCES.

CONTRACTOR TO BE RESPONSIBLE FOR OBTAINING ALL NECESSARY PERMITS FROM ALL AFFECTED AGENCIES AND TO COMPLY WITH ALL APPLICABLE REGULATIONS AND ORDINANCES.

19. CONTRACTOR SHALL BE RESPONSIBLE FOR OBTAINING ALL NECESSARY PERMITS FROM ALL AFFECTED AGENCIES AND TO COMPLY WITH ALL APPLICABLE REGULATIONS AND ORDINANCES.

CONTRACTOR TO BE RESPONSIBLE FOR OBTAINING ALL NECESSARY PERMITS FROM ALL AFFECTED AGENCIES AND TO COMPLY WITH ALL APPLICABLE REGULATIONS AND ORDINANCES.

20. CONTRACTOR SHALL BE RESPONSIBLE FOR OBTAINING ALL NECESSARY PERMITS FROM ALL AFFECTED AGENCIES AND TO COMPLY WITH ALL APPLICABLE REGULATIONS AND ORDINANCES.

CONTRACTOR TO BE RESPONSIBLE FOR OBTAINING ALL NECESSARY PERMITS FROM ALL AFFECTED AGENCIES AND TO COMPLY WITH ALL APPLICABLE REGULATIONS AND ORDINANCES.

21. CONTRACTOR SHALL BE RESPONSIBLE FOR OBTAINING ALL NECESSARY PERMITS FROM ALL AFFECTED AGENCIES AND TO COMPLY WITH ALL APPLICABLE REGULATIONS AND ORDINANCES.

CONTRACTOR TO BE RESPONSIBLE FOR OBTAINING ALL NECESSARY PERMITS FROM ALL AFFECTED AGENCIES AND TO COMPLY WITH ALL APPLICABLE REGULATIONS AND ORDINANCES.

22. CONTRACTOR SHALL BE RESPONSIBLE FOR OBTAINING ALL NECESSARY PERMITS FROM ALL AFFECTED AGENCIES AND TO COMPLY WITH ALL APPLICABLE REGULATIONS AND ORDINANCES.

CONTRACTOR TO BE RESPONSIBLE FOR OBTAINING ALL NECESSARY PERMITS FROM ALL AFFECTED AGENCIES AND TO COMPLY WITH ALL APPLICABLE REGULATIONS AND ORDINANCES.

23. CONTRACTOR SHALL BE RESPONSIBLE FOR OBTAINING ALL NECESSARY PERMITS FROM ALL AFFECTED AGENCIES AND TO COMPLY WITH ALL APPLICABLE REGULATIONS AND ORDINANCES.

DESIGNED BY: DATE: BY: REVIEWED: DATE: BY: REVISION: DATE: BY:

San Antonio County 2013194 - 02016 Rev: 07/27/2017 4:21:20 PM

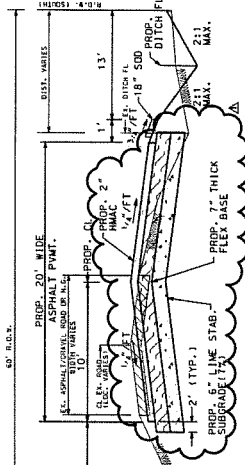

PROPOSED TYPE SECTION FOR EX. ASPHALT GRAVEL PAVT. (NO. 400) PAVT. FOR EX. ASPHALT GRAVEL PAVT. (NO. 400) PAVT. AVENUE DISTA. 2+59 TO STA. 19+00

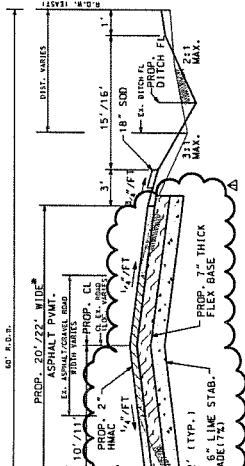

PROPOSED TYPE SECTION FOR EX. ASPHALT GRAVEL PAVT. (NO. 400) PAVT. 16TH STREET STA. 1+22 TO STA. 12+17.26

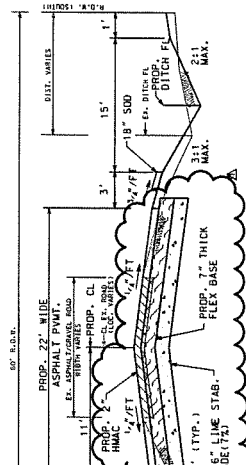

PROPOSED TYPE SECTION FOR EX. ASPHALT GRAVEL PAVT. (NO. 400) PAVT. AVENUE DISTA. 2+28 TO STA. 44+23

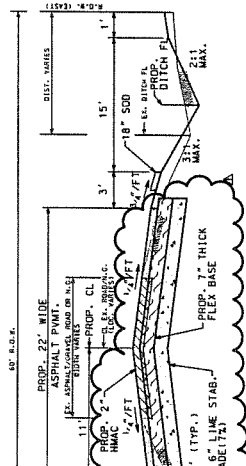

PROPOSED TYPE SECTION FOR EX. ASPHALT GRAVEL PAVT. (NO. 400) PAVT. 16TH STREET STA. 1+22 TO STA. 47+26.27

NOTE:
1/2" WIDE SOD IS TO BE PLACED ALONG THE T.O.E. OF THE ROAD SEC. DITCHES. ALL OTHER DISTURBED AREAS BETWEEN EDGE OF ROAD AND RIGHT-OF-WAY ARE TO BE RECONSTRUCTED.



SAN LEON ROADS RECONSTRUCTION
(14th, 15th, 16th, & AVE. D)

Engineering and Surveying
9890
Houston, Texas 77052
(713) 783-7788 (713) 783-3860 Fax
TBPES FIRM REG. NO. 280
TBPES FIRM REG. NO. 100068



DESIGNED BY:	
DESIGN CHECKED BY:	
DRAWN BY:	
COORD. CHECKED BY:	
SURVEY CHECKED BY:	
QA/QC REVISIONS BY:	

NO.	DATE	BY

REVISIONS:
 NO. 01 - PER CHANGE NO. 1815 FROM PA 644 PROJECT,
 5/11/95. THE CONTRACT WITH ALUMINUM COIL STAMPED
 INTERSECTION OF 14TH ST AND MAINWAY IS RELATED
 TO THE INTERSECTION OF 14TH ST AND MAINWAY, 20-FEET
 WIDENING OF MAINWAY AND MAINWAY, 20-FEET
 WIDENING OF MAINWAY AND MAINWAY, 20-FEET
 WIDENING OF MAINWAY AND MAINWAY, 20-FEET
 WIDENING OF MAINWAY AND MAINWAY, 20-FEET
 ELEVATION + 5.17 FEET. CHANGE NO. 1815/17.

LEGEND:
 (1) REMODE & RELOCATE EX. WATER
 METER 14-FEET FROM R.O.B.
 (2) TO USE EX. 4" DIA. WATER MAIN
 TO USE EX. 4" DIA. WATER MAIN

PROPOSED CONCRETE TABLE		
LOC.	STA.	TYPE
11	2+00	18" x 18" x 24" SLAB
12	2+00	18" x 18" x 24" SLAB
13	2+00	18" x 18" x 24" SLAB
14	2+00	18" x 18" x 24" SLAB
15	2+00	18" x 18" x 24" SLAB
16	2+00	18" x 18" x 24" SLAB
17	2+00	18" x 18" x 24" SLAB
18	2+00	18" x 18" x 24" SLAB
19	2+00	18" x 18" x 24" SLAB
20	2+00	18" x 18" x 24" SLAB
21	2+00	18" x 18" x 24" SLAB
22	2+00	18" x 18" x 24" SLAB
23	2+00	18" x 18" x 24" SLAB
24	2+00	18" x 18" x 24" SLAB
25	2+00	18" x 18" x 24" SLAB
26	2+00	18" x 18" x 24" SLAB
27	2+00	18" x 18" x 24" SLAB
28	2+00	18" x 18" x 24" SLAB
29	2+00	18" x 18" x 24" SLAB
30	2+00	18" x 18" x 24" SLAB
31	2+00	18" x 18" x 24" SLAB
32	2+00	18" x 18" x 24" SLAB
33	2+00	18" x 18" x 24" SLAB
34	2+00	18" x 18" x 24" SLAB
35	2+00	18" x 18" x 24" SLAB
36	2+00	18" x 18" x 24" SLAB
37	2+00	18" x 18" x 24" SLAB
38	2+00	18" x 18" x 24" SLAB
39	2+00	18" x 18" x 24" SLAB
40	2+00	18" x 18" x 24" SLAB
41	2+00	18" x 18" x 24" SLAB
42	2+00	18" x 18" x 24" SLAB
43	2+00	18" x 18" x 24" SLAB
44	2+00	18" x 18" x 24" SLAB
45	2+00	18" x 18" x 24" SLAB
46	2+00	18" x 18" x 24" SLAB
47	2+00	18" x 18" x 24" SLAB
48	2+00	18" x 18" x 24" SLAB
49	2+00	18" x 18" x 24" SLAB
50	2+00	18" x 18" x 24" SLAB

NOTES:
 1. EXIST. CURBS 118" OR SMALLER,
 SHALL BE REMOVED AND REPLACED WITH
 12" CURBS. EX. 4" DIA. WATER MAINS
 WILL BE REMOVED AND REPLACED WITH
 6" DIA. WATER MAINS.
 2. THE FILL TO BE PLACED 34' FOR BRIDGING &
 2' FOR CURB CURVE DATA.

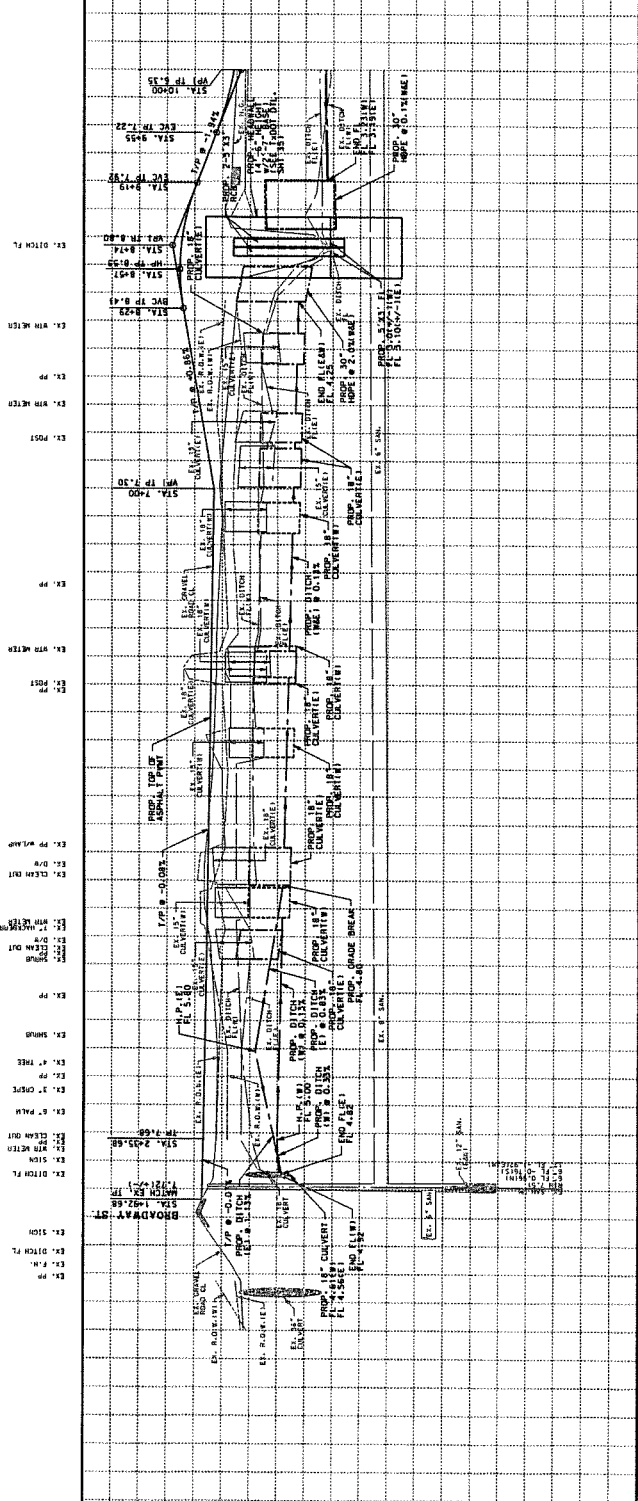
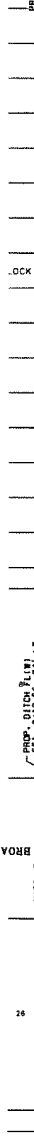
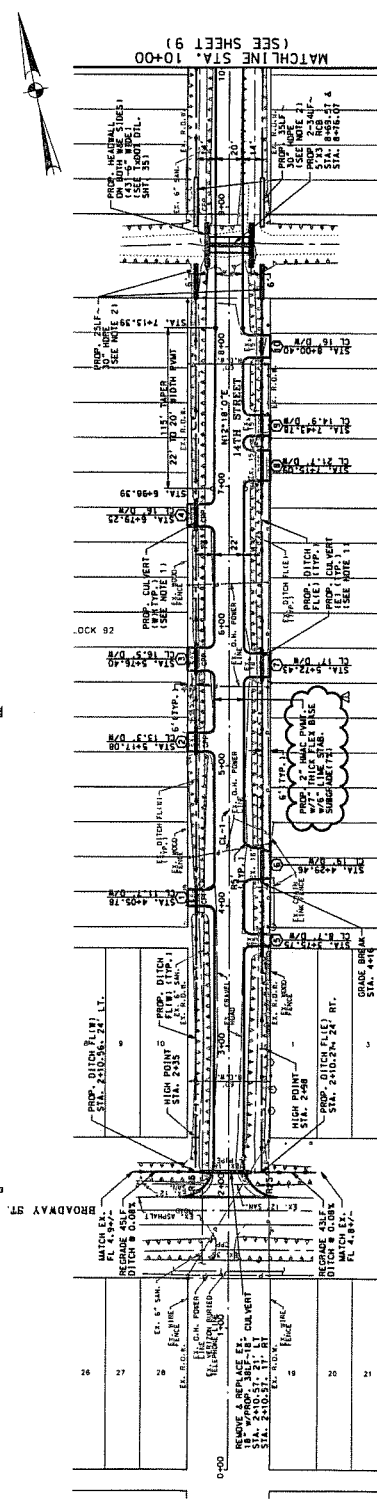

SCALE: 1" = 40' HORIZ.
 1" = 2' VERT.
 CL CURVE DATA

SAN LEON ROADS RECONSTRUCTION
 (14th, 15th, 16th, & AVE. D)

14TH STREET - STA. 0+00 TO STA. 10+00

Engineers and Surveyors
 8990 Richmond Avenue, Suite 450 N
 Houston, Texas 77042
 (713) 793-7788 (713) 763-5580, Fax
 TBP Firm Reg. No. 280
 TBP Plus Firm Reg. No. 100686

Costello

DESIGNED BY: _____ DATE: _____
 DRAWN BY: _____ DATE: _____
 CHECKED BY: _____ DATE: _____
 OAC BY: _____ DATE: _____

SHEET 8
 OF 77
 SHEETS

14TH STREET - STA. 0+00 TO STA. 10+00

DESIGNED BY: _____ DATE: _____
 DRAWN BY: _____ DATE: _____
 CHECKED BY: _____ DATE: _____
 OAC BY: _____ DATE: _____

PROPOSED 14th ST. TO BE 16' FROM F.M. 646 PROJECT.
 THE 14th ST. TO BE 16' FROM F.M. 646 PROJECT.
 THE 14th ST. TO BE 16' FROM F.M. 646 PROJECT.
 THE 14th ST. TO BE 16' FROM F.M. 646 PROJECT.
 THE 14th ST. TO BE 16' FROM F.M. 646 PROJECT.
 THE 14th ST. TO BE 16' FROM F.M. 646 PROJECT.



- LEGEND**
- ⊙ REMOVE & REGRADE EXIST. WATER
 - ⊙ METER T-ROOT FROM MAIN TO BE
 - ⊙ FLUSH W/PROP. WATER
- NOTE 1:** EXISTING 18" (Ø) (CONCRETE) CULVERT TO BE REMOVED & REPLACED WITH PROP. 18" (Ø) (CONCRETE) CULVERT. ALL EXIST. 18" (Ø) (CONCRETE) CULVERTS TO BE REPLACED WITH PROP. SAME SIZE CULVERTS.

LOC.	START	END	CONV.	CH.	L.	W.	START	END
0+0	1+00.00	1+50.00	12"	12"	12"	12"	1+00.00	1+50.00
0+5	1+50.00	2+00.00	12"	12"	12"	12"	1+50.00	2+00.00
0+10	2+00.00	2+50.00	12"	12"	12"	12"	2+00.00	2+50.00
0+15	2+50.00	3+00.00	12"	12"	12"	12"	2+50.00	3+00.00
0+20	3+00.00	3+50.00	12"	12"	12"	12"	3+00.00	3+50.00
0+25	3+50.00	4+00.00	12"	12"	12"	12"	3+50.00	4+00.00
0+30	4+00.00	4+50.00	12"	12"	12"	12"	4+00.00	4+50.00
0+35	4+50.00	5+00.00	12"	12"	12"	12"	4+50.00	5+00.00
0+40	5+00.00	5+50.00	12"	12"	12"	12"	5+00.00	5+50.00
0+45	5+50.00	6+00.00	12"	12"	12"	12"	5+50.00	6+00.00
0+50	6+00.00	6+50.00	12"	12"	12"	12"	6+00.00	6+50.00
0+55	6+50.00	7+00.00	12"	12"	12"	12"	6+50.00	7+00.00
0+60	7+00.00	7+50.00	12"	12"	12"	12"	7+00.00	7+50.00
0+65	7+50.00	8+00.00	12"	12"	12"	12"	7+50.00	8+00.00
0+70	8+00.00	8+50.00	12"	12"	12"	12"	8+00.00	8+50.00
0+75	8+50.00	9+00.00	12"	12"	12"	12"	8+50.00	9+00.00
0+80	9+00.00	9+50.00	12"	12"	12"	12"	9+00.00	9+50.00
0+85	9+50.00	10+00.00	12"	12"	12"	12"	9+50.00	10+00.00

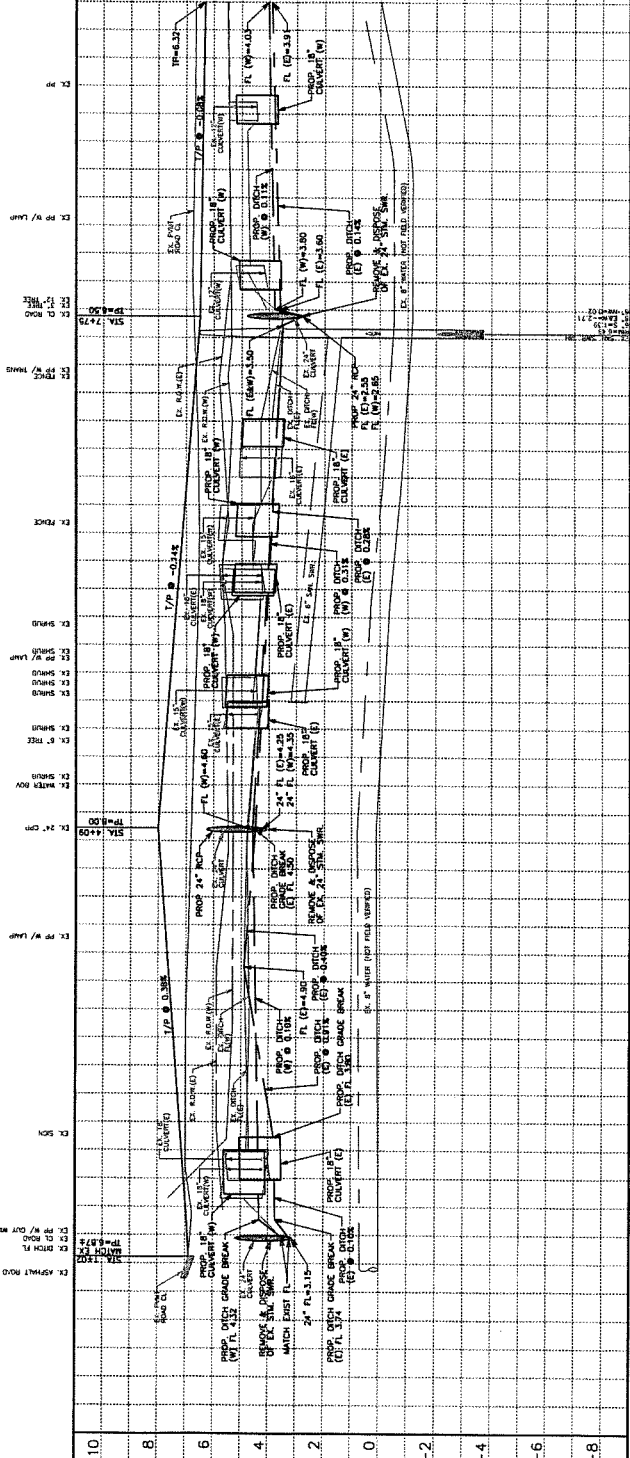
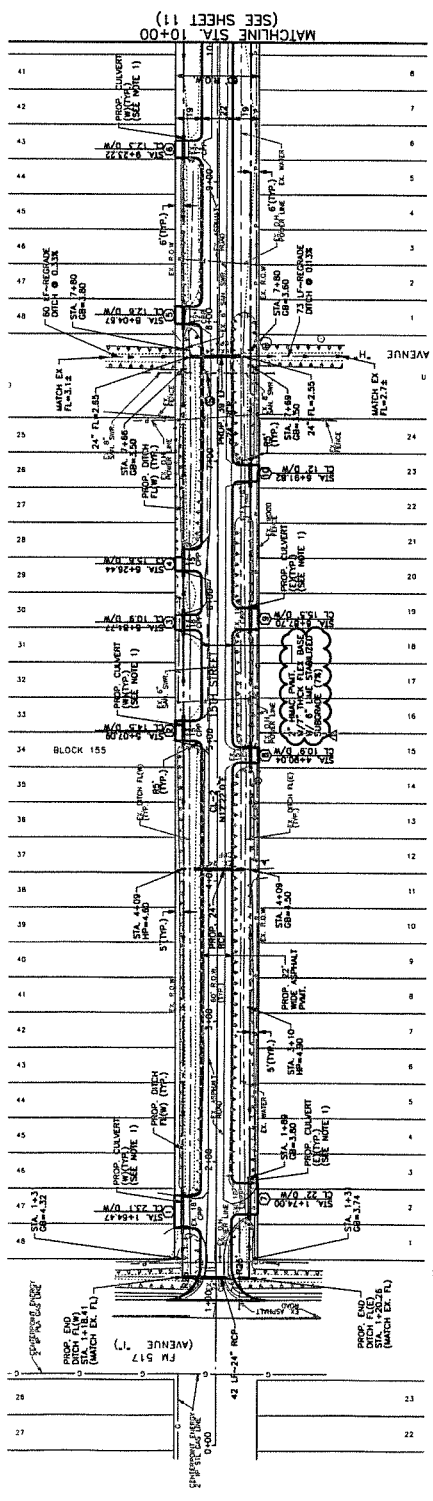

SCALE: 1" = 40' HORZ.
 1" = 2' VERT.
 Q. CURVE DATA

GALVESTON COUNTY STREET RECONSTRUCTION
 (14th, 15th, 16th, & AVE. D)

PLAN AND PROFILE
 15TH STREET - STA. 0+00 TO STA. 10+00

ENGINEERING AND SURVEYING
 9990 Richmond Avenue, Suite 460 N
 Houston, Texas 77042
 (713) 783-7788 (713) 783-8580, Fax
 (713) 783-7788 (713) 783-8580, Fax
 TBP-FIRM REG. NO. 280
 TBP-FIRM REG. NO. 100866

Costello

DESIGNED BY: _____ DATE: _____
 DRAWN BY: _____
 CHECKED BY: _____
 O.V.C. BY: _____

NO.	REVISION	DATE	BY

RESURFACE BLOCK NO. 115 FROM 14th STREET TO 15th STREET. THE RESURFACING SHALL BE 1/2" THICK ALUMINUM OXIDE STAMPED TO MATCH THE SURFACE OF THE EXISTING SURFACE. THE CURB SHALL BE 3" HIGH AND 6" WIDE. THE CURB SHALL BE COLORED TO MATCH THE SURFACE OF THE EXISTING SURFACE. THE CURB SHALL BE 3" HIGH AND 6" WIDE. THE CURB SHALL BE COLORED TO MATCH THE SURFACE OF THE EXISTING SURFACE.

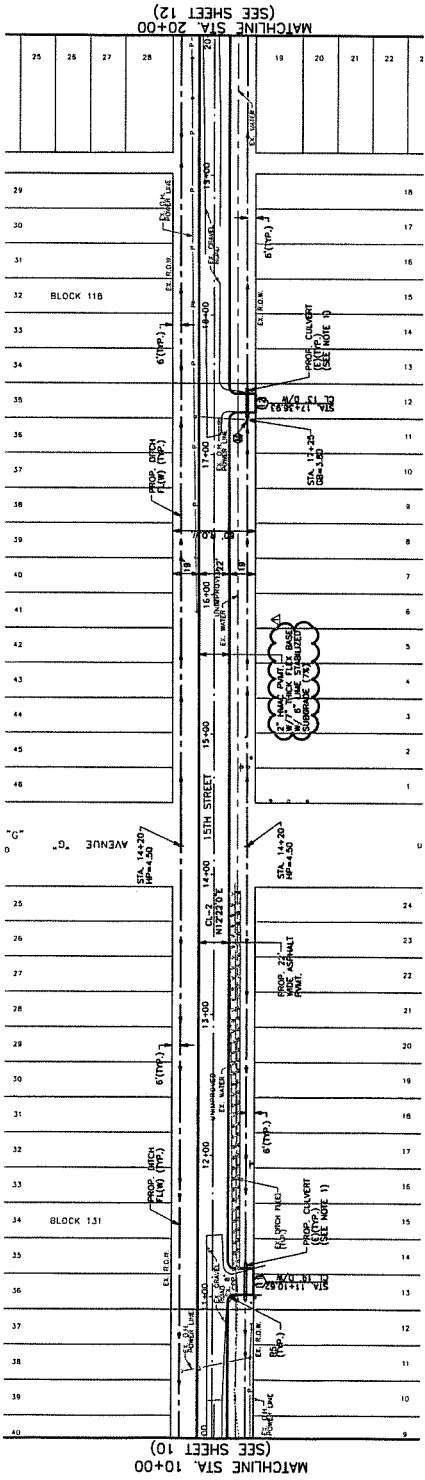

LEGEND:
 (Symbol) RETAIN & RELOCATE EXIST. WATER
 (Symbol) ADJUST S&W SUR. AND B.M. TO BE
 (Symbol) FLUSH w/ PROP. PAVEMENT

NOTE:
 1. CURBS (1/2" OR SMALLER) WILL BE REMOVED AND REPLACED WITH PROP. SAME SIZE CURBS.
 2. CURBS (LARGER) WILL BE REMOVED AND REPLACED WITH PROP. SAME SIZE CURBS.

LOC.	DATE	BY	SCALE	DESCRIPTION
10+00	01/11/23	JL	1" = 40' HORIZ. 1" = 2' VERT.	PLAN AND PROFILE

CL. CURVE DATA

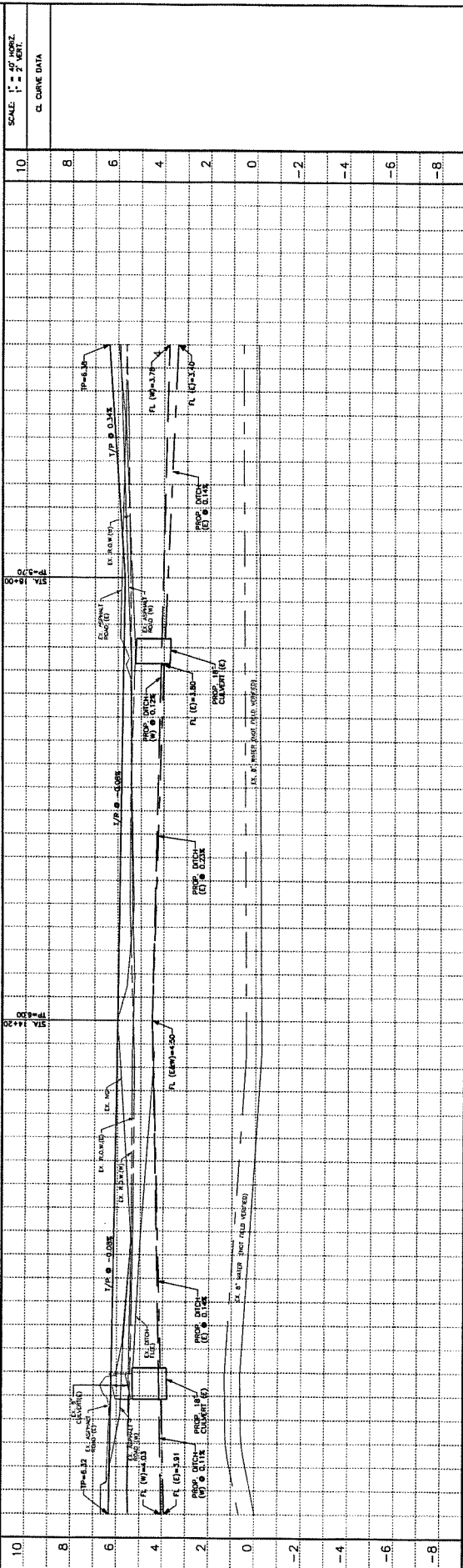

SHEET **11**

DATE **07** OF **77** SHEETS

JOB NO. 201814

GALVESTON COUNTY STREET RECONSTRUCTION
 (14th, 15th, 16th, & AVE. D)

PLAN AND PROFILE
 15TH STREET - STA. 10+00 TO 20+00

Engineering and Surveying
 9900 Katy Road, Suite 450 N
 Houston, Texas 77052
 (713) 783-7786 / (713) 783-5580, Fax
 TBPE FIRM REG. NO. 280
 TBPLUS FIRM REG. NO. 100486

NO.	REVISION	DATE	BY

REMARKS:
 1. ALL WORK SHALL BE IN ACCORDANCE WITH THE LATEST EDITIONS OF THE TEXAS STANDARD SPECIFICATIONS FOR HIGHWAY CONSTRUCTION, 2011 EDITION, AS AMENDED BY THE LATEST CORRECTIONS AND ADDENDUMS, AND THE LATEST EDITIONS OF THE TEXAS STANDARD SPECIFICATIONS FOR WATERWAY CONSTRUCTION, 2011 EDITION, AS AMENDED BY THE LATEST CORRECTIONS AND ADDENDUMS.

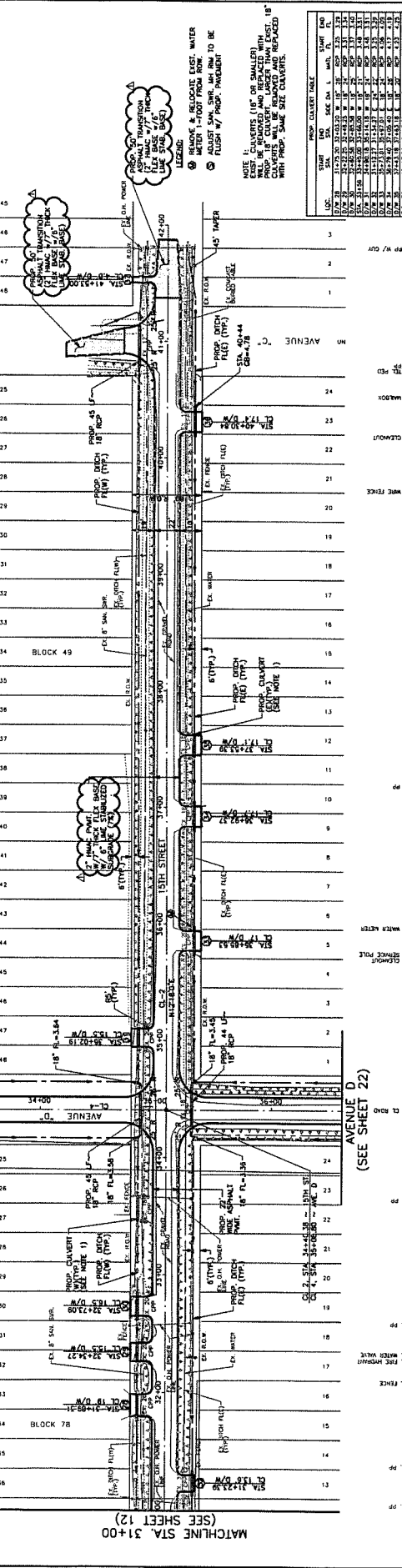

PROPOSED CONDUIT TABLE

LOC.	START STA.	END STA.	SIZE DIA.	MATERIAL	START DIA.	END DIA.
1	31+00	31+50	18"	PVC	18"	18"
2	31+50	32+00	18"	PVC	18"	18"
3	32+00	32+50	18"	PVC	18"	18"
4	32+50	33+00	18"	PVC	18"	18"
5	33+00	33+50	18"	PVC	18"	18"
6	33+50	34+00	18"	PVC	18"	18"
7	34+00	34+50	18"	PVC	18"	18"
8	34+50	35+00	18"	PVC	18"	18"
9	35+00	35+50	18"	PVC	18"	18"
10	35+50	36+00	18"	PVC	18"	18"
11	36+00	36+50	18"	PVC	18"	18"
12	36+50	37+00	18"	PVC	18"	18"
13	37+00	37+50	18"	PVC	18"	18"
14	37+50	38+00	18"	PVC	18"	18"
15	38+00	38+50	18"	PVC	18"	18"
16	38+50	39+00	18"	PVC	18"	18"
17	39+00	39+50	18"	PVC	18"	18"
18	39+50	40+00	18"	PVC	18"	18"
19	40+00	40+50	18"	PVC	18"	18"
20	40+50	41+00	18"	PVC	18"	18"
21	41+00	41+50	18"	PVC	18"	18"
22	41+50	42+00	18"	PVC	18"	18"

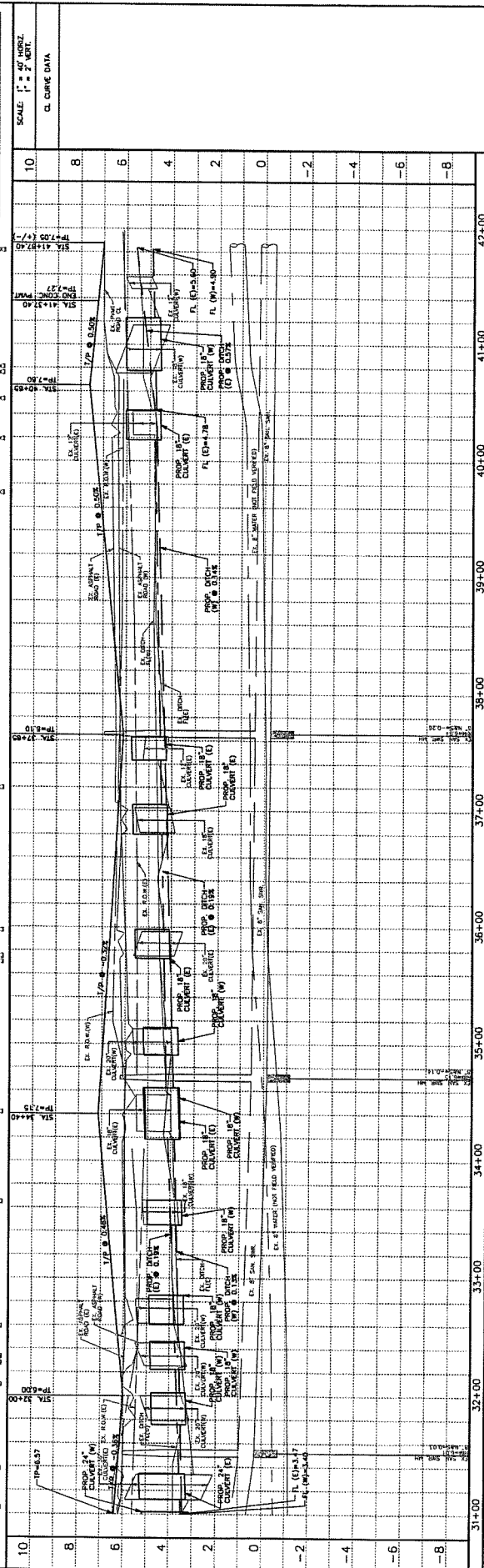

Costello

Engineering and Surveying
 9900 Katy Road, Suite 400 N
 Houston, Texas 77024
 (713) 763-7788 (713) 763-5880, FAX
 TBPE FIRM REG. NO. 280
 TBPLS FIRM REG. NO. 000488

GALVESTON COUNTY STREET RECONSTRUCTION
 (14th, 15th, 16th, & AVE. D)
 PLAN AND PROFILE
 15TH STREET - STA. 31+00 TO END

DESIGNED BY: _____
 DRAWN BY: _____
 CHECKED BY: _____
 DATE: _____

REVISION: _____ DATE: _____ BY: _____

SHEET 13 OF 77 SHEETS
 JOB NO. 28114

PROJECT: GALVESTON COUNTY STREET RECONSTRUCTION (14th, 15th, 16th, & AVE. D)
 SHEET NO. 77 OF 77 SHEETS
 DATE: 02/27/11
 DRAWN BY: [Redacted]
 CHECKED BY: [Redacted]
 SCALE: 1" = 40' HORIZ., 1" = 2' VERT.

LEGEND:
 ○ REMOVE & RELOCATE EXIST. WATER
 ○ METER 1' SHOT FROM INCH TO BE
 ○ FLUSH W/ FRESH WATER
 ○ EXIST. CHANGERS (18" OR SMALLER)
 ○ NEW CHANGERS (18" OR SMALLER)
 ○ EXIST. CHANGERS TO BE REPAIRED AND REPLACED WITH
 ○ NEW CHANGERS TO BE REPAIRED AND REPLACED WITH
 ○ EXIST. CHANGERS TO BE REPAIRED AND REPLACED WITH
 ○ NEW CHANGERS TO BE REPAIRED AND REPLACED WITH

LOC.	STA.	CON.	SIZE	DA.	L.	MA.	IN.	IN.
07A	1432.42	18"	30'	12"	10"	12"	12"	12"
07B	1432.42	18"	30'	12"	10"	12"	12"	12"
07C	1432.42	18"	30'	12"	10"	12"	12"	12"
07D	1432.42	18"	30'	12"	10"	12"	12"	12"
07E	1432.42	18"	30'	12"	10"	12"	12"	12"
07F	1432.42	18"	30'	12"	10"	12"	12"	12"
07G	1432.42	18"	30'	12"	10"	12"	12"	12"
07H	1432.42	18"	30'	12"	10"	12"	12"	12"
07I	1432.42	18"	30'	12"	10"	12"	12"	12"
07J	1432.42	18"	30'	12"	10"	12"	12"	12"
07K	1432.42	18"	30'	12"	10"	12"	12"	12"
07L	1432.42	18"	30'	12"	10"	12"	12"	12"
07M	1432.42	18"	30'	12"	10"	12"	12"	12"
07N	1432.42	18"	30'	12"	10"	12"	12"	12"
07O	1432.42	18"	30'	12"	10"	12"	12"	12"
07P	1432.42	18"	30'	12"	10"	12"	12"	12"
07Q	1432.42	18"	30'	12"	10"	12"	12"	12"
07R	1432.42	18"	30'	12"	10"	12"	12"	12"
07S	1432.42	18"	30'	12"	10"	12"	12"	12"
07T	1432.42	18"	30'	12"	10"	12"	12"	12"
07U	1432.42	18"	30'	12"	10"	12"	12"	12"
07V	1432.42	18"	30'	12"	10"	12"	12"	12"
07W	1432.42	18"	30'	12"	10"	12"	12"	12"
07X	1432.42	18"	30'	12"	10"	12"	12"	12"
07Y	1432.42	18"	30'	12"	10"	12"	12"	12"
07Z	1432.42	18"	30'	12"	10"	12"	12"	12"

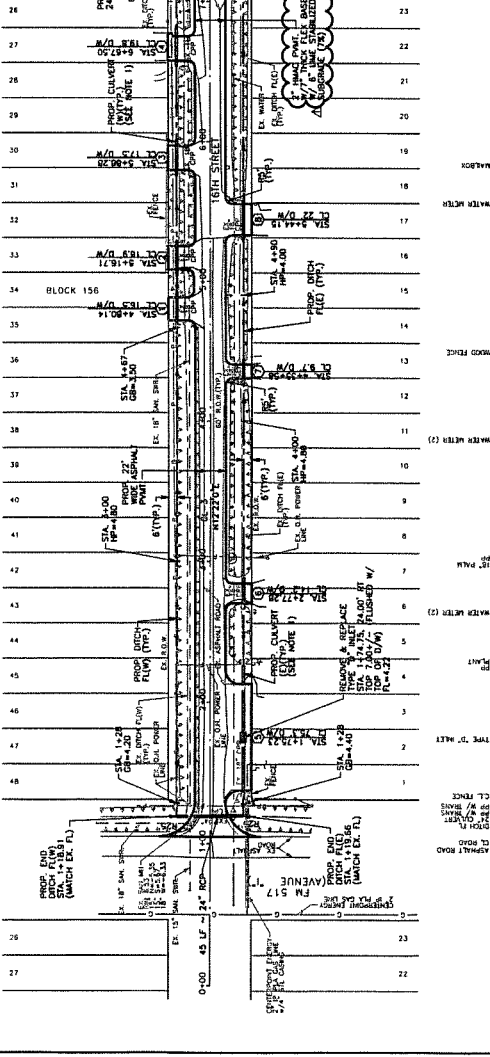
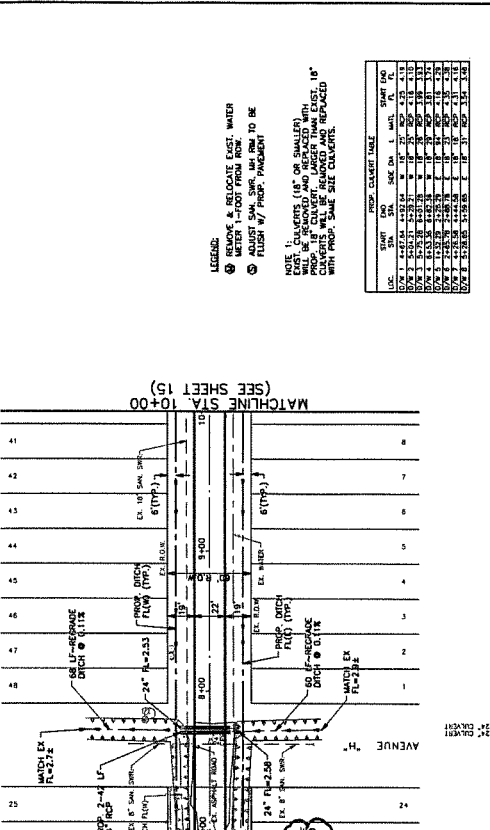

GALVESTON COUNTY STREET RECONSTRUCTION
 (14th, 15th, 16th, & AVE. D)
 PLAN AND PROFILE
 16TH STREET - STA. 0+00 TO STA. 10+00

DESIGNED BY: [Redacted]
 DESIGN CHECKED BY: [Redacted]
 DRAWN BY: [Redacted]
 CHECKED BY: [Redacted]

DATE: 02/27/11

ENGINEERING AND SURVEYING
 9900 Richmond Avenue, Suite 450 N
 Houston, Texas 77042
 (713) 783-7888 (713) 783-3880 Fax
 TBP&S FIRM REG. NO. 280
 TBP&S FIRM REG. NO. 100486

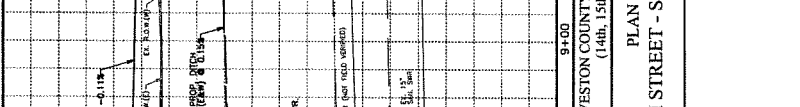

14
 SHEET
 OF 77 SHEETS
 JOB NO. 201104

REVISIONS:
 1. ALL WORK SHALL BE IN ACCORDANCE WITH THE LATEST EDITION OF THE STANDARD SPECIFICATIONS FOR PUBLIC WORKS OF THE STATE OF TEXAS, LATEST EDITION.
 2. ALL DIMENSIONS SHALL BE IN FEET AND INCHES, UNLESS OTHERWISE SPECIFIED.
 3. ALL DIMENSIONS SHALL BE TO THE CENTERLINE OF THE ROADWAY UNLESS OTHERWISE SPECIFIED.
 4. ALL DIMENSIONS SHALL BE TO THE CENTERLINE OF THE ROADWAY UNLESS OTHERWISE SPECIFIED.
 5. ALL DIMENSIONS SHALL BE TO THE CENTERLINE OF THE ROADWAY UNLESS OTHERWISE SPECIFIED.

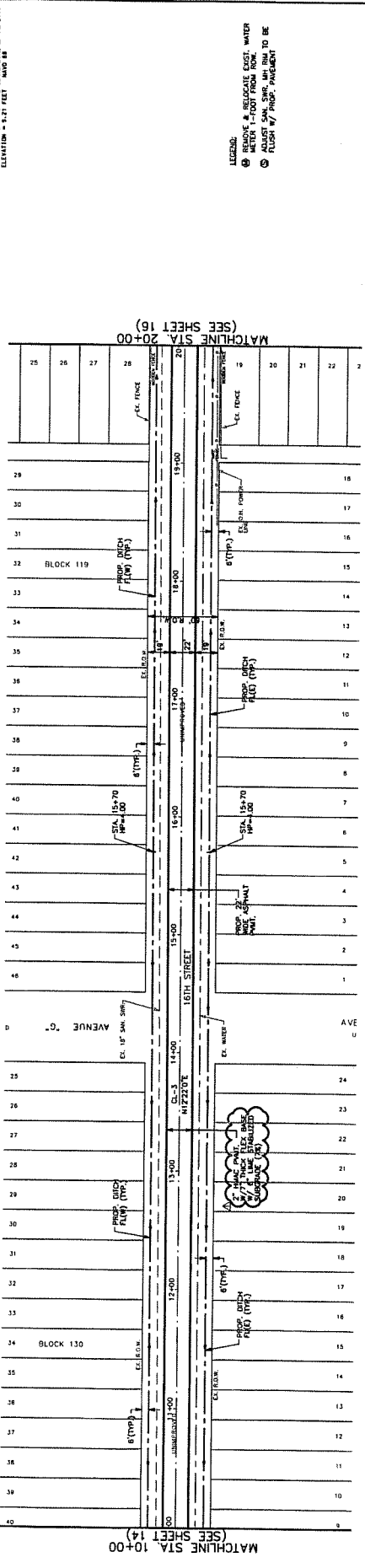

LEGEND:
 (Symbol) REMAIN & RECONSTRUCT EXIST. WATER
 (Symbol) REMAIN & RECONSTRUCT EXIST. SEWER
 (Symbol) REMAIN & RECONSTRUCT EXIST. GAS

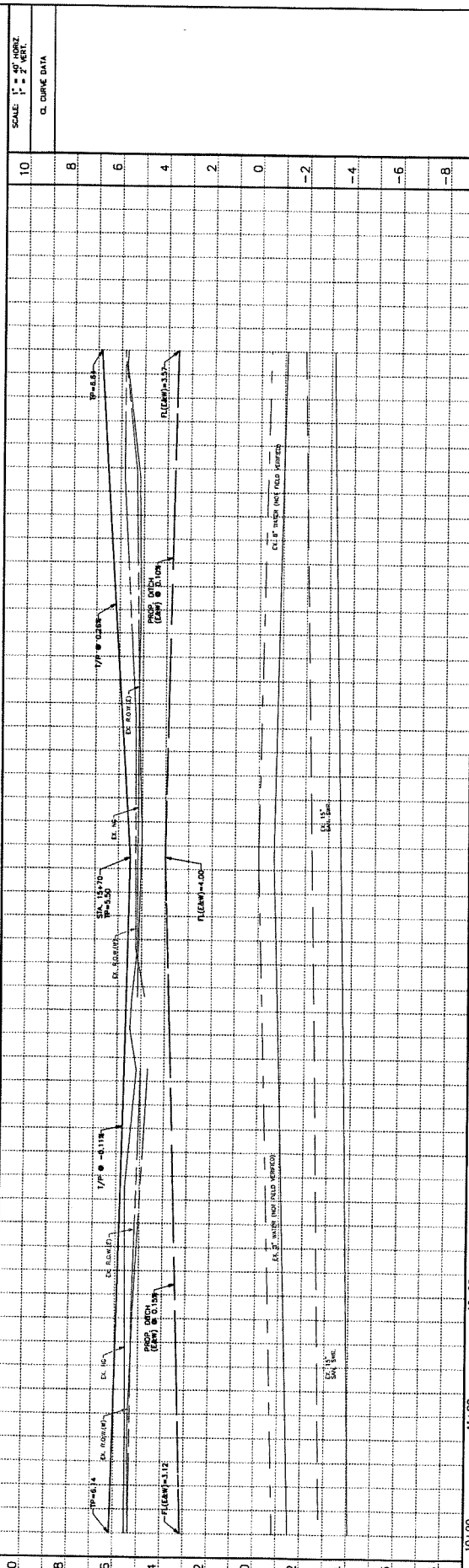

SCALE: 1" = 40' VERT.
 1" = 20' HORIZ.
 CL. CURVE DATA



GALVESTON COUNTY STREET RECONSTRUCTION
 (14th, 15th, 16th, & AVE. D)
 PLAN AND PROFILE
 16TH STREET - STA. 10+00 TO 20+00

Engineering and Surveying
 9980 Richmond Avenue, Suite 160 N
 Houston, Texas 77042
 (713) 785-7788 (713) 785-3500, Fax
 (713) 785-7788
 TBPE FIRM REG. NO. 280
 TBPLS FIRM REG. NO. 100486



DESIGNED BY: _____
 DESIGN CHECKED BY: _____
 DRAWN BY: _____
 SURVEY CHECKED BY: _____
 QUANTITY BY: _____
 DATE: _____

NO.	REVISION	DATE	BY

REVISIONS:
 REVISION NO. 1-14 FROM THE PROJECT:
 1-15 TO 1-17 FROM THE ALUMINUM CAP STAMPED
 1-18 TO 1-21 FROM THE ALUMINUM CAP STAMPED
 INTERSECTION OF 16TH AND AVENUE D, LOCATED
 APPROXIMATELY 1/4 MILE WEST OF STATE STREET
 APPROXIMATELY 1/4 MILE EAST OF STATE STREET
 ELEVATION = 2.7 FEET, 1987 M.D.P. 14311.

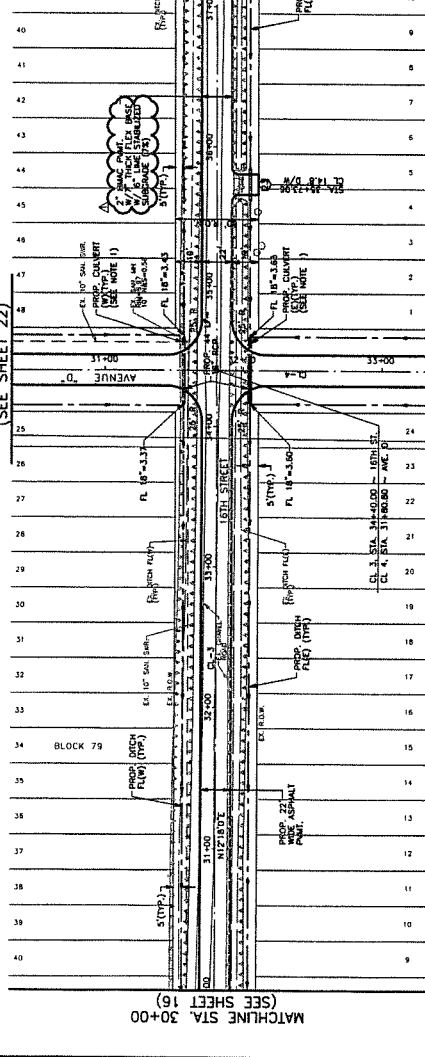
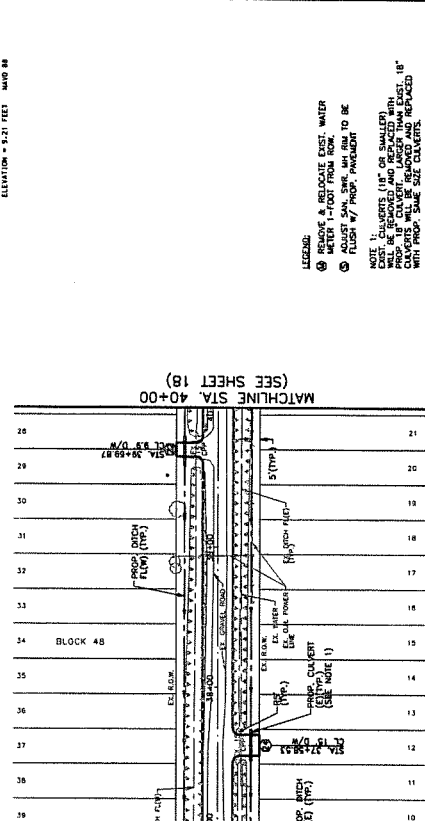

LEGEND:
 (Symbol) REMOVE & RELOCATE EXIST. WATER
 (Symbol) ADJUST SAN. SINK. W/ RISE TO BE
 (Symbol) FLUSH W/ PROP. PAVEDMENT

NOTE 1: ALL WORKERS MUST BE QUALIFIED
 TO REMOVE AND RELOCATE EXIST. WATER
 CONCRETE SHALL BE REMOVED AND REPLACED
 WITH PROP. SAME SIZE CONCRETE.

LOC.	STATION	DATE	BY	NO.	DATE	BY	NO.
30+00	31+00	32+00	33+00	34+00	35+00	36+00	37+00

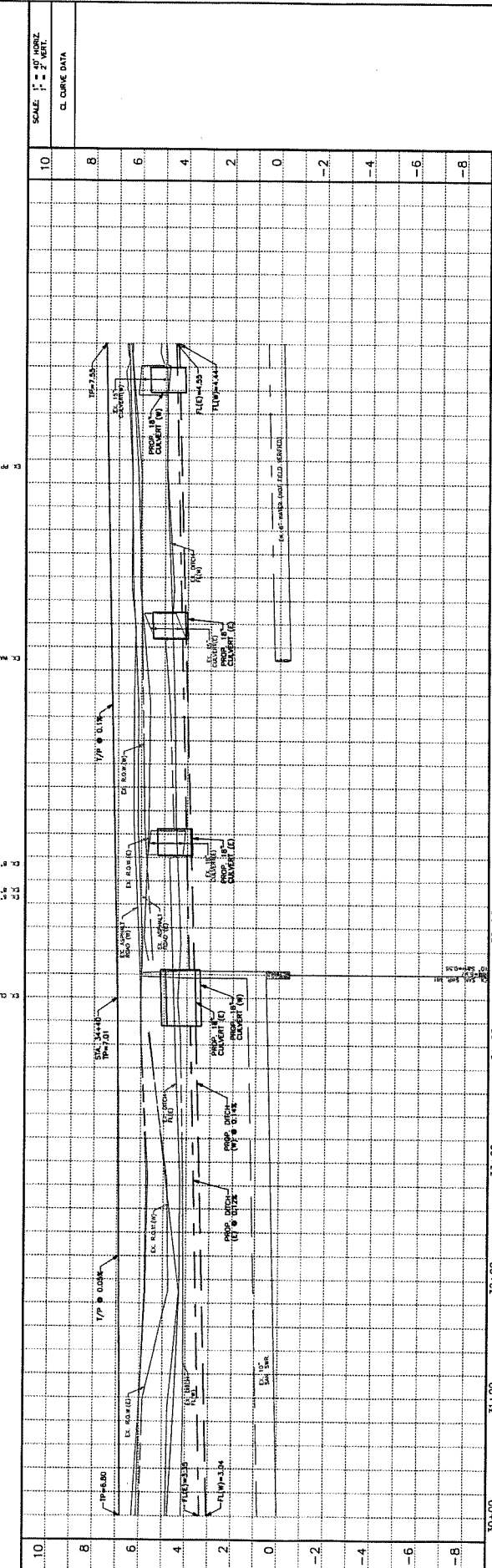

GALVESTON COUNTY STREET RECONSTRUCTION
 (14th, 15th, 16th, & AVE. D)
PLAN AND PROFILE
16TH STREET - STA. 30+00 TO 40+00

ENGINEERING AND SURVEYING
 9990 RICHMOND AVENUE, SUITE 450 N
 HOUSTON, TEXAS 77042
 (713) 783-7788 (713) 783-8860, FAX
 (713) 783-7788 (713) 783-8860, FAX
 TSP-COS FROM REG. NO. 100866

SHEET **17** OF **77** SHEETS
 JOB NO. 201504
 DATE: **12/17/07**

DESIGNED BY: _____
 DRAWN BY: _____
 CHECKED BY: _____
 SURVEY CHECKED BY: _____
 QA/QC BY: _____ DATE: _____
 REVISION: _____

17/17/07
 17/17/07
 17/17/07
 17/17/07

PROPOSED SANITARY SEWER MAINS SHALL BE 18" DIAMETER POLYETHYLENE GLASS REINFORCED CONCRETE PIPE (PCCP) WITH ALUMINUM CAP STAMPED WITH THE MANUFACTURER'S NAME AND THE DATE OF MANUFACTURE. THE PIPE SHALL BE INSTALLED WITH A MINIMUM COVER OF 18" AND SHALL BE PROTECTED BY A 6" THICK CONCRETE SLAB. THE SLAB SHALL BE 6" THICK AND SHALL BE REINFORCED WITH #4 BARS AT 18" ON CENTER. THE SLAB SHALL BE 6" THICK AND SHALL BE REINFORCED WITH #4 BARS AT 18" ON CENTER. THE SLAB SHALL BE 6" THICK AND SHALL BE REINFORCED WITH #4 BARS AT 18" ON CENTER.



MATCH LINE STA. 10+00
(SEE SHEET 20)

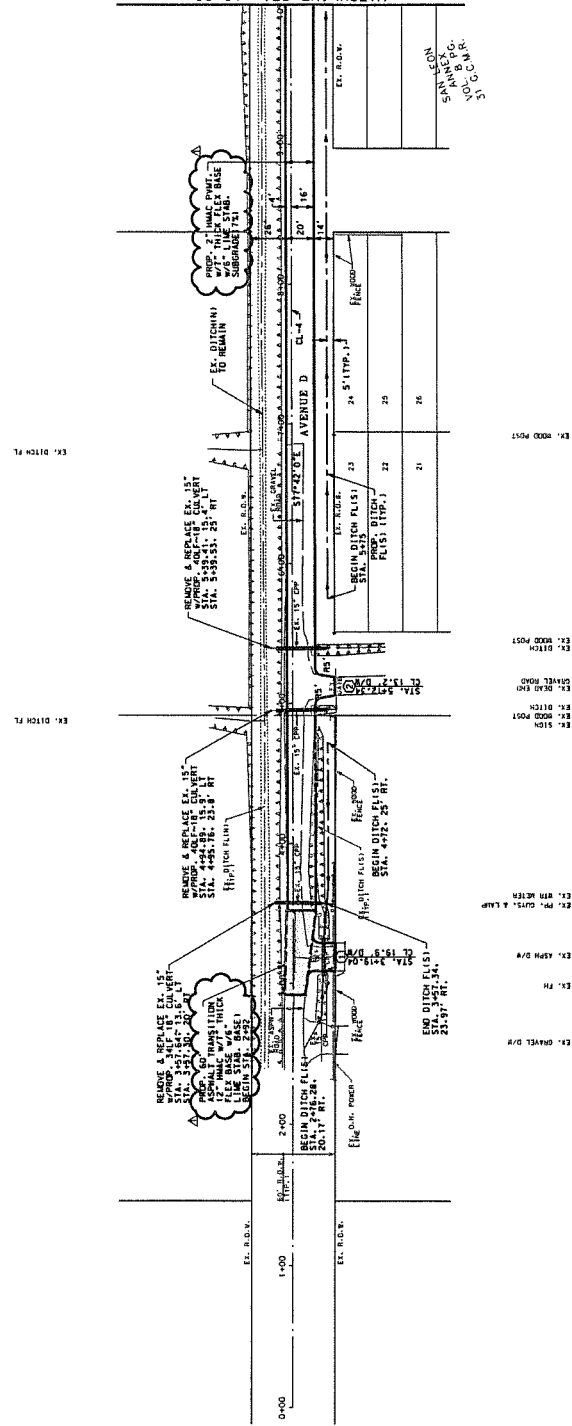

LEGEND:
 (M) REMOVE & REPLACE EX. WATER METEOR. 1-FOOT FROM R.O.W.
 (S) ADJUST EX. SAN. M.H. RIM TO BE FLOSH W/PROP. PAVEMENT

LOC.	STAT.	PROP. CURVE TABLE
0+00	10+00	100' C.M.P.
0+00	10+00	5' C.M.P.

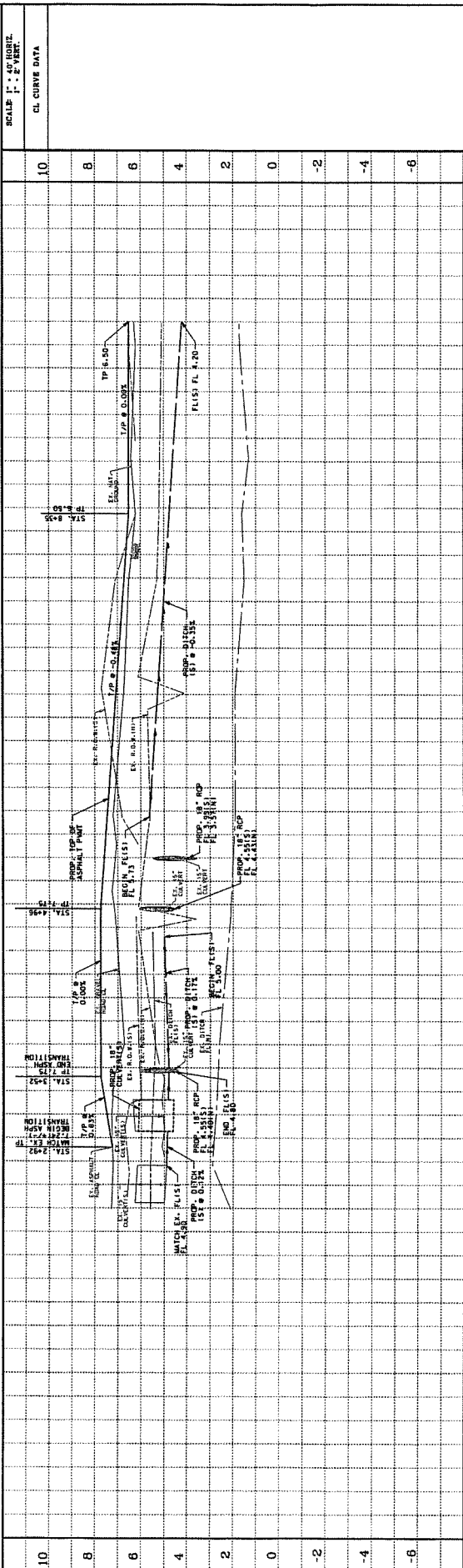

SCALE: 1" = 40' HORIZ.
 1" = 2' VERT.



SHEET 19
 OF 77 SHEETS
 20180305194

SAN LEON ROADS RECONSTRUCTION
 (14th, 15th, 16th, & AVE. D)
 PLAN AND PROFILE
 AVENUE D - STA. 0+00 TO STA. 10+00

Costello
 Engineering and Surveying
 8800 Richmond Avenue, Suite 450 N
 Houston, Texas 77042
 (713) 783-7798 (713) 783-3580, Fax
 (713) 783-7798 (713) 783-3580, Fax
 TBPES FIRM REG. NO. 280
 TBPES FIRM REG. NO. 100486

NO.	REVISION	DATE	BY

DESIGNED BY: []
 DRAWN BY: []
 CHECKED BY: []
 DATE: []

DESIGNER: **Costello**
 PROJECT NO. 20-00
 SHEET NO. 77
 DATE: 10/20/17

ENGINEER: **Costello**
 PROJECT NO. 20-00
 SHEET NO. 77
 DATE: 10/20/17

SCALE: 1" = 40' HORIZONTAL
 1" = 2' VERTICAL

CL. CURVE DATA

10
8
6
4
2
0
-2
-4
-6

LEGEND:
 (Symbol) REMOVE & REGRADE EX. WATER
 (Symbol) ADJUST EX. SAN. M.H. RIM
 TO BE FLOSH "PROPOSED" PAVEMENT

NOTES:
 1. FILL SHALL BE PLACED IN 8" LIFTS,
 2. CONTACT RICE CANNON LUTHERST ENERGY
 TO BE FLOSH "PROPOSED" PAVEMENT

10-00 11-00 12-00 13-00 14-00 15-00 17-00 19-00 20-00

DESIGNED BY: _____ DATE: _____
 DESIGN CHECKED BY: _____
 DRAWN BY: _____
 COORD. CHECKED BY: _____
 SURVEY CHECKED BY: _____
 CADD CHECKED BY: _____

10-00 11-00 12-00 13-00 14-00 15-00 17-00 19-00 20-00

20
10
8
6
4
2
0
-2
-4
-6

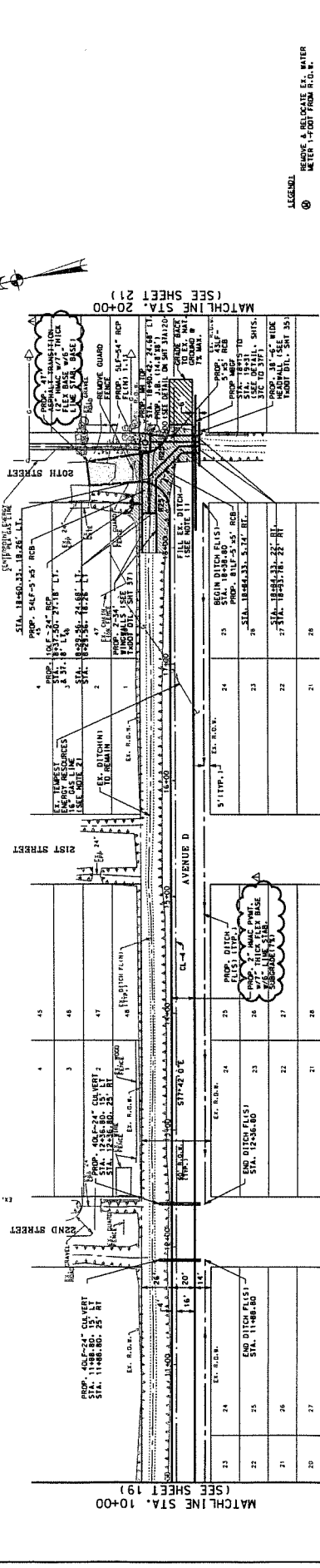

STATION	DESCRIPTION
24	END DITCH FLS 1 STA. 12+36.80
23	END DITCH FLS 1 STA. 12+36.80
22	END DITCH FLS 1 STA. 12+36.80
21	END DITCH FLS 1 STA. 12+36.80
20	END DITCH FLS 1 STA. 12+36.80
27	END DITCH FLS 1 STA. 12+36.80
26	END DITCH FLS 1 STA. 12+36.80
25	END DITCH FLS 1 STA. 12+36.80
24	END DITCH FLS 1 STA. 12+36.80
23	END DITCH FLS 1 STA. 12+36.80
22	END DITCH FLS 1 STA. 12+36.80
21	END DITCH FLS 1 STA. 12+36.80
20	END DITCH FLS 1 STA. 12+36.80

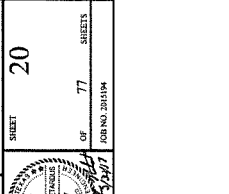

20
10
8
6
4
2
0
-2
-4
-6

10-00 11-00 12-00 13-00 14-00 15-00 17-00 19-00 20-00

DESIGNED BY: _____ DATE: _____
 DESIGN CHECKED BY: _____
 DRAWN BY: _____
 COORD. CHECKED BY: _____
 SURVEY CHECKED BY: _____
 CADD CHECKED BY: _____

20
10
8
6
4
2
0
-2
-4
-6

10-00 11-00 12-00 13-00 14-00 15-00 17-00 19-00 20-00

20
10
8
6
4
2
0
-2
-4
-6

10-00 11-00 12-00 13-00 14-00 15-00 17-00 19-00 20-00

20
10
8
6
4
2
0
-2
-4
-6

10-00 11-00 12-00 13-00 14-00 15-00 17-00 19-00 20-00

Costello

Engineering and Surveying
 9860 Katy Road, Suite 450 N
 Houston, Texas 77042
 (713) 785-7788 (713) 785-3500 Fax
 TBPE FIRM REG. No. 280
 TBPLS FIRM REG. No. 100486

San Leon Roads Reconstruction
 (14th, 15th, 16th, & Ave. D)
 PLAN AND PROFILE
 AVENUE D - STA. 10+00 TO STA. 20+00

SHEET 20

OFF 77

DATE 10/20/17

ISSUE NO. 201904

10-00 11-00 12-00 13-00 14-00 15-00 17-00 19-00 20-00

REVISIONS:
 1. REVISION NO. 1 - 11/14/14 FROM I-405 PROJECT.
 2. REVISION NO. 2 - 11/14/14 FROM I-405 PROJECT.
 3. REVISION NO. 3 - 11/14/14 FROM I-405 PROJECT.
 4. REVISION NO. 4 - 11/14/14 FROM I-405 PROJECT.
 5. REVISION NO. 5 - 11/14/14 FROM I-405 PROJECT.
 6. REVISION NO. 6 - 11/14/14 FROM I-405 PROJECT.
 7. REVISION NO. 7 - 11/14/14 FROM I-405 PROJECT.
 8. REVISION NO. 8 - 11/14/14 FROM I-405 PROJECT.
 9. REVISION NO. 9 - 11/14/14 FROM I-405 PROJECT.
 10. REVISION NO. 10 - 11/14/14 FROM I-405 PROJECT.

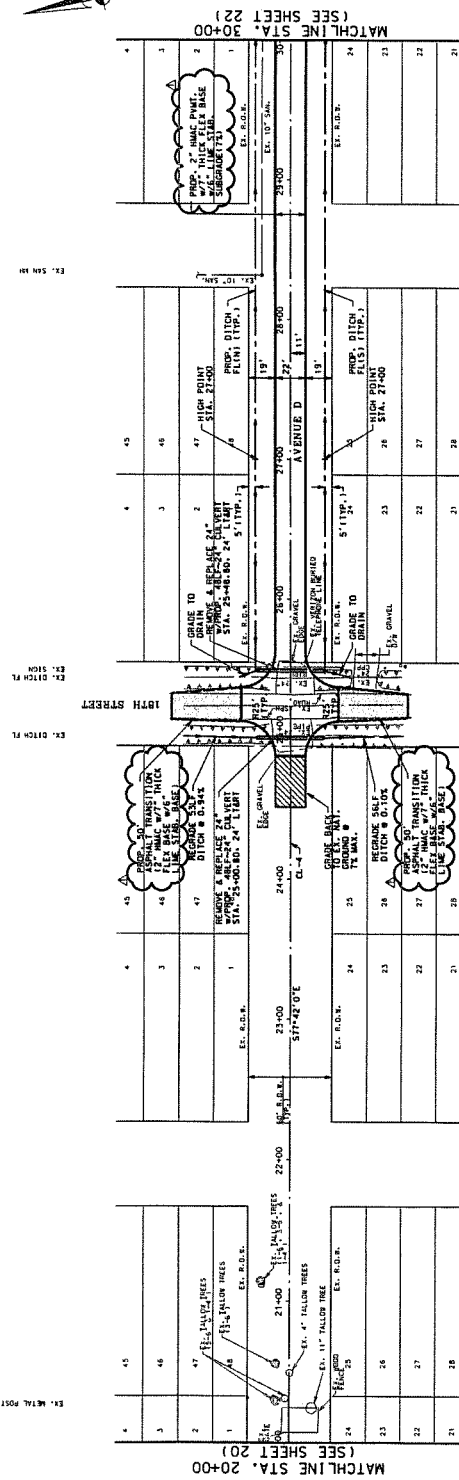

LEGEND:
 (1) REMOVE & REGRADE ETC. WATER
 (2) REMOVE & REGRADE ETC. WATER
 (3) REMOVE & REGRADE ETC. WATER
 (4) REMOVE & REGRADE ETC. WATER
 (5) REMOVE & REGRADE ETC. WATER
 (6) REMOVE & REGRADE ETC. WATER
 (7) REMOVE & REGRADE ETC. WATER
 (8) REMOVE & REGRADE ETC. WATER
 (9) REMOVE & REGRADE ETC. WATER
 (10) REMOVE & REGRADE ETC. WATER

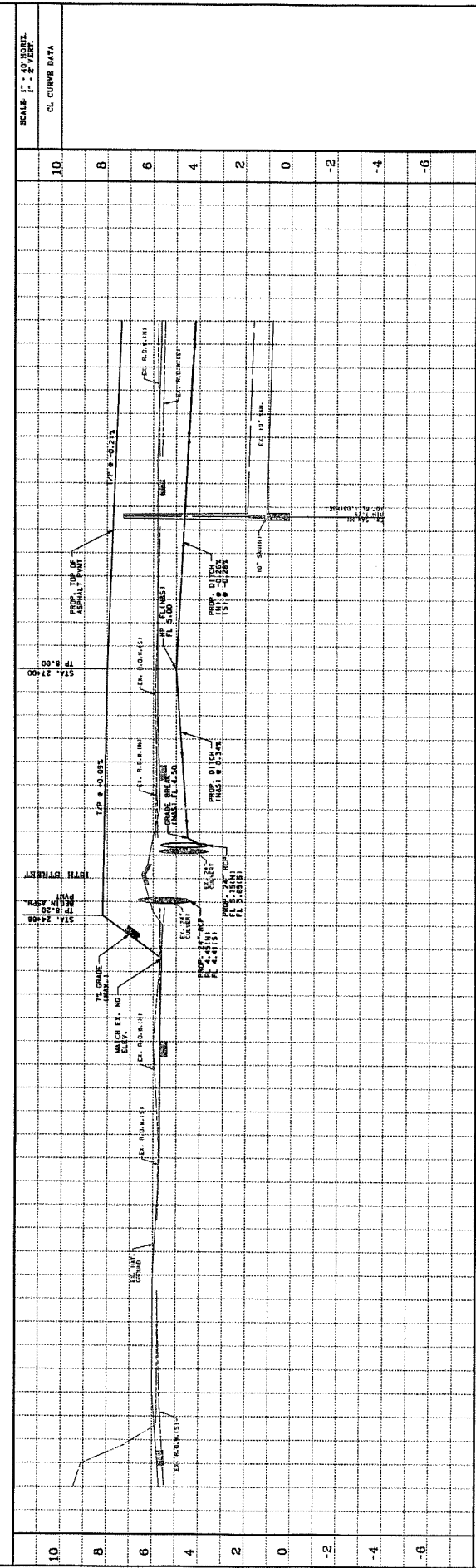

SAN LEON ROADS RECONSTRUCTION
 (14th, 15th, 16th, & AVE. D)
PLAN AND PROFILE
 AVENUE D - STA. 20+00 TO STA. 30+00

Costello

Engineering and Surveying
 6950 Richmond Avenue, Suite 450 N
 Houston, Texas 77042
 (713) 783-7788 (713) 783-3880, Fax
 TBPCE FIRM REG. NO. 280
 TBPES FIRM REG. NO. 100466

DESIGNED BY: _____ DATE: _____
 DRAWN BY: _____ DATE: _____
 CHECKED BY: _____ DATE: _____
 QUOTE BY: _____ DATE: _____
 QUOTE REVISIONS BY: _____

SCALE: 1" = 40' HORIZ.
 1" = 2' VERT.

SHEET 21
 OF 77
 SHEETS

REVISIONS
 NO. DESCRIPTION
 41 14' 1/2" R/W
 42 14' 1/2" R/W
 43 14' 1/2" R/W
 44 14' 1/2" R/W
 45 14' 1/2" R/W
 46 14' 1/2" R/W
 47 14' 1/2" R/W
 48 14' 1/2" R/W
 49 14' 1/2" R/W
 50 14' 1/2" R/W
 51 14' 1/2" R/W
 52 14' 1/2" R/W
 53 14' 1/2" R/W
 54 14' 1/2" R/W
 55 14' 1/2" R/W
 56 14' 1/2" R/W
 57 14' 1/2" R/W
 58 14' 1/2" R/W
 59 14' 1/2" R/W
 60 14' 1/2" R/W
 61 14' 1/2" R/W
 62 14' 1/2" R/W
 63 14' 1/2" R/W
 64 14' 1/2" R/W
 65 14' 1/2" R/W
 66 14' 1/2" R/W
 67 14' 1/2" R/W
 68 14' 1/2" R/W
 69 14' 1/2" R/W
 70 14' 1/2" R/W
 71 14' 1/2" R/W
 72 14' 1/2" R/W
 73 14' 1/2" R/W
 74 14' 1/2" R/W
 75 14' 1/2" R/W
 76 14' 1/2" R/W
 77 14' 1/2" R/W
 78 14' 1/2" R/W
 79 14' 1/2" R/W
 80 14' 1/2" R/W
 81 14' 1/2" R/W
 82 14' 1/2" R/W
 83 14' 1/2" R/W
 84 14' 1/2" R/W
 85 14' 1/2" R/W
 86 14' 1/2" R/W
 87 14' 1/2" R/W
 88 14' 1/2" R/W
 89 14' 1/2" R/W
 90 14' 1/2" R/W
 91 14' 1/2" R/W
 92 14' 1/2" R/W
 93 14' 1/2" R/W
 94 14' 1/2" R/W
 95 14' 1/2" R/W
 96 14' 1/2" R/W
 97 14' 1/2" R/W
 98 14' 1/2" R/W
 99 14' 1/2" R/W
 100 14' 1/2" R/W

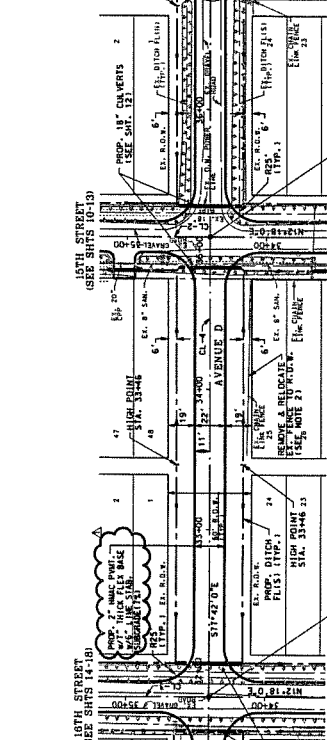
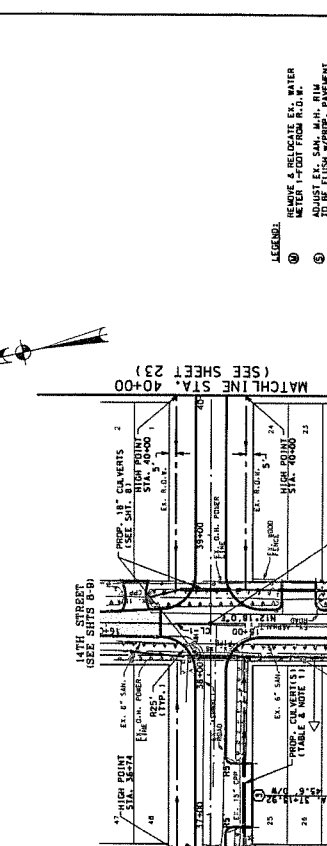

STATION	EXISTING ELEVATION	PROPOSED ELEVATION	VERTICAL CURVE DATA
31+00	3.50	3.50	
32+00	3.50	3.50	
33+00	3.50	3.50	
34+00	3.50	3.50	
35+00	3.50	3.50	
36+00	3.50	3.50	
37+00	3.50	3.50	
38+00	3.50	3.50	
39+00	3.50	3.50	
40+00	3.50	3.50	

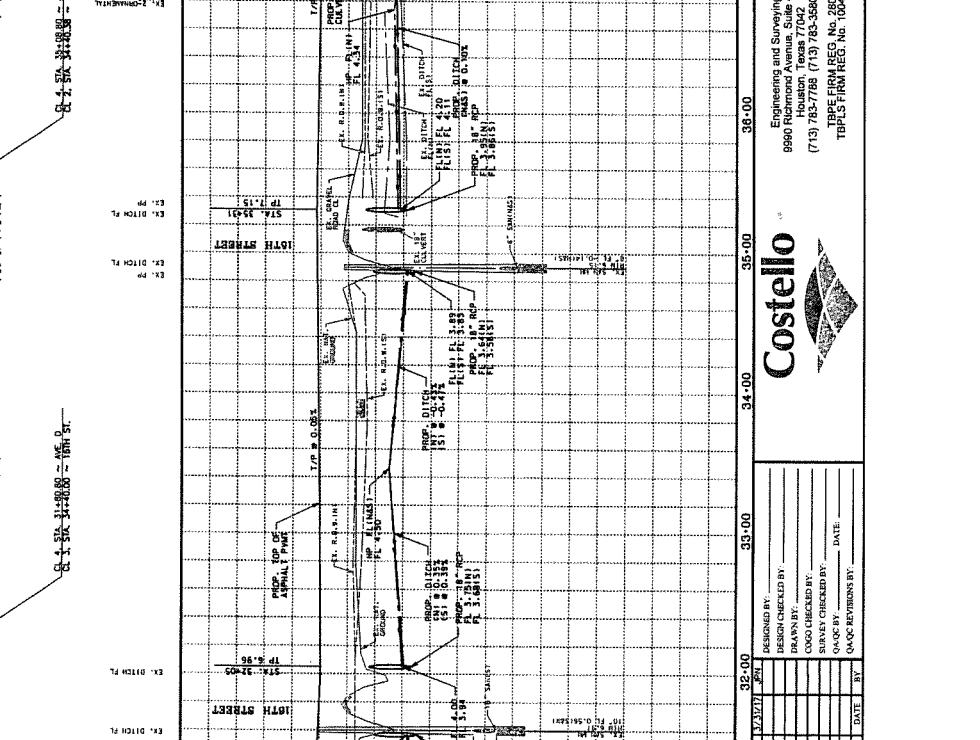
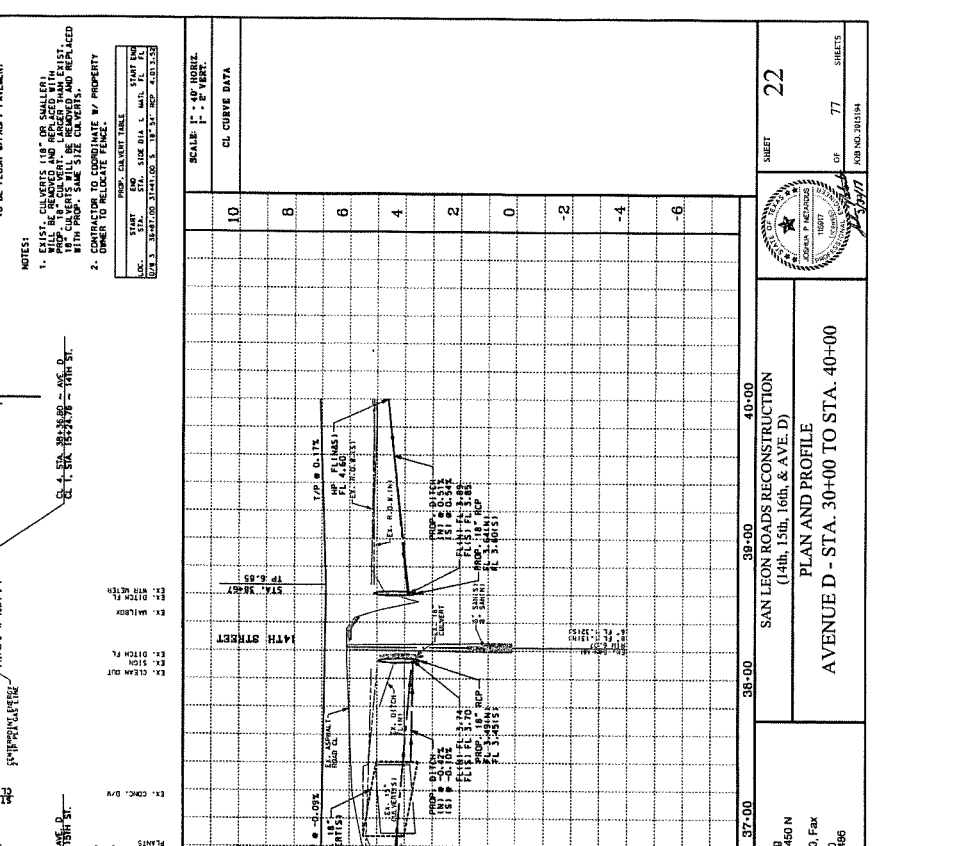

STATION	EXISTING ELEVATION	PROPOSED ELEVATION	VERTICAL CURVE DATA
31+00	3.50	3.50	
32+00	3.50	3.50	
33+00	3.50	3.50	
34+00	3.50	3.50	
35+00	3.50	3.50	
36+00	3.50	3.50	
37+00	3.50	3.50	
38+00	3.50	3.50	
39+00	3.50	3.50	
40+00	3.50	3.50	

REVISIONS
 NO. DESCRIPTION
 1 14' 1/2" R/W
 2 14' 1/2" R/W
 3 14' 1/2" R/W
 4 14' 1/2" R/W
 5 14' 1/2" R/W
 6 14' 1/2" R/W
 7 14' 1/2" R/W
 8 14' 1/2" R/W
 9 14' 1/2" R/W
 10 14' 1/2" R/W
 11 14' 1/2" R/W
 12 14' 1/2" R/W
 13 14' 1/2" R/W
 14 14' 1/2" R/W
 15 14' 1/2" R/W
 16 14' 1/2" R/W
 17 14' 1/2" R/W
 18 14' 1/2" R/W
 19 14' 1/2" R/W
 20 14' 1/2" R/W
 21 14' 1/2" R/W
 22 14' 1/2" R/W
 23 14' 1/2" R/W
 24 14' 1/2" R/W
 25 14' 1/2" R/W
 26 14' 1/2" R/W
 27 14' 1/2" R/W
 28 14' 1/2" R/W
 29 14' 1/2" R/W
 30 14' 1/2" R/W
 31 14' 1/2" R/W
 32 14' 1/2" R/W
 33 14' 1/2" R/W
 34 14' 1/2" R/W
 35 14' 1/2" R/W
 36 14' 1/2" R/W
 37 14' 1/2" R/W
 38 14' 1/2" R/W
 39 14' 1/2" R/W
 40 14' 1/2" R/W
 41 14' 1/2" R/W
 42 14' 1/2" R/W
 43 14' 1/2" R/W
 44 14' 1/2" R/W
 45 14' 1/2" R/W
 46 14' 1/2" R/W
 47 14' 1/2" R/W
 48 14' 1/2" R/W
 49 14' 1/2" R/W
 50 14' 1/2" R/W
 51 14' 1/2" R/W
 52 14' 1/2" R/W
 53 14' 1/2" R/W
 54 14' 1/2" R/W
 55 14' 1/2" R/W
 56 14' 1/2" R/W
 57 14' 1/2" R/W
 58 14' 1/2" R/W
 59 14' 1/2" R/W
 60 14' 1/2" R/W
 61 14' 1/2" R/W
 62 14' 1/2" R/W
 63 14' 1/2" R/W
 64 14' 1/2" R/W
 65 14' 1/2" R/W
 66 14' 1/2" R/W
 67 14' 1/2" R/W
 68 14' 1/2" R/W
 69 14' 1/2" R/W
 70 14' 1/2" R/W
 71 14' 1/2" R/W
 72 14' 1/2" R/W
 73 14' 1/2" R/W
 74 14' 1/2" R/W
 75 14' 1/2" R/W
 76 14' 1/2" R/W
 77 14' 1/2" R/W
 78 14' 1/2" R/W
 79 14' 1/2" R/W
 80 14' 1/2" R/W
 81 14' 1/2" R/W
 82 14' 1/2" R/W
 83 14' 1/2" R/W
 84 14' 1/2" R/W
 85 14' 1/2" R/W
 86 14' 1/2" R/W
 87 14' 1/2" R/W
 88 14' 1/2" R/W
 89 14' 1/2" R/W
 90 14' 1/2" R/W
 91 14' 1/2" R/W
 92 14' 1/2" R/W
 93 14' 1/2" R/W
 94 14' 1/2" R/W
 95 14' 1/2" R/W
 96 14' 1/2" R/W
 97 14' 1/2" R/W
 98 14' 1/2" R/W
 99 14' 1/2" R/W
 100 14' 1/2" R/W

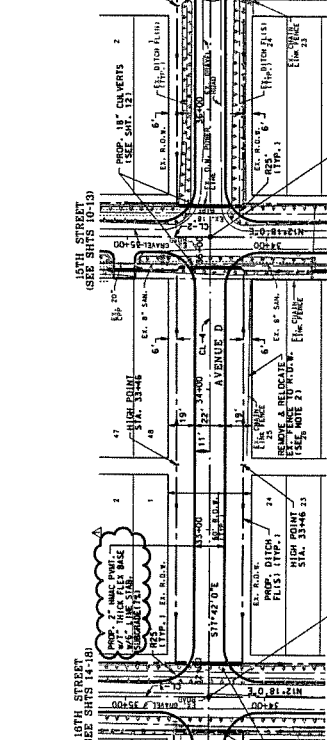
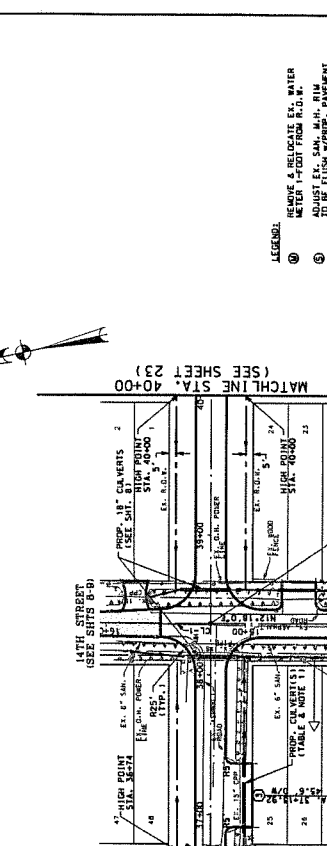

STATION	EXISTING ELEVATION	PROPOSED ELEVATION	VERTICAL CURVE DATA
31+00	3.50	3.50	
32+00	3.50	3.50	
33+00	3.50	3.50	
34+00	3.50	3.50	
35+00	3.50	3.50	
36+00	3.50	3.50	
37+00	3.50	3.50	
38+00	3.50	3.50	
39+00	3.50	3.50	
40+00	3.50	3.50	

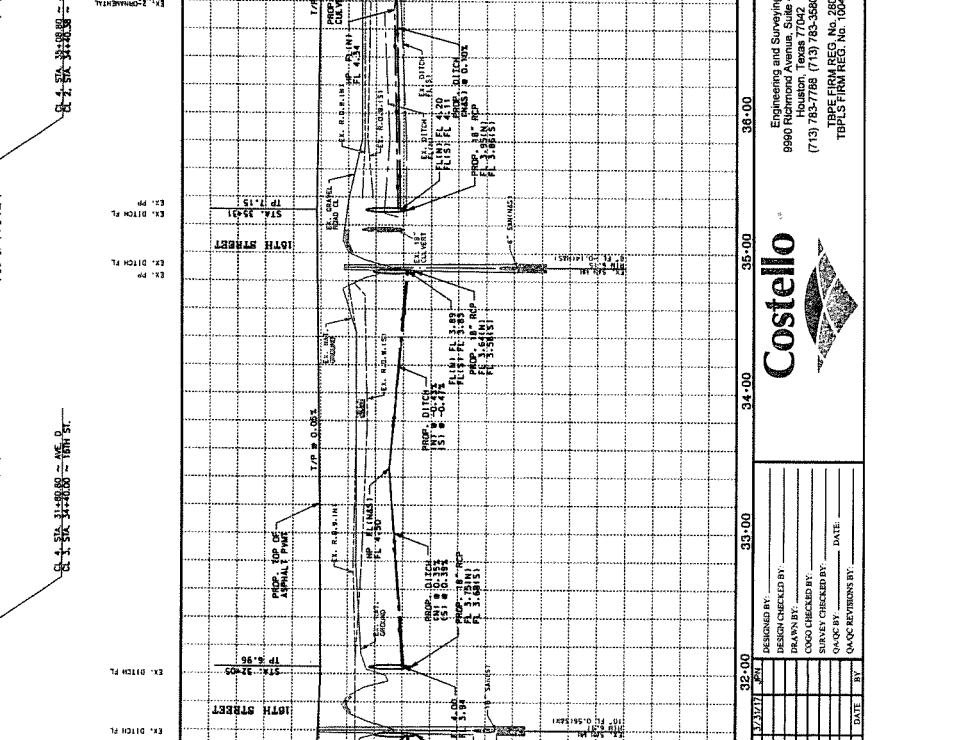
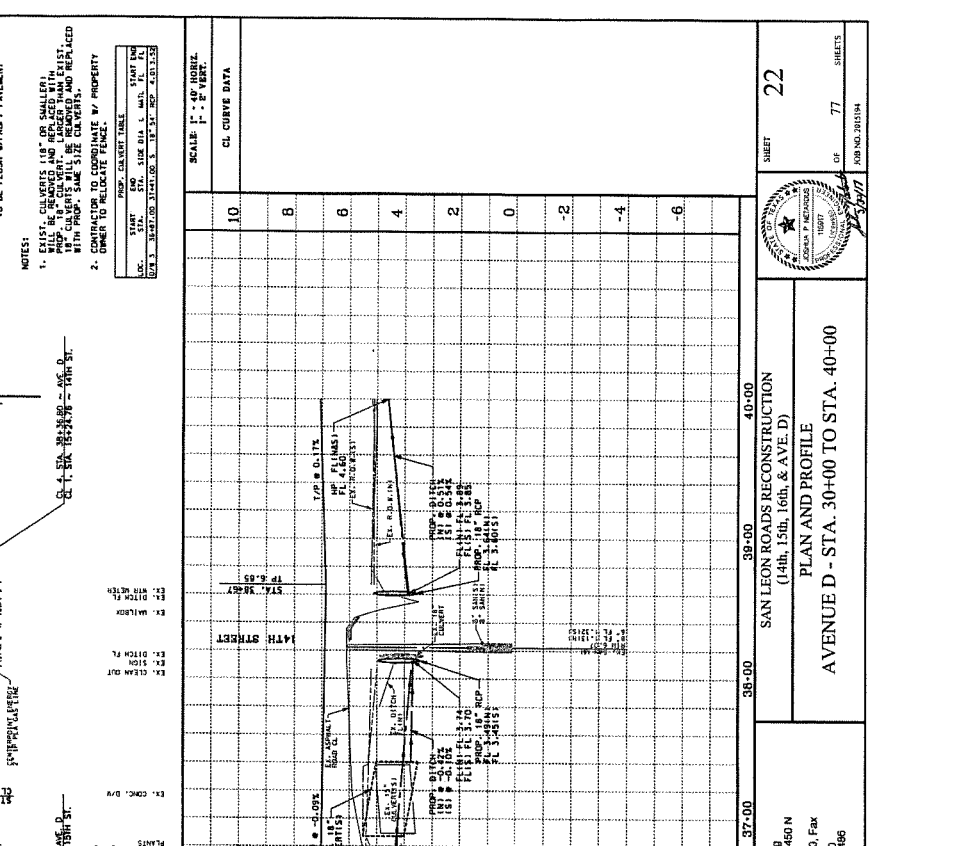

STATION	EXISTING ELEVATION	PROPOSED ELEVATION	VERTICAL CURVE DATA
31+00	3.50	3.50	
32+00	3.50	3.50	
33+00	3.50	3.50	
34+00	3.50	3.50	
35+00	3.50	3.50	
36+00	3.50	3.50	
37+00	3.50	3.50	
38+00	3.50	3.50	
39+00	3.50	3.50	
40+00	3.50	3.50	

MATCHLINE STA. 30+00 (SEE SHEET 21)
 MATCHLINE STA. 40+00 (SEE SHEET 23)

SCALE: H. = 1" = 40' HORIZ.
 V. = 1" = 5' VERT.

LEGEND:
 (Symbol) REMOVE & RELOCATE E.G. WATER
 (Symbol) ADJUST E.G. SAN. M. M. SW.
 TO BE FLUSH WITH "PROP." ANNELEMENT

NOTES:
 1. ALL CURVES TO BE CIRCULAR UNLESS OTHERWISE SHOWN.
 2. CONTRACTOR TO COORDINATE W/ PROPERTY OWNER TO RELOCATE FENCE.

PROJECT: SAN LEON ROADS RECONSTRUCTION
 (14th, 15th, 16th, & AVE. D)
 PLAN AND PROFILE
 AVENUE D - STA. 30+00 TO STA. 40+00

SHEET 22 OF 77 SHEETS
 PUB. NO. 281314

ENGINEERING AND SURVEYING
 9990 Richmond Avenue, Suite 650 N
 Houston, Texas 77042
 (713) 783-7788 (713) 783-3580 Fax
 TBP&S FIRM REG. NO. 280
 TBP&S FIRM REG. NO. 100486

Costello

DESIGNED BY: _____
 DRAWN BY: _____
 CHECKED BY: _____
 IN CHARGE: _____
 DATE: _____

REVISIONS:
 1. PER THE COMMENTS FROM THE PUBLIC PROJECT MEETING, THE DESIGN HAS BEEN REVISED TO REFLECT THE COMMENTS FROM THE PUBLIC MEETING. THE DESIGN HAS BEEN REVISED TO REFLECT THE COMMENTS FROM THE PUBLIC MEETING. THE DESIGN HAS BEEN REVISED TO REFLECT THE COMMENTS FROM THE PUBLIC MEETING.

LEGEND:
 (Symbol) REMODE & RELOCATE EX. WATER
 (Symbol) REMOVE EX. SAN. M. IN. PIPE
 (Symbol) TO BE FLUSH WITH "PAVEMENT"
 NOTES:
 1. EXIST. CURBS 18" OR SMALLER WILL BE REMOVED AND REPLACED WITH 18" CURBS. ALL CURBS WILL BE REPAIRED AND SET TO THE FINISH WITH "PAVEMENT".
 2. REP TO BOTH END OF EXISTING CURB.

LINE	START STA.	END STA.	PROP. CURB TYPE	EXIST. CURB TYPE
1	40+00	40+00	18" CONC. W/TS THICK	18" CONC. W/TS THICK
2	40+00	40+00	18" CONC. W/TS THICK	18" CONC. W/TS THICK
3	40+00	40+00	18" CONC. W/TS THICK	18" CONC. W/TS THICK
4	40+00	40+00	18" CONC. W/TS THICK	18" CONC. W/TS THICK
5	40+00	40+00	18" CONC. W/TS THICK	18" CONC. W/TS THICK
6	40+00	40+00	18" CONC. W/TS THICK	18" CONC. W/TS THICK
7	40+00	40+00	18" CONC. W/TS THICK	18" CONC. W/TS THICK
8	40+00	40+00	18" CONC. W/TS THICK	18" CONC. W/TS THICK
9	40+00	40+00	18" CONC. W/TS THICK	18" CONC. W/TS THICK
10	40+00	40+00	18" CONC. W/TS THICK	18" CONC. W/TS THICK

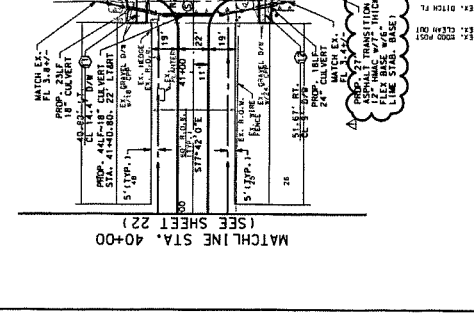
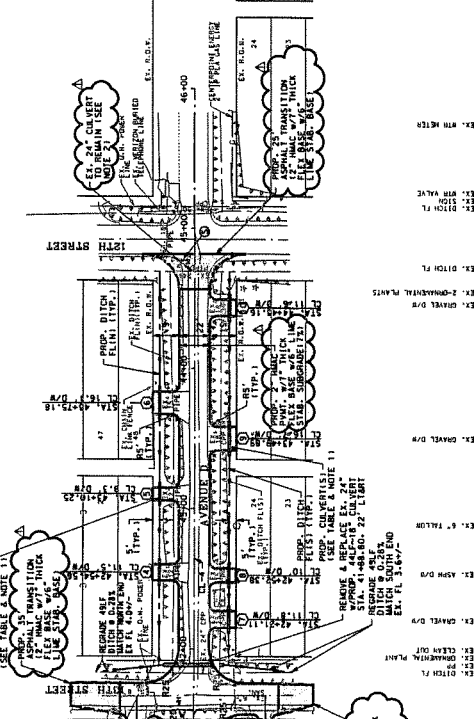

STATION	ELEVATION	DESCRIPTION
40+00	10.0	CL CURVE DATA
40+00	8.0	
40+00	6.0	
40+00	4.0	
40+00	2.0	
40+00	0.0	
40+00	-2.0	
40+00	-4.0	
40+00	-6.0	

SHEET 23
 OF 77 SHEETS
 BUREAU 201314

SAN LEON ROADS RECONSTRUCTION
 (14th, 15th, 16th, & AVE. D)
 PLAN AND PROFILE
 AVENUE D - STA. 40+00 TO STA. 46+00

Engineering and Surveying
 9990 Richmond Avenue, Suite 450 N
 Houston, Texas 77042
 (713) 783-7788 (713) 783-3880, Fax
 (713) 783-7788
 TYPE FIRM REG. NO. 280
 TBP'S FIRM REG. NO. 100486

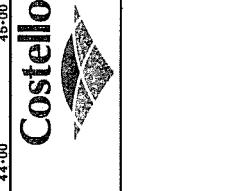

DESIGNED BY	DATE
DRAWN BY	DATE
CHECKED BY	DATE
QA/QC CHECKED BY	DATE
QA/QC REVISIONS BY	DATE

SCALE: 1" = 40' HORIZ.
1" = 4' VERT.

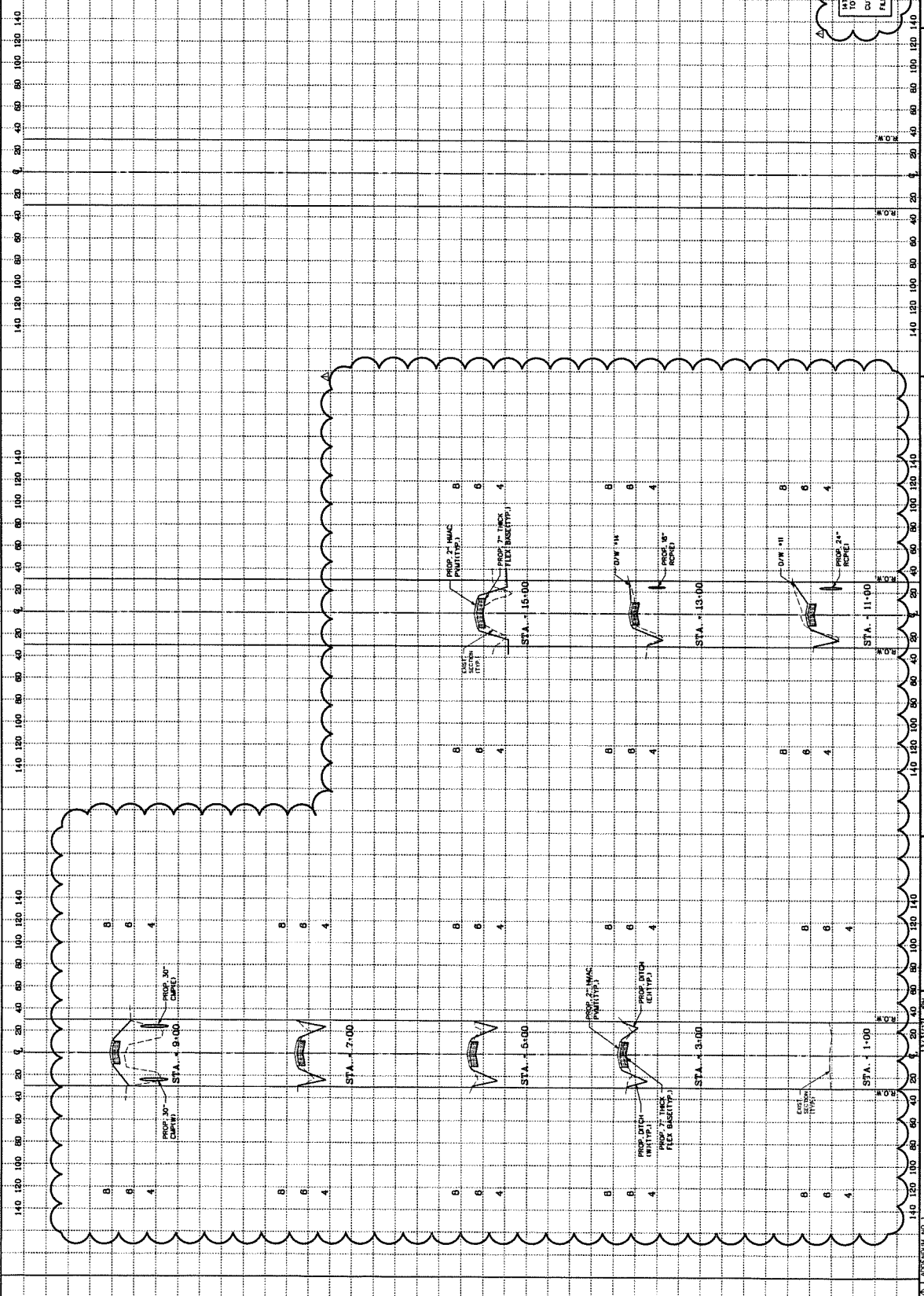

14TH STREET
TOTAL CUT/FILL VOLUME
CUT = 1034 CY
FILL = 699 CY

SHEET 24
OF 77 SHEETS
JOB NO. 2015194

GALVESTON COUNTY STREET RECONSTRUCTION
(14th, 15th, 16th, & AVE. D)
CROSS SECTIONS
14TH STREET

Costello
Engineering and Surveying 650 N
9980 Houston, Texas 77042
(713) 783-7788 (713) 783-3890 Fax
TBP&S FIRM REG. NO. 280
TBP&S FIRM REG. NO. 100485

NO.	DATE	BY
DESIGNED BY:		
DESIGN CHECKED BY:		
DRAWN BY:		
CHECKED BY:		
SURVEY CHECKED BY:		
SCALE:		
DATE:		

SCALE 1" = 40' HORIZ
1" = 4' VERT

140 120 100 80 60 40 20 0 20 40 60 80 100 120 140 140 120 100 80 60 40 20 0 20 40 60 80 100 120 140 140 120 100 80 60 40 20 0 20 40 60 80 100 120 140

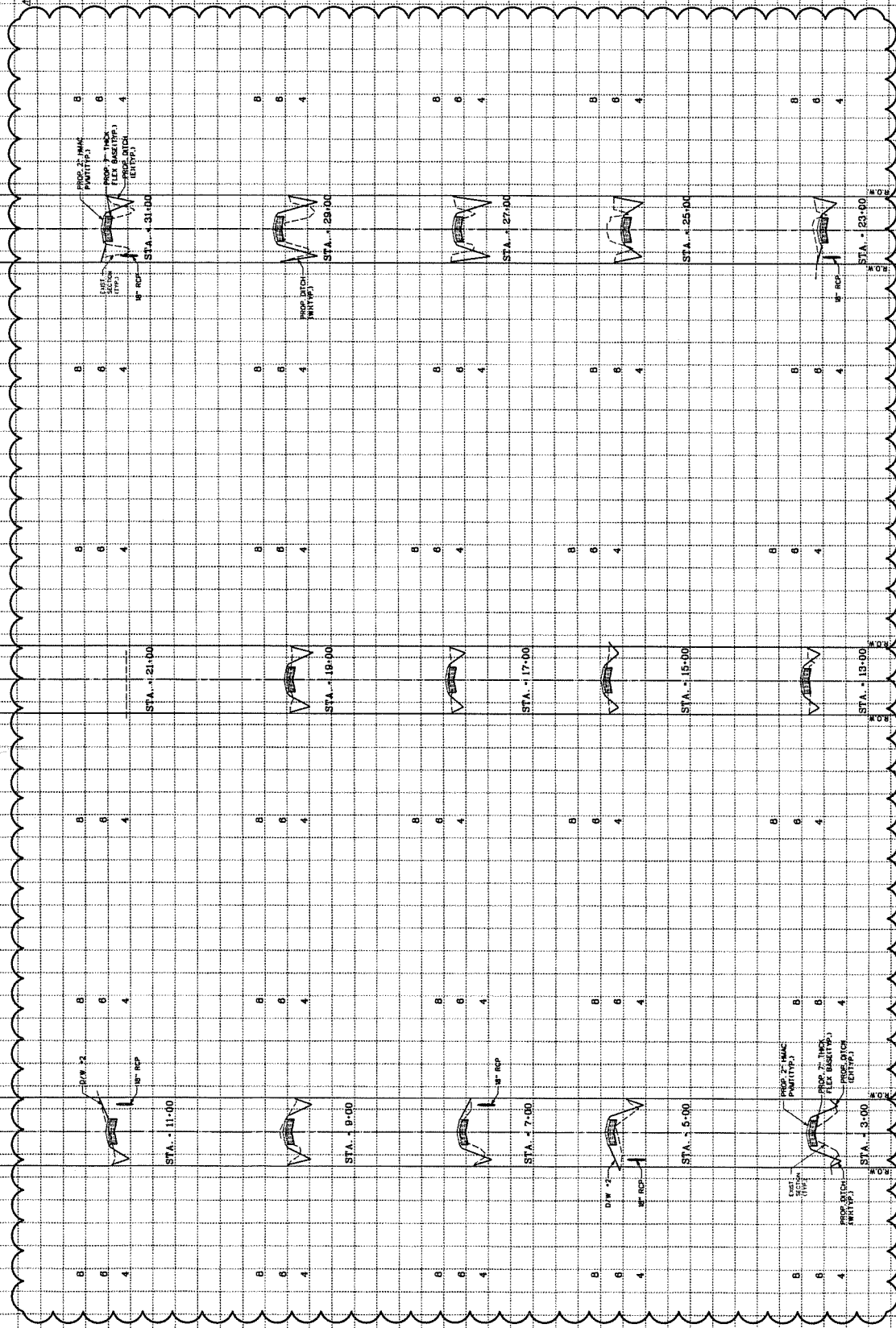

SHEET 25



CROSS SECTIONS
15TH STREET (SHT 1 OF 2)

GALVESTON COUNTY STREET RECONSTRUCTION
(14th, 15th, 16th, & AVE. D)

Engineering and Surveying
9900 Katy Road, Suite 450 N
Houston, Texas 77024
(713) 783-7788 (713) 783-3300 Fax
TBP#E FIRM REG. No. 280
TBP#S FIRM REG. No. 100486



NO.	DATE	BY	REVISION

DESIGNED BY: _____
DESIGN CHECKED BY: _____
DRAWN BY: _____
CHECKED BY: _____
SURVEY CHECKED BY: _____ DATE _____
DATE _____

DATE BY

DATE BY

DATE BY

DATE BY

DATE BY

DATE BY

DATE BY

SCALE: H=2' HORIZ. V=4' VERT.

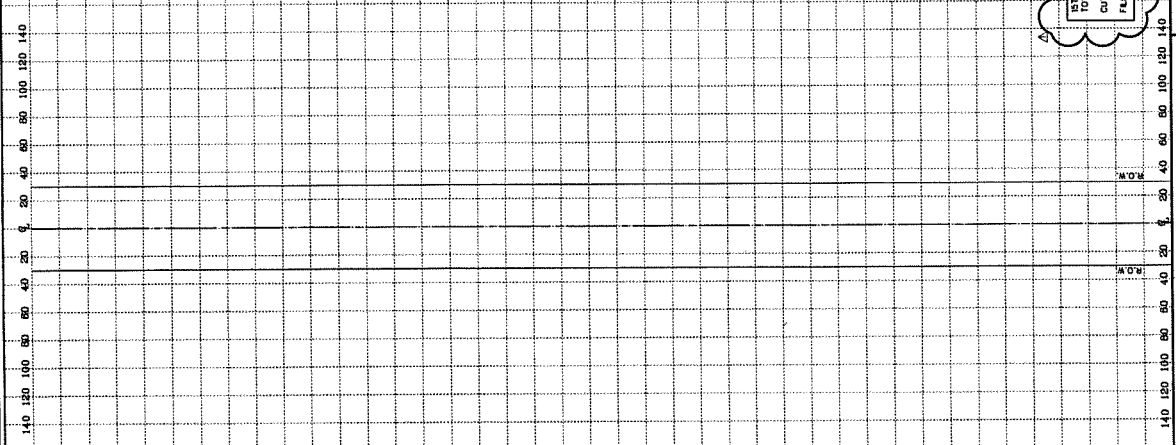

15TH STREET
TOTAL CURB/CURB VOLUME
CUT - 489 CY
FILL - 2304 CY

GALVESTON COUNTY STREET RECONSTRUCTION
(14th, 15th, 16th, & AVE. D)

CROSS SECTIONS
15TH STREET (SHT 2 OF 2)

Engineering and Surveying
8990 Richmond Avenue, Suite 450 N
Houston, Texas 77042
(713) 783-7788 (713) 783-3580, Fax
TBPE FIRM REG. No. 260
TBPLS FIRM REG. No. 106468

Costello

DESIGNED BY: _____
DRAWN BY: _____
CHECKED BY: _____
DATE: _____

DATE: _____
BY: _____
REVISION: _____

SCALE
 1" = 4' VERT

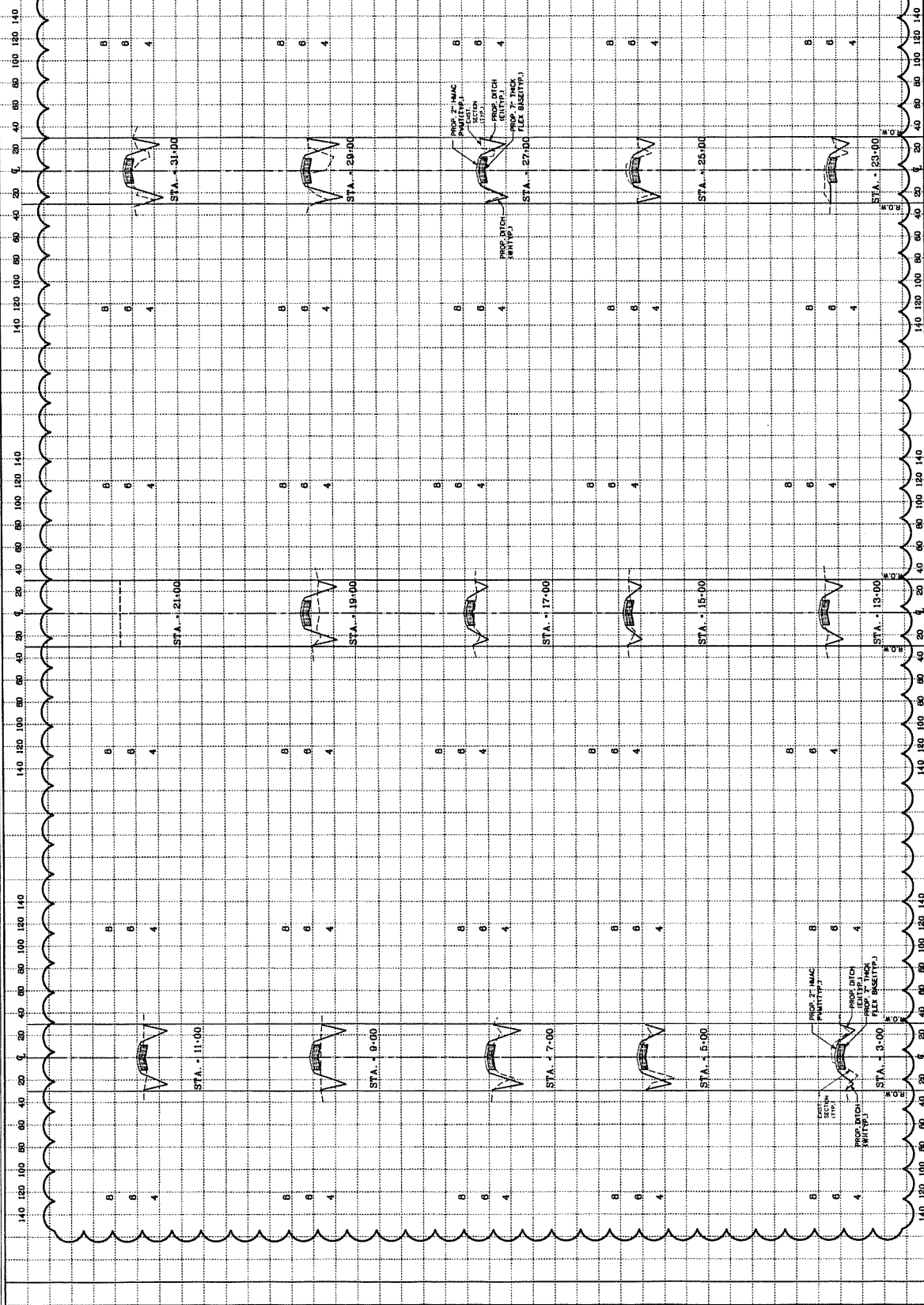

SHEET 27



GALVESTON COUNTY STREET RECONSTRUCTION
 (14th, 15th, 16th, & AVE. D)
 CROSS SECTIONS
 16TH STREET (SHT 1 OF 2)

Engineering and Surveying
 9900 Riverchase Lane, Suite 450 N
 Houston, Texas 77042
 (713) 783-7788 (713) 783-5580, Fax
 TBP&S FIRM REG. NO. 280
 TBP&S FIRM REG. NO. 100486



NO.	REVISION	DATE	BY

DESIGNED BY: _____	DATE: _____
DRAWN BY: _____	
CHECKED BY: _____	
QA/QC BY: _____	

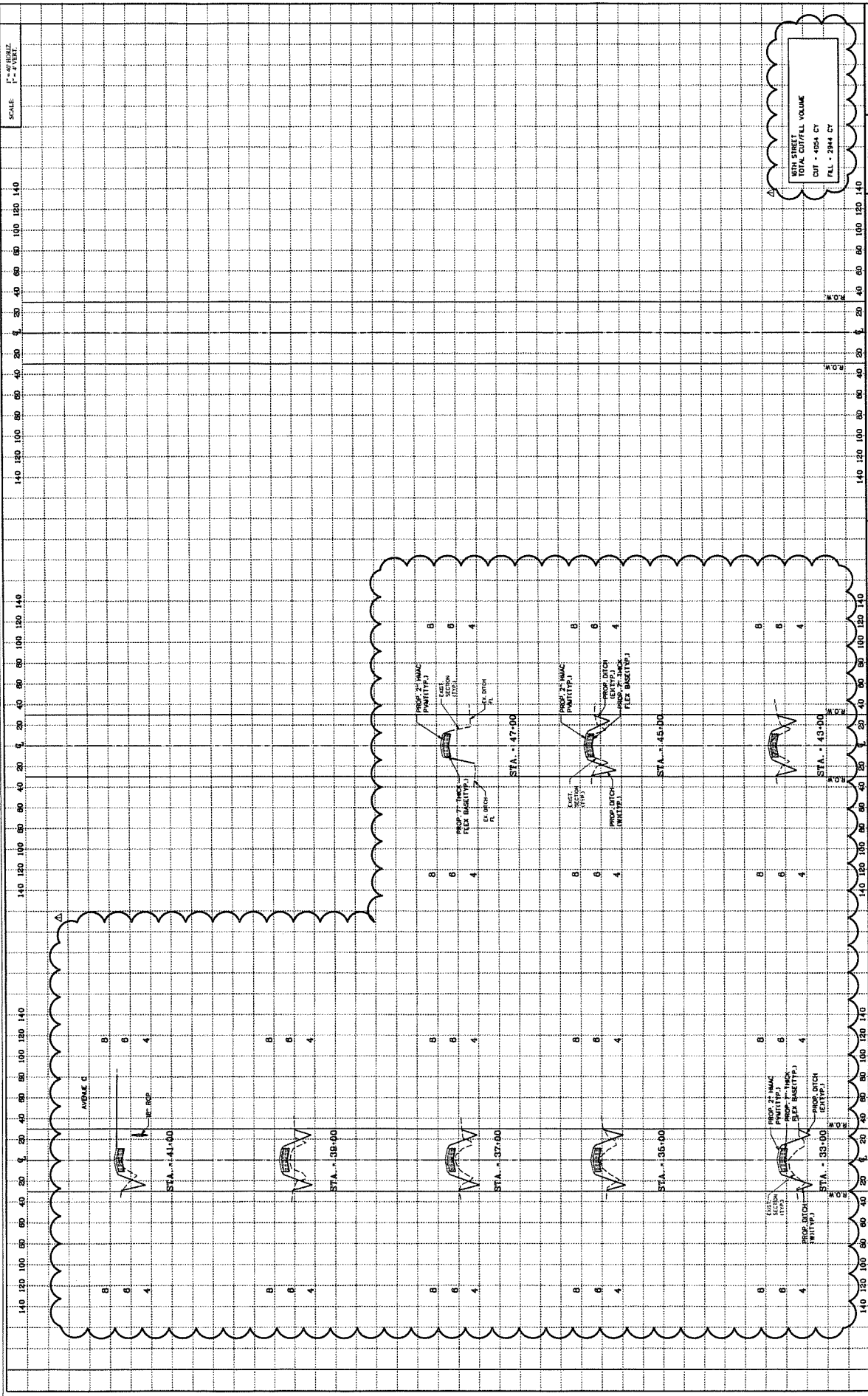

SCALE
 1" = 4' VERTICAL
 1" = 40' HORIZONTAL

16TH STREET
 TOTAL CUT/FILL VOLUME
 CUT = 4254 CY
 FILL = 2844 CY



SHEET 28
 OF 77 SHEETS
 DATE 10/17/11

GALVESTON COUNTY STREET RECONSTRUCTION
 (14th, 15th, 16th, & AVE. D)
 CROSS SECTIONS
 16TH STREET (SHT 2 OF 2)

Engineering and Surveying
 9990 Richmond Avenue, Suite 450 N
 (713) 783-7788 (713) 783-3880, Fax
 TBM'S FIRM REG. No. 280
 TBM'S FIRM REG. No. 100496



DESIGNED BY	_____
DRAWN BY	_____
CHECKED BY	_____
SURVEY CHECKED BY	_____
DATE	_____

NO.	REVISION	DATE	BY

SCALE: 1" = 4' VERT.

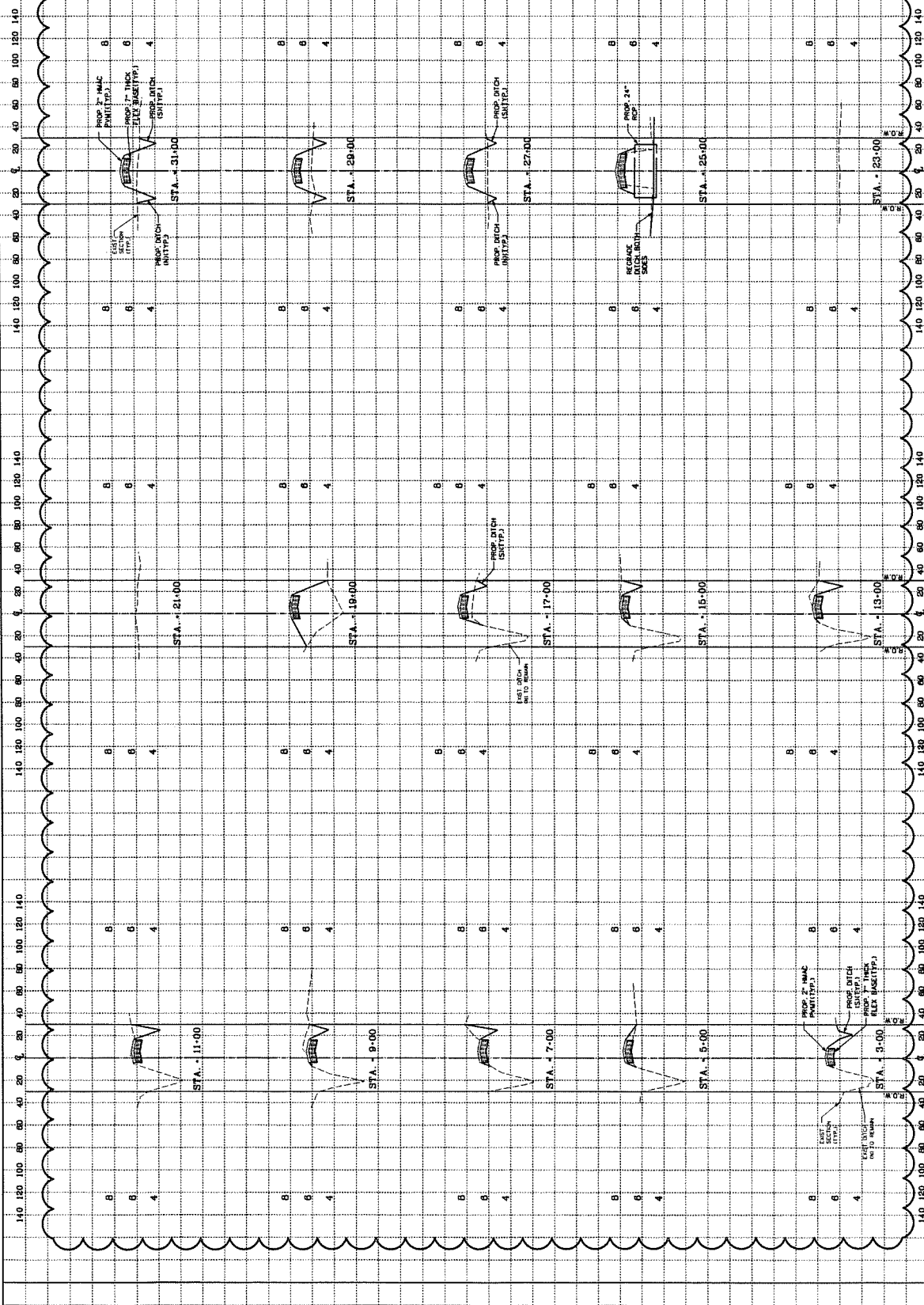

29



GALVESTON COUNTY STREET RECONSTRUCTION
(14th, 15th, 16th, & AVE. D)

CROSS SECTIONS
AVENUE D (SHT 1 OF 2)

Engineering and Surveying
9860 West Loop South, Suite 400 N
Houston, Texas 77042
(713) 783-7788 (713) 783-5580, Fax
TBP&S FIRM REG. NO. 280
TBP&S FIRM REG. NO. 100466



NO.	REVISION	DATE	BY

DESIGNED BY: _____
 DESIGN CHECKED BY: _____
 DRAWN BY: _____
 SURVEY CHECKED BY: _____
 QUOTE BY: _____ DATE: _____
 QUOTE REVISIONS BY: _____

SCALE: 1" = 40' HORIZ
1" = 4' VERT

140 120 100 80 60 40 20 0 20 40 60 80 100 120 140

140 120 100 80 60 40 20 0 20 40 60 80 100 120 140

140 120 100 80 60 40 20 0 20 40 60 80 100 120 140

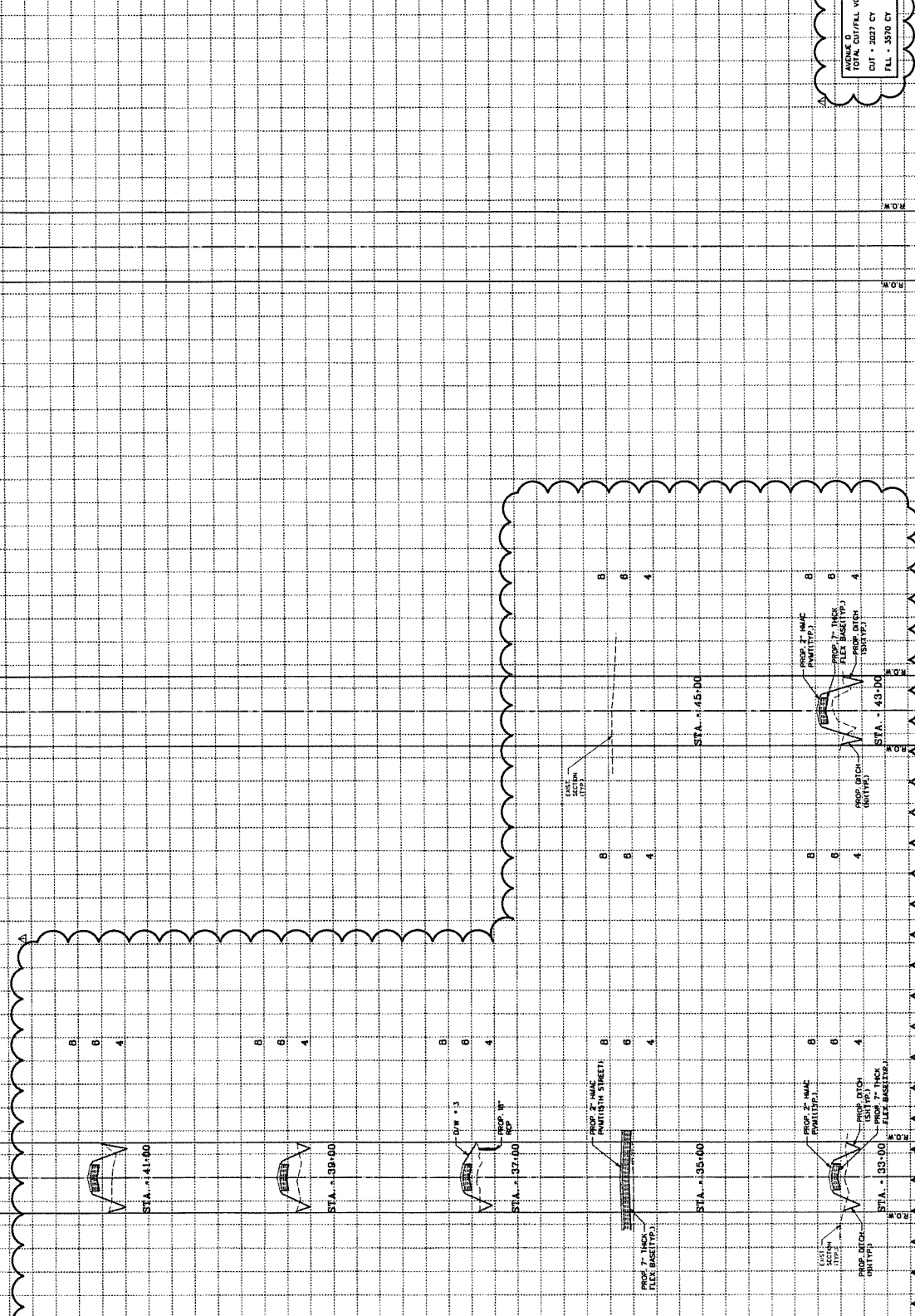

AVENUE D
TOTAL CUT/FILL VOLUME
CUT - 2027 CY
FILL - 3570 CY

SHEET 30



GALVESTON COUNTY STREET RECONSTRUCTION
(14th, 15th, 16th, & AVE. D)

CROSS SECTIONS
AVENUE D (SHT 2 OF 2)

Engineering and Surveying
9900 Foothill
Houston, Texas 77042
(713) 783-7788 (713) 783-3580 Fax
TBPPE FIRM REG. NO. 280
TBPPLS FIRM REG. NO. 100486



DESIGNED BY:	DATE:
DRAWN BY:	DATE:
CHECKED BY:	DATE:
QUANTITY CHECKED BY:	DATE:
QUALITY CHECKED BY:	DATE:

NO.	REVISION	DATE	BY