

RULES, REGULATIONS AND REQUIREMENTS FOR PROPOSED CONSTRUCTION PROJECTS ON GALVESTON COUNTY PROPERTY

All permits hereafter granted to place water, sewer, gas or oil lines; conduits or other projects within the rights-of-way or easements of, or crossings of Galveston County roads, ditches, canals, etc., in Galveston County shall be subject to the following:

1. Where pipelines cross roads or drainage ditches, the top of the pipe or conduit shall be placed not less than 36 inches below the bottom of the ditch.
2. Where pipelines or conduits cross under surfaced roads or under surfaced cross roads within the right-of-way, the pipelines or conduits shall be placed by boring. Boring shall extend from crown line to crown line. All lines under highways carrying pressure shall be enclosed in satisfactory casing extending from the right-of-way line to right-of-way line. Gravity flow sewer lines under highways shall be cast iron pipe.
3. Where evidence is presented indicating the impracticability of boring or tunneling, the County Engineer of Galveston County may grant permission to cut the surfacing. In the event a cut is permitted the following conditions will govern:
 - a. Backfill material: All backfill material shall be stabilized with Portland Cement and mixed in a concrete mixer or transit mix equipment. If soil is used, it shall be sandy material free from lumps or clods and shall be stabilized with two sacks of cement per cubic yard of soil. If sand and gravel are used, pit run material will be allowed, and it shall be stabilized with one sack of cement per cubic yard. Backfill may be mechanically tamped in a moist condition or water added to provide a free-flowing mixture.
 - b. Where pavement is flexible base and asphalt surface – see sketch.
 - c. Where pavement is concrete or concrete base with other surface – see sketch.
4. Boring shall be done by machinery method only. No water jetting will be permitted nor will use of water in quantity required to wash cuttings from hole be permitted. Grantee agrees to take all necessary steps to protect the traveling public from danger to traffic which may be caused directly or indirectly by his operations. BY HIS ACCEPTANCE OF THE PERMIT AND EXECUTION OF OPERATIONS PERMITTED THEREBY, GRANTEE ACKNOWLEDGES ASSUMPTION OF ENTIRE RESPONSIBILITY FOR ANY DAMAGE WHICH MAY OCCUR TO GALVESTON COUNTY PROPERTY CAUSED BY SUCH OPERATIONS AND AGREES TO INDEMNIFY THE COUNTY OF GALVESTON IN FULL FOR SUCH DAMAGES.
5. All excavations within the right-of-way and not under surfacing shall be backfilled by tamping in 6" horizontal layers or by ponding. All surplus material shall be removed from the right-of-way and the excavation finished flush with surrounding natural ground.

6. Where pipe of conduit is laid along a road, it shall be laid preferably near the road right-of-way line, but in any event, as far from the running surface of the road as practicable and in such a manner as not to unduly interfere with traffic on roads, or private access to roads or drainage along any street, alley, highway or road. All backfill shall be thoroughly tamped or otherwise compacted. All road surfaces, road ditches, drainage ditches, private accesses and areas contiguous thereto shall be replaced or cleaned and left in a good a condition as before pipe or conduit was laid.
7. Any later undue maintenance occasioned by the pipeline or conduit construction shall be borne by the grantee of permit.
8. Whenever said pipe of conduit shall interfere with the improvement of, or widening of, or future construction, or repair of any street, alley, highway, ditch or road, grantees shall lower or remove their pipeline upon Order of the Commissioners Court of Galveston County, Texas at grantee's expense.
9. Location of pipeline and conduits shall be marked with suitable markers where they cross roads or drainage ditches.
10. All work on the roadway right-of-way shall be marked with suitable markers where they cross roads or drainage ditches.
11. Operations along County roads or highways shall be performed in such a manner that all excavated material and all operation equipment shall be kept off the pavements at all times.
12. Barricades, warning signs and flagmen, when necessary, shall be provided by the contractor or owner.
13. One half of the traveled portion of the road must be open to traffic at all times.
14. IN THE EVENT OF FAILURE OF THE GRANTEE TO COMPLY WITH THE PROVISIONS OF THE PROCEEDING PARAGRAPHS, the same may be done by the County of Galveston at the expense of the said grantee and a certificate of the County Engineer as to the amount of such cost and expense shall be conclusive and bind on said grantee.
15. The grantee agrees to indemnify and save harmless Galveston County from any and all loss, damage, cost of expense or any other things that may be to it occasioned by reason of any act or acts of grantee, or failure of grantee to do or to perform any act or thing required to be done or performed by said grantee in the exercise of the right, power and privilege herein granted and any use of such.
16. An Indemnity Bond (the amount to be set by Commissioners Court) shall be made payable to the County Judge of Galveston County and hiss successors in office with a surety company (authorized to do business in the State of Texas, and such surety company to be approved by the Commissioners Court of Galveston County, Texas) and the Bond shall be on file with the County prior to commencing any of the work authorized by this Permit.

17. In lieu of the above Bond, the Commissioners Court may, in its discretion, require the owner to furnish the Court with a signed copy of a Performance Bond executed by a surety company authorized to do business in Texas with an agency or home office in Galveston County, together with a copy of the contract upon which said Bond is written.
18. The County Engineer must be notified at least 48 hours prior to starting construction.
19. The County Engineer, at his discretion, will make inspection and/or assign a representative to make inspections, in order to ascertain that all phases of the work are being accomplished under the terms of the Permit.
20. All forms necessary for making Application for a permit are attached. Additional forms may be secured from the County Engineer.

Upon Motion of Commissioner Vacek, seconded by Commissioner Hopkins and carried; the forgoing "RULES, REGULATIONS AND REQUIREMENTS FOR PROPOSED CONSTRUCTION PROJECTS ON GALVESTON COUNTY PROPERTY" are approved and adopted, effective today, April 22, 1963. The same shall supersede all existing Rules, Regulations and Requirements heretofore passed by the Commissioners Court.

The above Rules, Regulations and Requirements are recorded in Volume 31, Page 501, of the Commissioners Court minutes.

8 1/2" scale

SAMPLE SKETCH

FOR PIPE LINE ALONG HIGHWAY GALVESTON COUNTY, TEXAS

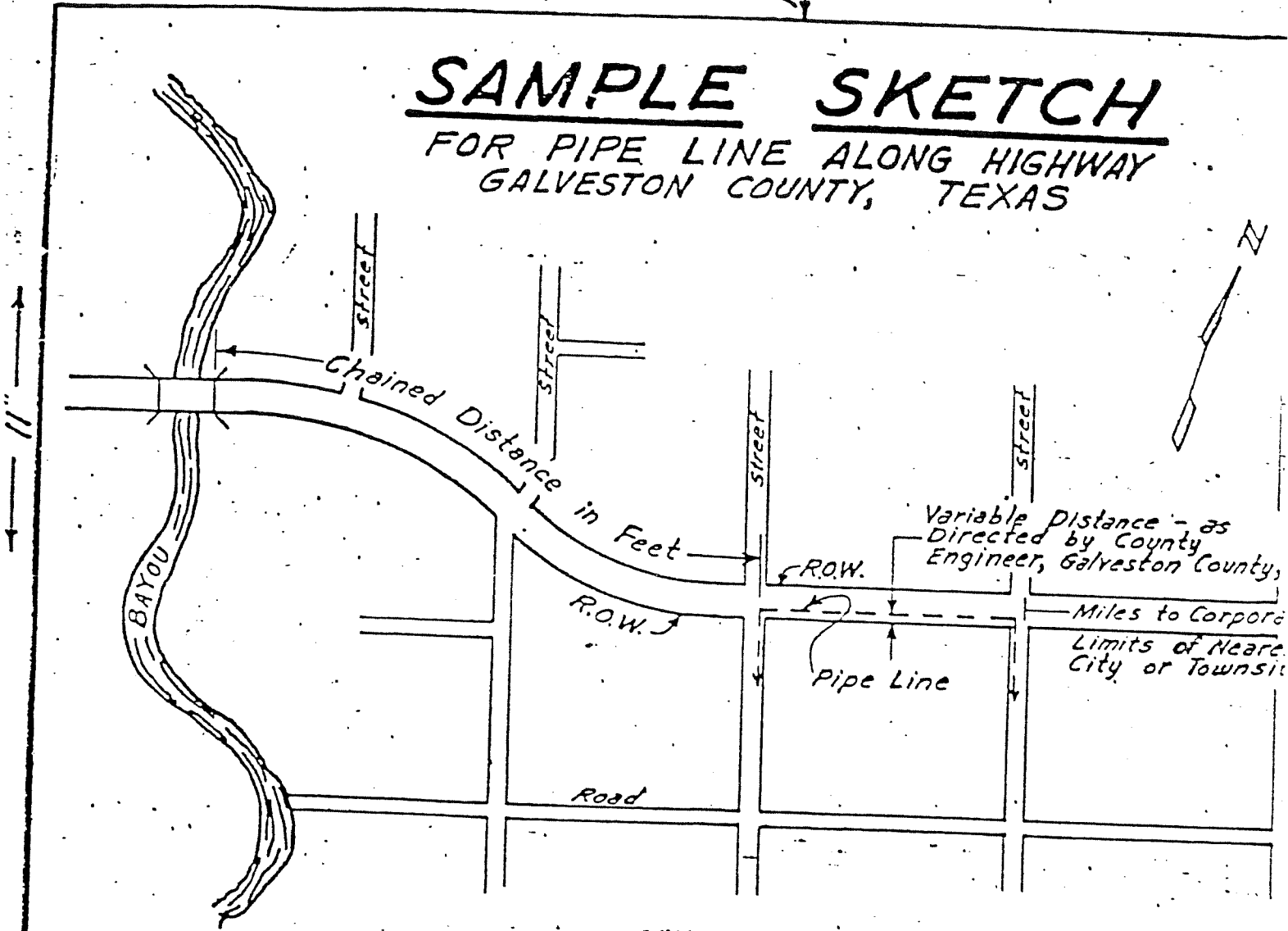

NOTE: Give Chained Distance from Line to End of Bridge, End of Culverts with Headwalls, Center-Line of Underpass, or Center-Line of Intersecting Highways.

CROSS SECTION

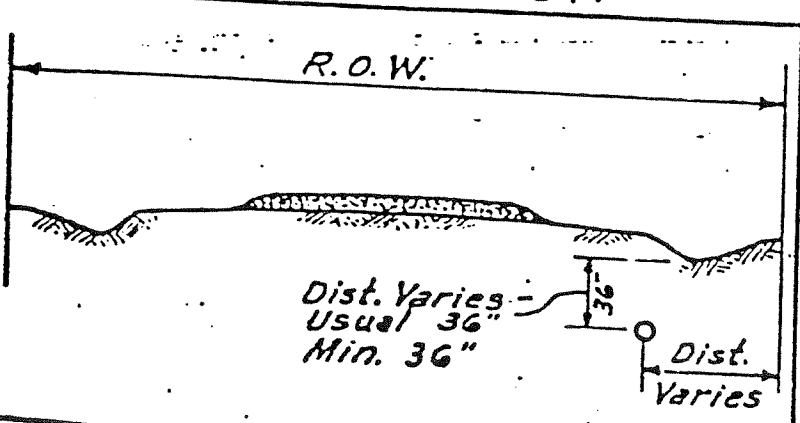

COMPANY DATA

No Scale	Date:

(b) WHERE PAVEMENT IS FLEXIBLE BASE AND ASPHALT SURFACE : (also see Spec. Sheet)

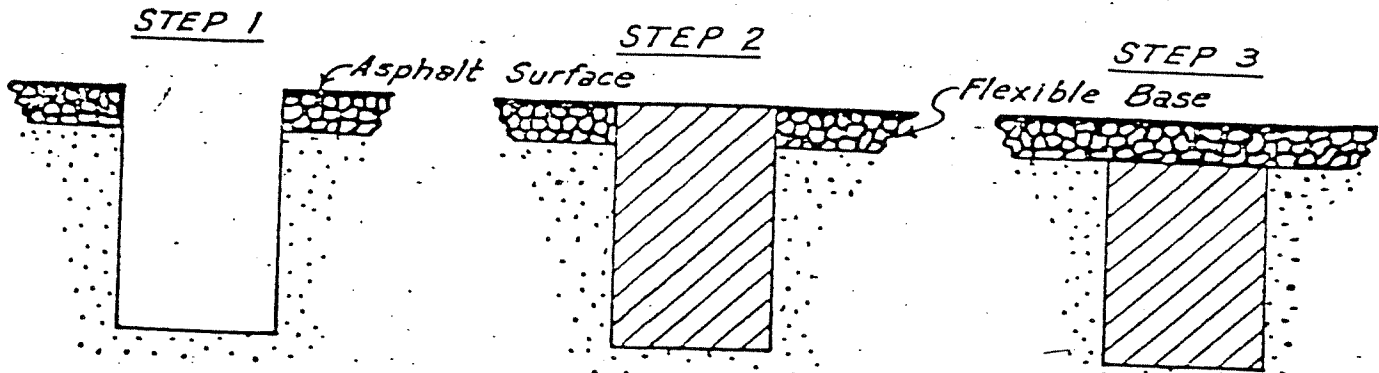

Open Trench to Minimum Width Necessary.

Backfill Trench to Surface Level, Pending Placing of Base and Surface.

Remove Surplus Backfill, Place Base and Surface Same as or Equal to Original Base and Surface.

(c) WHERE PAVEMENT IS CONCRETE OR CONCRETE BASE WITH OTHER SURFACE : (also see Spec. Sheet)

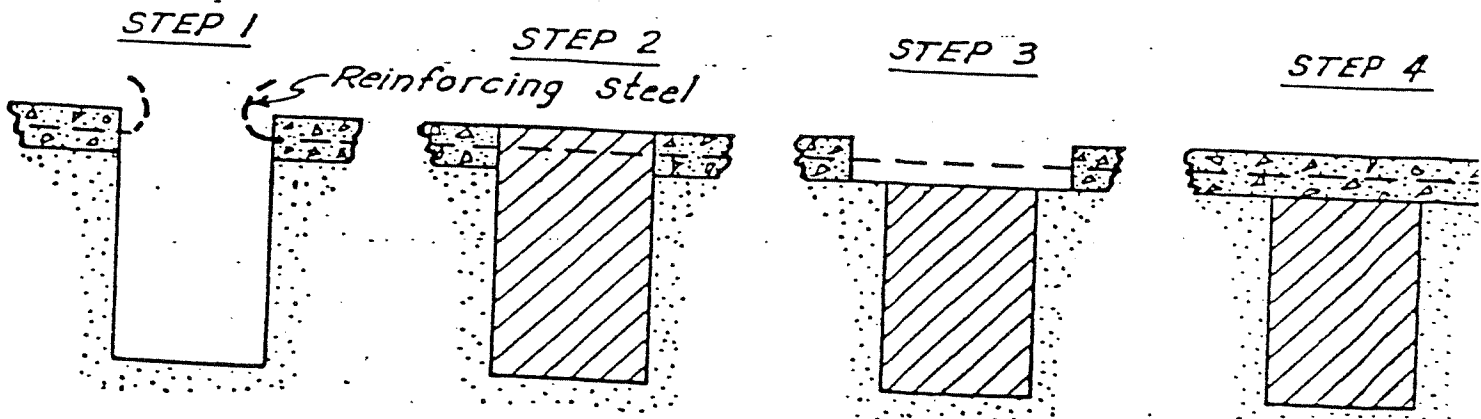

Open Trench to Minimum Width Necessary. Cut Steel Bars on Alternate Sides.

Backfill Trench to Surface Level Pending Placing of Concrete.

Remove Surplus Backfill. Remove an Extra 1 FT. Strip of Concrete on Each Side.

Place 5 Sack Concrete Patch. Keep Wet and Barricaded for 48 Hours.