



## THE COUNTY OF GALVESTON

RUFUS G. CROWDER, CPPO, CPPB  
PURCHASING AGENT

COUNTY COURTHOUSE  
722 Moody (21<sup>st</sup> Street)  
Fifth (5<sup>th</sup>) Floor  
GALVESTON, TEXAS 77550

October 5, 2023

**PROJECT NAME:** Demolition & Remediation for Mental Health Crisis Center

**SOLICITATION NO:** RFP #B231034

**RE:** ADDENDUM #1

To All Prospective Proposers:

The following information is being provided to aid in the preparation of your RFP submittal(s):

### **Attachments:**

- Attached you will find the Wage Rates for RFP #B231034, Demolition & Remediation for Mental Health Crisis Center which were omitted from the original bid packet.
- Mold Survey Report
- Asbestos Removal Specifications and Survey, including Analysis Report
- BuildingPlans

**Question #1:** *Are there as built drawings available for us to use or a link to them. I see nothing in the docs.*

Response: Attached you will find the requested information

**Question #2:** *Is there an Environmental Consultant who has performed an Asbestos Survey and a Mold Survey. Per TDSHS Asbestos Regulations and TDLR Mold Regulations this has to be performed independently of the contractor. I see nothing in the docs.*

Response: Attached you will find the requested information.

**Question #3:** *They will produce ACM survey, Mold survey, locations of ACM and Mold produce drawings and Mold Protocols for proposal purposes.*

Response: Attached you will find the requested information

**Question #4:** *When and were the plans for this Project would be available.*

Response: Attached you will find the requested information.

**Question #5:** *Do all of the site lights work for protection of storage materials, safety, etc.?*

**Response:** We are unsure as to the extents of operational site lighting and we will visit in review with civil for new parking needs. Regarding demolition we will show staging area and fenced in area to the south of building in parking area.

If you have any further questions regarding this bid, please address them to the representative listed below, via e-mail at [purchasing.bids@co.galveston.tx.us](mailto:purchasing.bids@co.galveston.tx.us), or contact the Purchasing Department at (409) 770-5371.

Rufus G. Crowder, CPPO CPPB  
Galveston County Purchasing Agent  
722 Moody, Fifth (5<sup>th</sup>) Floor  
Galveston, Texas 77550  
E-mail: [purchasing.bids@co.galveston.tx.us](mailto:purchasing.bids@co.galveston.tx.us)

Please excuse us for any inconvenience that this may have caused.

Sincerely,

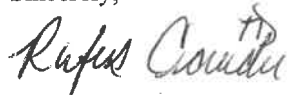

Rufus G. Crowder, CPPO CPPB  
Purchasing Agent  
Galveston County

"General Decision Number: TX20230248 09/01/2023

Superseded General Decision Number: TX20220248

State: Texas

Construction Type: Building

County: Galveston County in Texas.

BUILDING CONSTRUCTION PROJECTS (does not include single family homes or apartments up to and including 4 stories).

Note: Contracts subject to the Davis-Bacon Act are generally required to pay at least the applicable minimum wage rate required under Executive Order 14026 or Executive Order 13658. Please note that these Executive Orders apply to covered contracts entered into by the federal government that are subject to the Davis-Bacon Act itself, but do not apply to contracts subject only to the Davis-Bacon Related Acts, including those set forth at 29 CFR 5.1(a)(2)-(60).

<p>If the contract is entered into on or after January 30, 2022, or the contract is renewed or extended (e.g., an option is exercised) on or after January 30, 2022:</p>	<ul style="list-style-type: none"> <li>. Executive Order 14026 generally applies to the contract.</li> <li>. The contractor must pay all covered workers at least \$16.20 per hour (or the applicable wage rate listed on this wage determination, if it is higher) for all hours spent performing on the contract in 2023.</li> </ul>
<p>If the contract was awarded on or between January 1, 2015 and January 29, 2022, and the contract is not renewed or extended on or after January 30, 2022:</p>	<ul style="list-style-type: none"> <li>. Executive Order 13658 generally applies to the contract.</li> <li>. The contractor must pay all covered workers at least \$12.15 per hour (or the applicable wage rate listed on this wage determination, if it is higher) for all hours spent performing on that contract in 2023.</li> </ul>

The applicable Executive Order minimum wage rate will be adjusted annually. If this contract is covered by one of the Executive Orders and a classification considered necessary for performance of work on the contract does not appear on this wage determination, the contractor must still submit a conformance request.

Additional information on contractor requirements and worker protections under the Executive Orders is available at <http://www.dol.gov/whd/govcontracts>.

Modification Number	Publication Date
0	01/06/2023
1	01/13/2023

2	05/05/2023
3	08/25/2023
4	09/01/2023

ASBE0022-009 07/03/2023

Rates	Fringes
-------	---------

ASBESTOS WORKER/HEAT & FROST  
 INSULATOR (Duct, Pipe and  
 Mechanical System Insulation)....\$ 28.35                      16.02

BOIL0074-003 01/01/2021

Rates	Fringes
-------	---------

BOILERMAKER.....\$ 29.47                      24.10

CARP0551-011 04/01/2021

Rates	Fringes
-------	---------

CARPENTER (Excludes  
 Acoustical Ceiling  
 Installation, Drywall  
 Finishing/Taping, Drywall  
 Hanging, Form Work and Metal  
 Stud Installation).....\$ 25.86                      9.08

ELEC0527-002 10/31/2022

Rates	Fringes
-------	---------

ELECTRICIAN (Excludes Low  
 Voltage Wiring and  
 Installation of Alarms).....\$ 31.18                      12.84

ELEV0031-003 01/01/2023

Rates	Fringes
-------	---------

ELEVATOR MECHANIC.....\$ 49.15                      37.335+a+b

FOOTNOTES:

A. 6% under 5 years based on regular hourly rate for all hours worked. 8% over 5 years based on regular hourly rate for all hours worked.

B. Holidays: New Year's Day; Memorial Day; Independence Day; Labor Day; Thanksgiving Day; Friday after Thanksgiving Day; Christmas Day; and Veterans Day.

ENGI0450-002 04/01/2014

Rates	Fringes
-------	---------

POWER EQUIPMENT OPERATOR  
 Cranes.....\$ 34.85                      9.85

\* IRON0084-011 06/01/2023

Rates	Fringes
-------	---------

IRONWORKER, ORNAMENTAL.....\$ 27.51                      8.13

-----  
 PAIN0130-002 06/01/2018

	Rates	Fringes
PAINTER (Brush, Roller, and Drywall Finishing/Taping).....	\$ 17.88	9.50

-----  
 \* PLAS0783-001 04/01/2023

	Rates	Fringes
PLASTERER.....	\$ 31.34	10.30

-----  
 PLUM0068-002 10/01/2022

	Rates	Fringes
PLUMBER.....	\$ 37.83	11.71

-----  
 PLUM0211-010 10/01/2022

	Rates	Fringes
PIPEFITTER (Including HVAC Pipe Installation).....	\$ 38.03	12.66

-----  
 SHEE0054-012 04/01/2020

	Rates	Fringes
SHEET METAL WORKER Excludes HVAC Duct and Unit Installation.....	\$ 29.70	13.85
HVAC Duct Installation Only.....	\$ 29.70	13.85

-----  
 \* SUTX2014-024 07/21/2014

	Rates	Fringes
ACOUSTICAL CEILING MECHANIC.....	\$ 16.41	3.98
BRICKLAYER.....	\$ 19.86	0.00
CAULKER.....	\$ 15.36 **	0.00
CEMENT MASON/CONCRETE FINISHER...\$ 13.82 **		0.00
DRYWALL HANGER AND METAL STUD INSTALLER.....	\$ 17.88	5.24
ELECTRICIAN (Alarm Installation Only).....	\$ 17.97	3.37
ELECTRICIAN (Low Voltage Wiring Only).....	\$ 19.23	3.55
FLOOR LAYER: Carpet.....	\$ 20.00	0.00
FORM WORKER.....	\$ 12.07 **	0.00
GLAZIER.....	\$ 17.09	3.41
HVAC MECHANIC (Installation of HVAC Unit Only).....	\$ 17.40	0.00

IRONWORKER, REINFORCING.....	\$ 12.10 **	0.00
IRONWORKER, STRUCTURAL.....	\$ 25.37	6.00
LABORER: Common or General.....	\$ 11.47 **	0.00
LABORER: Mason Tender - Brick...	\$ 13.37 **	0.00
LABORER: Mason Tender - Cement/Concrete.....	\$ 10.50 **	0.00
LABORER: Pipelayer.....	\$ 12.94 **	0.00
LABORER: Roof Tearoff.....	\$ 11.28 **	0.00
LABORER: Landscape and Irrigation.....	\$ 9.49 **	0.00
LATHER.....	\$ 20.11	0.00
OPERATOR: Backhoe/Excavator/Trackhoe.....	\$ 14.10 **	0.00
OPERATOR: Bobcat/Skid Steer/Skid Loader.....	\$ 13.93 **	0.00
OPERATOR: Bulldozer.....	\$ 20.77	0.00
OPERATOR: Drill.....	\$ 16.22	0.34
OPERATOR: Forklift.....	\$ 15.64 **	0.00
OPERATOR: Grader/Blade.....	\$ 13.37 **	0.00
OPERATOR: Loader.....	\$ 13.55 **	0.94
OPERATOR: Mechanic.....	\$ 17.52	3.33
OPERATOR: Paver (Asphalt, Aggregate, and Concrete).....	\$ 16.03 **	0.00
OPERATOR: Roller.....	\$ 16.00 **	0.00
PAINTER: Spray (Excludes Drywall Finishing/Taping).....	\$ 17.43	4.43
ROOFER.....	\$ 15.40 **	0.00
SPRINKLER FITTER (Fire Sprinklers).....	\$ 18.62	3.03
TILE FINISHER.....	\$ 12.00 **	0.00
TILE SETTER.....	\$ 16.17 **	0.00
TRUCK DRIVER: 1/Single Axle Truck.....	\$ 14.95 **	5.23
TRUCK DRIVER: Dump Truck.....	\$ 12.39 **	1.18
TRUCK DRIVER: Flatbed Truck.....	\$ 19.65	8.57
TRUCK DRIVER: Semi-Trailer Truck.....	\$ 12.50 **	0.00

TRUCK DRIVER: Water Truck.....	\$ 12.00 **	4.11
WATERPROOFER.....	\$ 14.39 **	0.00

-----  
WELDERS - Receive rate prescribed for craft performing operation to which welding is incidental.

=====  
\*\* Workers in this classification may be entitled to a higher minimum wage under Executive Order 14026 (\$16.20) or 13658 (\$12.15). Please see the Note at the top of the wage determination for more information.

Note: Executive Order (EO) 13706, Establishing Paid Sick Leave for Federal Contractors applies to all contracts subject to the Davis-Bacon Act for which the contract is awarded (and any solicitation was issued) on or after January 1, 2017. If this contract is covered by the EO, the contractor must provide employees with 1 hour of paid sick leave for every 30 hours they work, up to 56 hours of paid sick leave each year. Employees must be permitted to use paid sick leave for their own illness, injury or other health-related needs, including preventive care; to assist a family member (or person who is like family to the employee) who is ill, injured, or has other health-related needs, including preventive care; or for reasons resulting from, or to assist a family member (or person who is like family to the employee) who is a victim of, domestic violence, sexual assault, or stalking. Additional information on contractor requirements and worker protections under the EO is available at <https://www.dol.gov/agencies/whd/government-contracts>.

Unlisted classifications needed for work not included within the scope of the classifications listed may be added after award only as provided in the labor standards contract clauses (29CFR 5.5 (a) (1) (ii)).

-----  
The body of each wage determination lists the classification and wage rates that have been found to be prevailing for the cited type(s) of construction in the area covered by the wage determination. The classifications are listed in alphabetical order of "identifiers" that indicate whether the particular rate is a union rate (current union negotiated rate for local), a survey rate (weighted average rate) or a union-average rate (weighted union average rate).

Union Rate Identifiers

A four letter classification abbreviation identifier enclosed in dotted lines beginning with characters other than "SU" or "UAVG" denotes that the union classification and rate were prevailing for that classification in the survey. Example: PLUM0198-005 07/01/2014. PLUM is an abbreviation identifier of the union which prevailed in the survey for this classification, which in this example would be Plumbers. 0198 indicates the local union number or district council number where applicable, i.e., Plumbers Local 0198. The next number, 005 in the example, is an internal number used in processing

the wage determination. 07/01/2014 is the effective date of the most current negotiated rate, which in this example is July 1, 2014.

Union prevailing wage rates are updated to reflect all rate changes in the collective bargaining agreement (CBA) governing this classification and rate.

Survey Rate Identifiers

Classifications listed under the "SU" identifier indicate that no one rate prevailed for this classification in the survey and the published rate is derived by computing a weighted average rate based on all the rates reported in the survey for that classification. As this weighted average rate includes all rates reported in the survey, it may include both union and non-union rates. Example: SULA2012-007 5/13/2014. SU indicates the rates are survey rates based on a weighted average calculation of rates and are not majority rates. LA indicates the State of Louisiana. 2012 is the year of survey on which these classifications and rates are based. The next number, 007 in the example, is an internal number used in producing the wage determination. 5/13/2014 indicates the survey completion date for the classifications and rates under that identifier.

Survey wage rates are not updated and remain in effect until a new survey is conducted.

Union Average Rate Identifiers

Classification(s) listed under the UAVG identifier indicate that no single majority rate prevailed for those classifications; however, 100% of the data reported for the classifications was union data. EXAMPLE: UAVG-OH-0010 08/29/2014. UAVG indicates that the rate is a weighted union average rate. OH indicates the state. The next number, 0010 in the example, is an internal number used in producing the wage determination. 08/29/2014 indicates the survey completion date for the classifications and rates under that identifier.

A UAVG rate will be updated once a year, usually in January of each year, to reflect a weighted average of the current negotiated/CBA rate of the union locals from which the rate is based.

-----  
WAGE DETERMINATION APPEALS PROCESS

1.) Has there been an initial decision in the matter? This can be:

- \* an existing published wage determination
- \* a survey underlying a wage determination
- \* a Wage and Hour Division letter setting forth a position on a wage determination matter
- \* a conformance (additional classification and rate) ruling

On survey related matters, initial contact, including requests for summaries of surveys, should be with the Wage and Hour National Office because National Office has responsibility for the Davis-Bacon survey program. If the response from this initial contact is not satisfactory, then the process described



in 2.) and 3.) should be followed.

With regard to any other matter not yet ripe for the formal process described here, initial contact should be with the Branch of Construction Wage Determinations. Write to:

Branch of Construction Wage Determinations  
Wage and Hour Division  
U.S. Department of Labor  
200 Constitution Avenue, N.W.  
Washington, DC 20210

2.) If the answer to the question in 1.) is yes, then an interested party (those affected by the action) can request review and reconsideration from the Wage and Hour Administrator (See 29 CFR Part 1.8 and 29 CFR Part 7). Write to:

Wage and Hour Administrator  
U.S. Department of Labor  
200 Constitution Avenue, N.W.  
Washington, DC 20210

The request should be accompanied by a full statement of the interested party's position and by any information (wage payment data, project description, area practice material, etc.) that the requestor considers relevant to the issue.

3.) If the decision of the Administrator is not favorable, an interested party may appeal directly to the Administrative Review Board (formerly the Wage Appeals Board). Write to:

Administrative Review Board  
U.S. Department of Labor  
200 Constitution Avenue, N.W.  
Washington, DC 20210

4.) All decisions by the Administrative Review Board are final.

=====

END OF GENERAL DECISIO"



SETX Environmental, Inc.  
 DBA ASE Services  
 Environmental Consulting & Testing  
 Asbestos - Mold - Lead - ESA's

# ASBESTOS ABATEMENT SPECIFICATIONS

ASE Project No.: 23-274

**ATTACHMENTS:**  
 RESULTS OF THE ASBESTOS SURVEY(s)  
 FLOOR PLAN/MATERIAL LOCATION  
 TDSHS NOTIFICATION (N/A at this time)  
 AGENCY LICENSES & INSURANCE CERTIFICATE

**PROJECT LOCATION:** Vacant Structure – 1207 Oak Street, La Marque, TX 77568

**OWNER:** Galveston County – 722 Moody Avenue, Galveston, TX 77550

Attn: Mark Garcia  
 409.762.8621

**CONSULTANT AGENCY:** SETX Environmental, Inc.  
 3331 Taft Avenue  
 Groves, TX 77619

Attn: Jerry G. Sonier  
 409.963.2731

**ABATEMENT CONTRACTOR:** TBD

Attn: TBD

**PREPARED BY:**

Date: September 29, 2023

**LEWIS A. LOWERY**  
 TDH LICENSE #10-5290

TDSHS Licensed Project Manager(s): Justin Sonier, David Morton, and Tony Davis are hereby authorized to conduct visual inspections on my behalf, the consultant.

Original Notification Start Date:	TBD
Original Notification Completion Date:	TBD
Work Hours:	TBD

Note: This Specification is not intended to supercede any other agreements or contractual obligations between the Owner and Contractor.

---

### **ABBREVIATED SUMMARY:**

The contractor shall execute the entire scope of work described in the Contract Document, which includes furnishing all labor, materials, tools, and equipment to complete the asbestos abatement and/or demolition per these specifications. The work includes the removal, transportation, and proper disposal of all abatement related materials and demolition debris. The contractor's responsibilities include the furnishing of all documentation to meet requirements, codes, rules, and laws of all Federal, State and Local Regulatory Agencies.

### **SCOPE OF WORK:**

**Properly remove and dispose of approximately 14,600 Square Feet of 12" x 12" Floor Tile with asbestos-containing black mastic from throughout the interior, as well as approximately 120 linear feet of Air Cell TSI from within the vacant structure located at 1207 Oak Street in La Marque, Texas. This building is owned by Galveston County.**

**\*Note: The floor tile with asbestos containing black mastic may be hidden under sheetrock walls that were laid over the material. This should be determined by the contractor prior to the job commencing. The demolition scope of work inside the structure is a full interior gut.**

### **CONTAINMENT: Texas Asbestos Health Protection Rules (TAHPR)**

The floor tile/mastic removal will be conducted inside of a Negative Pressure Containment consisting of 6 mil polyethylene critical barriers, 5' Splash Guards, and Ceiling Criticals where required (porous ceiling tile system/missing ceiling tiles). The containment shall be equipped with a negative pressure system capable of producing at least 4 air changes per hour and maintaining continuously a pressure differential across the containment area of -0.020 inches of H<sub>2</sub>O. The containment must also be equipped with a working 3-stage decontamination system including all appropriate signage.

The TSI removal will be conducted inside of an established Regulated Area. This area will be delineated with all applicable signage and banner tape. The piping shall be via negative pressure glove bags. A 6-mil poly drop cloth and curtain shall be used under the work areas. A remote 3-stage decontamination system will be built adjacent to the regulated area.

### **WORKER PROTECTION & DECONTAMINATION:**

Workers will be required to wear disposable suits and a minimum of half face respirators equipped with dual cartridge HEPA filtration while performing removal work. All OSHA, NESHAP, and Texas Asbestos Health Protection Rules (TAHPR) by The Texas Department of State Health Services (TDSHS) shall be followed.



---

## **GENERAL WORK PRACTICES & REQUIREMENTS:**

Contractor shall erect barriers, barricades, and signs as required for safety and all applicable regulations.

Furnish Owner with Insurance Certificate as specified.

Furnish Consultant with copies of all Notifications, permits, licenses and Regulatory documentation required. **Owner is to pay Notification Fees.**

Advise the Project Manger with any Schedule changes for asbestos abatement and/or demolition prior to starting work. Update as changes occur.

**Furnish the Project Manager with all Waste Disposal Manifests. Waste containers shall be on-site prior to any abatement taking place. It is the contractor's responsibility to insure container change out takes place so that abatement activities are not disrupted. NO REMOVAL ACTIVITIES WILL TAKE PLACE WITHOUT A CONTAINER ON SITE THAT WILL FACILITATE THE ANTICIPATED AMOUNT OF MATERIAL.**

The Site and building shall be kept in a clean and safe condition at all times.

The Contractor shall provide a full-time on-site General Superintendent who is experienced in administration and supervision of asbestos abatement projects including work practices, disposal procedures, etc. The general Superintendent shall be licensed in accordance with state Law (TAHPR).

The Contractor shall prepare and submit reports, daily log sheet, to the OWNER and CONSULTANT of all accidents, at site and anywhere else work is in progress. Record and document data and actions; comply with industry standards.

The Contractor shall maintain within the work area, a daily log documenting the dates and time of but not limited to, the following items:

- Safety Meetings
- Visitors
- Air monitoring tests and test results
- Documentation of the following:
  - ☞ Inspection of work area preparation prior to start of removal and daily thereafter.
  - ☞ Removal of asbestos and demolition debris from work area.
  - ☞ Final inspection/final air test analysis.



---

The Contractor shall provide single-occupant self-contained toilet units of the chemical type, properly vented. These self-contained toilets shall be made available if no other agreements are made with the OWNER.

The Contractor shall provide First Aid Supplies complying with OSHA regulations and recognized recommendations within the construction industry.

The Contractor shall provide Fire extinguishers as required by The Texas Department of Health (TAHPR) rules.

The OWNER will provide the normal electrical supply and currently installed electrical system in the building for the use of the CONTRACTOR. Due to the building conditions, contractors shall plan on bringing an electrical panel/spider boxes that will be tied into the building power by a licensed electrician.

The CONTRACTOR, at his own expense shall provide temporary connections and route the power to its usage area. The OWNER provides no warranty as to the system's condition or capabilities. The CONTRACTOR shall assure himself that the electrical system is adequate for his requirements or supply additional temporary electrical power, at his own expense.

The OWNER will pay cost of the above utilities for the duration of the Project.

Damage to the water or electrical systems or surrounding areas (floors, ceilings, walls, etc.) resulting from failure of CONTRACTOR'S materials (hoses, cabling, etc.) or misuse or abuse of the existing systems shall be repaired or replaced by the CONTRACTOR to the satisfaction of the OWNER at no additional expense to the OWNER.

At the completion of Work the CONTRACTOR shall remove temporary connections and restore systems and surrounding area to pre-abatement conditions.

The OWNER or CONSULTANT will have the authority to stop work with the issuance of a Stop Work Order. If the OWNER or ASBESTOS CONSULTANT presents a written or verbal Stop Work Order, immediately and thoroughly stop Work. Do not recommence Work until authorized in writing by the ASBESTOS CONSULTANT.

The Contractor shall provide adequate warning signs, posted to warn persons approaching a Work Area of the Dangers of Asbestos. Post signage with initial barrier stating "CONSTRUCTION AREA, KEEP OUT", which must be breached to encounter asbestos specific warning signage. Located barriers and signage to provide warning to persons approaching the Work Area will have time to take adequate safety precautions.

The CONTRACTOR may discover suspected ACM, other than material to be abated under this Contract. Upon such discovery the CONTRACTOR shall take such action as is reasonably necessary and feasible to provide an interim safe and secure environment for its employees and third parties until the determination can be made of how next to proceed.

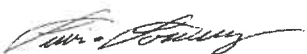

The CONTRACTOR shall have access only to those areas designated as Work Areas, or as otherwise directed by the OWNER. Storage of materials, field mobilized activities, and personnel shall remain in designated areas.

Except for elevators as may be designated by the OWNER, use of elevators by the CONTRACTOR will not be permitted. The designated elevator may be used for temporary freight service and the transportation of the construction personnel during the construction period. This elevator must also be available to the OWNER at all times. The Contractor shall provide protective pads for the elevator cab and other appropriate protective measures for the car and entrance doors and frames.

The OWNER will provide and pay for Inspection and Air Monitoring services through the CONSULTANT for the entirety of the project.

**INSURANCE REQUIREMENTS: NOT APPLICABLE**  
**SEE INSURANCE REQUIREMENTS PER GENERAL CONTRACTOR PACKET**

The Contractor shall maintain acceptable to the OWNER and Consultant, insurance as described below and will name the OWNER and CONSULTANT as Additionally Insured.

The limits of liability insurance required shall provide coverages for not less than the following amounts or greater where required by law. If the OWNER's requirements differ from those presented herein below, then the OWNER's requirements shall supersede.

Workers Compensation, etc. under the General Conditions (including Asbestos Abatement coverage):

I. State	Statutory	
II. Applicable Federal (e.g. Longshoremen's)	Statutory	
III. Employer's Liability	\$1,000,000	per
Occurrence		

Comprehensive General Liability (including coverage for Products, Completed Operation, Independent Contractor/Contractors protective, Contractual Liability, and Asbestos Abatement):

Bodily Injury:	\$1,000,000	per
Occurrence		
Property Damage:	\$1,000,000	per
Occurrence		
Comprehensive Automobile Liability under the General Conditions:		
Bodily Injury and Property Damage:	\$1,000,000	per
Occurrence		

A Certificate of Insurance shall be issued to the OWNER before the CONTRACTOR commences Work



**AIR MONITORING**

**BASE LINE FIBER LEVEL:** is an action level expressed in fibers per cubic centimeter that is the larger of the following:

Average of the samples collected outside each work area.

0.01 Fibers per cubic centimeter.

**The minimum number of baseline air samples, (3 each), shall be collected for each containment(s) as called for per TAHPR. (INTERIOR REMOVAL)**

Location Sampled	Minimum Number of Samples	Planned Method	Analytical
Each Work Area	1	PCM	
Outside Each Work Area	2	PCM	
Outside Building	0	PCM	

**DAILY SAMPLE SCHEDULE (PER 8-HOUR WORK PERIOD):** From start of work the CONSULTANT will generally take the following samples on a daily (8-hour work period) basis. The number of samples may vary according to site plan and on authorization of the ENGINEER.

Location Sampled per 8 Hour Shift	Number of Samples	Planned Method	Analytical
Each Work Area	1	PCM	
Outside Each Work Area	1	PCM	
Outside Building	0	PCM	
Output Negative Pressure System	1	PCM	

The CONSULTANT, in addition to providing air-monitoring services, will provide full-time, on-site inspection of Work Activities. Work shall not proceed without prior notice to the CONSULTANT and presence of the Consultants Project Manager.

**FINAL CLEARANCE:** After final clean-up of the Work Area, but prior to removal of Critical Barriers, the Consultant’s Project Manager will conduct a visual inspection followed by final air tests. Clearance sampling will require **a minimum of two (2) PCM (Polarized Light Microscopy) samples per containment.**

**PERSONAL MONITORING:**

The Contractor shall perform air monitoring as required to meet OSHA Requirements for maintenance of Time Weighed Average (TWA) and excursion limit fiber counts for fiber counts for types of respiratory protection provided. The Owner’s contracted consultant shall obtain personnel sampling for the contractor for a price of \$200.00/day.

Respiratory Protection shall be provided per OSHA Requirements.

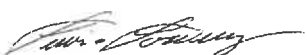

**ANALYSIS:** Fibers on each filter will be measured using the NIOSH 7400 procedures, or OSHA Reference Method (ORM) procedures.

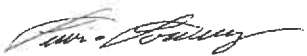
A handwritten signature in black ink, appearing to read "Mr. Bailey", is located at the bottom left of the page.





**SETX Environmental, Inc.**  
**Environmental Consulting & Testing**  
**Asbestos - Mold – Lead – ESA's**

---

Mr. Joel Colwell  
Huitt-Zollars  
1001 Fannin Street, #4040  
Houston, TX 77002

September 28, 2023  
ASE Project No. 23-262

Re: Limited Asbestos Survey (Interior Only)  
Site: Old Medical Building – 1207 Oak Street, La Marque, TX 77568

SETX Environmental, Inc. (ASE), Texas Department of State Health Services (TDSHS) Licensed Consultant Agency (License No. 100491), has conducted an asbestos survey at the above-referenced site of suspected Asbestos Containing Building Materials (ACBM) to be demolished or involved in renovations. This survey was performed in compliance with The Texas Asbestos Health Protection Rules (TAHPR) and the National Emissions Standards for Hazardous Air pollutants (NESHAP). This survey also satisfies the requirements of Senate Bill 509, which requires cities to verify an Asbestos Survey has been performed prior to issuing a Permit for Renovation, Demolition, Occupancy, etc. Mr. Jerry Sonier, TDSHS Asbestos Inspector, License No. 205317, and Mr. David Morton, TDSHS Asbestos Inspector, License No. 603600, conducted the survey. The survey was initiated and completed on September 22, 2023. Fifty-three (53) samples were collected and delivered to Apex Precision Analytical Services, Inc., TDSHS Lab License No. 30-0312, for analysis by Polarized Light Microscopy (PLM).

**The results of the surveys must be kept on site during renovation or demolition activities.**

This survey did not include destructive sampling and therefore is limited in scope. All suspect materials may not have been identified or sampled (hidden under carpet, in wall cavities, mirror mastic, or moisture barriers, etc.).

When renovations or demolition occurs, this survey should be reviewed to determine if additional sampling is required for those materials to be disturbed.

With regard to asbestos, a homogeneous area (an area of material that is uniform in color and texture) shall be determined to contain asbestos if the results of at least one sample collected from it indicate that asbestos is present in an amount of or greater than one percent (1%). Once a material has been found to contain asbestos, all such materials in the homogeneous area are considered to contain asbestos. A minimum of three (3) samples of each suspect material must be collected and analyzed in order to comply with the requirements of the **TAHPR Regulations**.

Building materials that contain asbestos and are in public buildings, commercial buildings, or facilities and which are in good condition can be managed under a Management Plan and an Operations and Maintenance (O&M) program. An O&M spells out the procedures and practices that must be applied to building cleaning, maintenance, renovation, and general operation to maintain the building as free of asbestos contamination as possible. The O&M would remain in effect until all ACM have been removed from the property for which it was prepared.

Prior to beginning asbestos abatement activities, notification must be sent to the TDSHS at least ten working days prior to the start of the work. A TDSHS licensed Asbestos Consultant must be engaged to prepare the specifications and conduct the project management and air monitoring activities during the abatement project and for final clearance.

**Based on the Laboratory Analysis, Asbestos HAS BEEN identified in a portion of the bulk samples below. (see BOLDED entries)**

**Sample Analysis Summary**

<b>Sample No.</b>	<b>Material &amp; Location</b>	<b>Asbestos Content</b>
01-262	Sheetrock/Joint Compound Walls – Room 14	None Detected
02-262	Sheetrock/Joint Compound Walls – H1 at Room 10	None Detected
03-262	Sheetrock/Joint Compound Walls – Room 49	None Detected
04-262	Sheetrock/Joint Compound Walls – Room 1	None Detected
05-262	Sheetrock/Joint Compound Walls – H5 at Room 44	None Detected
06-262	Sheetrock/Joint Compound Walls – Room 38	None Detected
07-262	Sheetrock/Joint Compound Walls – Room 31	None Detected
08-262	Sheetrock/Joint Compound East-Side Walls – Room 26	None Detected
09-262	Sheetrock/Joint Compound East-Side Walls – H3	None Detected
10-262	Sheetrock/Joint Compound East-Side Walls – Room 58	None Detected
11-262	Sheetrock/Joint Compound East-Side Walls – H3 at #23	None Detected
12-262	Sheetrock/Joint Compound East-Side Walls – Room 17	None Detected
13-262	Sheetrock/Joint Compound Ceilings – Room 61	None Detected
14-262	Sheetrock/Joint Compound Ceilings – Restroom #27	None Detected
15-262	Sheetrock/Joint Compound Ceilings – Restroom #27	None Detected
16-262	Plaster Ceilings – Mechanical #15	None Detected
17-262	Plaster Ceilings – Mechanical #15	None Detected
18-262	Plaster Ceilings – Mechanical #29	None Detected
19-262	Plaster Walls – #47 Jan Front	None Detected
20-262	Plaster Walls – Closet at Room 5	None Detected
21-262	Plaster Walls – Hall at Room 11	None Detected
22-262	Plaster Walls – Mechanical Room 27	None Detected
23-262	Plaster Walls – Mechanical Room 29	None Detected
<b>24-262</b>	<b>12" x 12" Beige Floor Tile with Black Mastic – Hall at Restroom 61</b>	<b>Black Mastic – Chrysotile 2%</b>
<b>25-262</b>	<b>12" x 12" Beige Floor Tile with Black Mastic – Room 57</b>	<b>Black Mastic – Chrysotile 2%</b>
<b>26-262</b>	<b>12" x 12" Beige Floor Tile with Black Mastic – H1 at Mechanical 15</b>	<b>Black Mastic – Chrysotile 2%</b>
27-262	12" x 12" Blue Floor Tile with Black Mastic -- #58, Two Layers	None Detected
28-262	12" x 12" Blue Floor Tile with Black Mastic -- #58, Two Layers	None Detected
29-262	12" x 12" Blue Floor Tile with Black Mastic – H5 at Room 49, Single	None Detected
30-262	Brown 4" Cove Base – H1 at 5	None Detected
31-262	Brown 4" Cove Base – Room 69	None Detected
32-262	Brown 4" Cove Base – Room 29	None Detected
33-262	Tan 4" Cove Base – Room 60	None Detected
34-262	Tan 4" Cove Base – Room 32	None Detected
35-262	Tan 4" Cove Base – Room 31	None Detected
36-262	2' x 2' Ceiling Tile – Room 57	None Detected
37-262	2' x 2' Ceiling Tile – H5 outside Room 70	None Detected
38-262	2' x 2' Ceiling Tile – Room 5	None Detected
39-262	HVAC Mastic – Mechanical Room 15	None Detected
40-262	HVAC Mastic – H3 outside Room 26	None Detected
41-262	HVAC Mastic – Mechanical Room 29	None Detected
42-262	Glue Pod – Room 25	None Detected

43-262	Glue Pod – Room 25	None Detected
44-262	Glue Pod – Room 25	None Detected
45-262	TSI Hard Fittings – Mechanical Room 15	None Detected
46-262	TSI Hard Fittings – Room 4	None Detected
47-262	TSI Hard Fittings – Room 12	None Detected
48-262	TSI Hard Cover – H5 outside Room 2	None Detected
49-262	TSI Hard Cover – Room 12	None Detected
50-262	TSI Hard Cover – Room 29	None Detected
<b>51-262</b>	<b>Air Cell TSI – Debris in Hall outside Room 2</b>	<b>Insulation – Chrysotile 3%</b>
<b>52-262</b>	<b>Air Cell TSI – Debris in Hall outside Room 2</b>	<b>Insulation – Chrysotile 3%</b>
<b>53-262</b>	<b>Air Cell TSI – Debris in Hall outside Room 2</b>	<b>Insulation – Chrysotile 3%</b>

The conclusions in an environmental consulting report are based on the findings of the investigation described in an industry accepted or specified scope. An assessment cannot absolutely conclude that a site does not contain hazardous materials inside structures or on its surface or subsurface or any such materials have not impacted the condition of the site.

As long as the assessment is conducted properly and within standards and/or regulations, and all due considerations are made, a degree of assurance can be achieved. The degree of assurance is determined by the amount of available information, scope of the assessment, and complexity of analyses performed. An absolute warranty cannot be expressed or implied that no environmental liabilities exist on the site.

Please contact me if you have any questions or if we can be of further assistance regarding this survey or other environmental issues.

**Respectfully:**



**Jerry G. Sonier**  
President  
TSDHS License No. 205317

**Respectfully:**



**David Morton**  
Asbestos Inspector  
TDSHS License No. 603600

**Attached:**  
Sample Locations (COC)  
Laboratory Analysis  
Company Licensing

CC: Job File

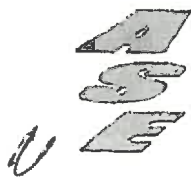

**SETX Environmental, Inc.**  
**dba ASE Services**  
**Environmental Consulting & Testing**  
**Asbestos - Mold - Lead - ESA's**

DM  
 1/3

**Bulk Sample Log**

5223-4119

Project #:	23-262	Date:	9/22/23
Project Name:	OLD MEDICAL BLDG. - Limited Asbestos Survey Interior only		
Location:	1207 OAK ST. LADARAVE		
Inspector:	Seaver / MORTON	TDSHS Lic. #	265317 / 603600
Accompanied By:	N/A		
Turn Around Time:	3 day		

Sample#	Material Sampled	Location Sampled	Asbestos %
01	SR/JC walls	Rm 14	
02		H1 @ Rm 10	
03		Rm 40	
04		Rm 1	
05		H5 @ Rm 44	
06		Rm 38	
07		Rm 31	
08	SR/JC EAST SIDE WALLS	Rm 26	
09		H3	
10		Rm 50	
11		H3 @ # 23	
12		Room # 17	
13	SR/JC Ceilings	Room # 61	
14		Rest Room # 27	
15			
16	Plaster C/As Mechanical	# 15	
17			
18		# 29	

Relinquished by:		Date:	9/22/23	Received by:		Date:	9/22/23 1550
------------------	--	-------	---------	--------------	--	-------	-----------------



**SETX Environmental, Inc.**  
 dba ASE Services  
 Environmental Consulting & Testing  
 Asbestos - Mold - Lead - ESA's

2/3

**Bulk Sample Log**

Project #:	23-262	Date:	9.22.23
Project Name:	Old Medical Bldg. - Limited Asbestos Survey Interior Only		
Location:	207 Oak St La Marque, TX		
Inspector:	Senter / Morton	TDSHS Lic. #	20507 / 60360
Accompanied By:	N/A		
Turn Around Time:	3-day		

Sample#	Material Sampled	Location Sampled	Asbestos %
19	Plaster Walls	Rm 47 JAN FRONT	
20		Closet Room # 5	
21		Hall @ Room # 11	
22		Mechanical Rm # 27	
23		Mechanical Rm # 29	
24	12 x 12 Beige w/blk mastic	hall @ RR 61	
25		Room 57	
26		H1 @ Mechanical 15	
27	12 x 12 Blue w/blk mastic	# 58	2 layers
28		# 58	5
29		H5 @ Rm 49	single
30	Brown 4" cove base	H1 @ 5	
31		Rm # 69	
32		Rm # 29	
33	Tan 4" cove base	Rm # 60	
34		Rm # 32	
35		Rm # 31	

Relinquished by:		Date:	9.22.23	Received by:		Date:	
------------------	--	-------	---------	--------------	--	-------	--



**SETX Environmental, Inc.**  
**dba ASE Services**  
**Environmental Consulting & Testing**  
**Asbestos - Mold - Lead - ESA's**

3/3

**Bulk Sample Log**

<b>Project #:</b>	23-262	<b>Date:</b>	9/22/25
<b>Project Name:</b>	Old Medical Bldg - Limited Asbestos Survey - Interior Only		
<b>Location:</b>	1207 Oak St. La Marque, TX		
<b>Inspector:</b>	Schier / Morton	<b>TDSHS Lic. #</b>	205717/60360
<b>Accompanied By:</b>	N/A		
<b>Turn Around Time:</b>	3-day		

Sample#	Material Sampled	Location Sampled	Asbestos %
36	2 x 2 CT	Room 57	
37	↓	H5 outside Rm 70	
38	↓	Room 5	
39	HVAC mastic	Mech room 15	
40	↓	H3 outside Rm 26	
41	↓	mech. room 29	
42	Glove pad	Room 25	
43	↓	↓	
44	↓	↓	
45	TSI hard fittings	mech room 15	
46	↓	Room 4	
47	↓	room 12	
48	TSI hard COVER	H5 outside rm 2	
49	↓	room 12	
50	↓	room 29	
51	AIR CELL TSI	Debris in Hall outside rm 2	
52	↓	↓	
53	↓	↓	

<b>Relinquished by:</b>		<b>Date:</b>	9/22/25	<b>Received by:</b>		<b>Date:</b>	
-------------------------	--	--------------	---------	---------------------	--	--------------	--

## ASBESTOS BULK ANALYSIS REPORT

Date: September 27, 2023

### ASE Services

Report: 5223-4119  
23-262 / Old Medical Building – Limited Asbestos  
Survey, Interior Only / 1207 Oak St., La Marque

This document shall be considered a duly signed original report of the results obtained from the analysis(es) performed. All analyses are done within government guidelines and regulations.



---

Gary R. Simmons  
Laboratory Manager

Lab Comments on Project: N/A



## PLM (Bulk) - Asbestos Analysis Report - Visual ID

EPA 600/R-93/116: Method for the Determination of Asbestos in Bulk Building Materials and EPA – 40 CFR Appendix E to Subpart E of Part 763, Interim Method of the Determination of Asbestos in Bulk Insulation Samples

**ASE Services**  
 3331 Taft Ave.  
 Groves, TX 77619  
 409-963-2731  
 Contact: Jerry Sonier

**Report Number:** 5223-4119  
**Report Date:** September 27, 2023  
**Samples Collected:** September 22, 2023  
**Date Received:** September 22, 2023  
**Turn-around time:** 72 Hour

**Job ID / Site:** 23-262 / Old Medical Building – Limited Asbestos Survey, Interior Only / 1207 Oak St., La Marque

Client Sample Number	Lab Sample Number (by layer)	Color / Description / Fibrous / NonFibrous / Homogeneity	Asbestos Content Type & %	Non-Asbestos Fibrous Type & %	Matrix
01	5223-4119-01A	White / Texture / NonFibrous / Homogeneous	None Detected	None Detected	Binder
	5223-4119-01B	Brown,White / Sheetrock / Fibrous / Homogeneous	None Detected	Cellulose 10% Fibrous Glass 2%	Binder
02	5223-4119-02A	White / Texture / NonFibrous / Homogeneous	None Detected	None Detected	Binder
	5223-4119-02B	Brown,White / Sheetrock / Fibrous / Homogeneous	None Detected	Cellulose 10% Fibrous Glass 2%	Binder
03	5223-4119-03A	White / Texture / NonFibrous / Homogeneous	None Detected	None Detected	Binder
	5223-4119-03B	Brown,White / Sheetrock / Fibrous / Homogeneous	None Detected	Cellulose 10% Fibrous Glass 2%	Binder
04	5223-4119-04A	White / Texture / NonFibrous / Homogeneous	None Detected	None Detected	Binder
	5223-4119-04B	Brown,White / Sheetrock / Fibrous / Homogeneous	None Detected	Cellulose 10% Fibrous Glass 2%	Binder
05	5223-4119-05A	White / Texture / NonFibrous / Homogeneous	None Detected	None Detected	Binder
	5223-4119-05B	Brown,White / Sheetrock / Fibrous / Homogeneous	None Detected	Cellulose 10% Fibrous Glass 2%	Binder

Analytical results and reports are generated by Apex Precision Analytical Services at the request of and for the exclusive use of the person or entity (client) named on such report. Result, reports or copies of same will not be released by Apex Precision Analytical Services to any third party without the written request from client. These results only represent the materials submitted. Supporting laboratory documentation is available upon request. This report cannot be used to represent conditions at any other location, date or time and does not imply that this space is free from these or any other contaminants. No responsibility or liability is assumed for the manner in which these results are used or interpreted. This must not be used to claim product endorsement by NVLAP or any government agency of the United States. Apex Precision Analytical Services reserves the right to dispose of all samples after a period of thirty (30) days, according to all state and federal guidelines, unless otherwise specified.

## PLM (Bulk) - Asbestos Analysis Report - Visual ID

EPA 600/R-93/116: Method for the Determination of Asbestos in Bulk Building Materials and EPA – 40 CFR Appendix E to Subpart E of Part 763, Interim Method of the Determination of Asbestos in Bulk Insulation Samples

**ASE Services**  
 3331 Taft Ave.  
 Groves, TX 77619  
 409-963-2731  
 Contact: Jerry Sonier

**Report Number:** 5223-4119  
**Report Date:** September 27, 2023  
**Samples Collected:** September 22, 2023  
**Date Received:** September 22, 2023  
**Turn-around time:** 72 Hour

**Job ID / Site:** 23-262 / Old Medical Building – Limited Asbestos Survey, Interior Only / 1207 Oak St., La Marque

Client Sample Number	Lab Sample Number (by layer)	Color / Description / Fibrous / NonFibrous / Homogeneity	Asbestos Content Type & %	Non-Asbestos Fibrous Type & %	Matrix
06	5223-4119-06A	White / Texture / NonFibrous / Homogeneous	None Detected	None Detected	Binder
	5223-4119-06B	Brown,White / Sheetrock / Fibrous / Homogeneous	None Detected	Cellulose 10% Fibrous Glass 2%	Binder
07	5223-4119-07A	White / Texture / NonFibrous / Homogeneous	None Detected	None Detected	Binder
	5223-4119-07B	Brown,White / Sheetrock / Fibrous / Homogeneous	None Detected	Cellulose 10% Fibrous Glass 2%	Binder
08	5223-4119-08A	White / Texture / NonFibrous / Homogeneous	None Detected	None Detected	Binder
	5223-4119-08B	Off White / Joint Tape / Fibrous / Homogeneous	None Detected	Cellulose 95%	Binder
	5223-4119-08C	White / Joint Compound / NonFibrous / Homogeneous	None Detected	None Detected	Binder
	5223-4119-08D	Brown,White / Sheetrock / Fibrous / Homogeneous	None Detected	Cellulose 10% Fibrous Glass 2%	Binder
09	5223-4119-09A	White / Texture / NonFibrous / Homogeneous	None Detected	None Detected	Binder
	5223-4119-09B	Brown,White / Sheetrock / Fibrous / Homogeneous	None Detected	Cellulose 10% Fibrous Glass 2%	Binder

Analytical results and reports are generated by Apex Precision Analytical Services at the request of and for the exclusive use of the person or entity (client) named on such report. Result, reports or copies of same will not be released by Apex Precision Analytical Services to any third party without the written request from client. These results only represent the materials submitted. Supporting laboratory documentation is available upon request. This report cannot be used to represent conditions at any other location, date or time and does not imply that this space is free from these or any other contaminants. No responsibility or liability is assumed for the manner in which these results are used or interpreted. This must not be used to claim product endorsement by NVLAP or any government agency of the United States. Apex Precision Analytical Services reserves the right to dispose of all samples after a period of thirty (30) days, according to all state and federal guidelines, unless otherwise specified.

## PLM (Bulk) - Asbestos Analysis Report - Visual ID

EPA 600/R-93/116: Method for the Determination of Asbestos in Bulk Building Materials and EPA – 40 CFR Appendix E to Subpart E of Part 763, Interim Method of the Determination of Asbestos in Bulk Insulation Samples

**ASE Services**  
 3331 Taft Ave.  
 Groves, TX 77619  
 409-963-2731  
 Contact: Jerry Sonier

**Report Number:** 5223-4119  
**Report Date:** September 27, 2023  
**Samples Collected:** September 22, 2023  
**Date Received:** September 22, 2023  
**Turn-around time:** 72 Hour

**Job ID / Site:** 23-262 / Old Medical Building – Limited Asbestos Survey, Interior Only / 1207 Oak St., La Marque

Client Sample Number	Lab Sample Number (by layer)	Color / Description / Fibrous / NonFibrous / Homogeneity	Asbestos Content Type & %	Non-Asbestos Fibrous Type & %	Matrix
10	5223-4119-10A	White / Texture / NonFibrous / Homogeneous	None Detected	None Detected	Binder
	5223-4119-10B	Brown,White / Sheetrock / Fibrous / Homogeneous	None Detected	Cellulose 10% Fibrous Glass 2%	Binder
11	5223-4119-11A	White / Texture / NonFibrous / Homogeneous	None Detected	None Detected	Binder
	5223-4119-11B	Brown,White / Sheetrock / Fibrous / Homogeneous	None Detected	Cellulose 10% Fibrous Glass 2%	Binder
12	5223-4119-12A	White / Texture / NonFibrous / Homogeneous	None Detected	None Detected	Binder
	5223-4119-12B	Brown,White / Sheetrock / Fibrous / Homogeneous	None Detected	Cellulose 10% Fibrous Glass 2%	Binder
13	5223-4119-13A	White / Texture / NonFibrous / Homogeneous	None Detected	None Detected	Binder
	5223-4119-13B	Green,Brown / Drywall / Fibrous / Homogeneous	None Detected	Cellulose 10% Fibrous Glass 2%	Binder
14	5223-4119-14A	White / Texture / NonFibrous / Homogeneous	None Detected	None Detected	Binder
	5223-4119-14B	Green,Brown / Drywall / Fibrous / Homogeneous	None Detected	Cellulose 10% Fibrous Glass 2%	Binder

Analytical results and reports are generated by Apex Precision Analytical Services at the request of and for the exclusive use of the person or entity (client) named on such report. Result, reports or copies of same will not be released by Apex Precision Analytical Services to any third party without the written request from client. These results only represent the materials submitted. Supporting laboratory documentation is available upon request. This report cannot be used to represent conditions at any other location, date or time and does not imply that this space is free from these or any other contaminants. No responsibility or liability is assumed for the manner in which these results are used or interpreted. This must not be used to claim product endorsement by NVLAP or any government agency of the United States. Apex Precision Analytical Services reserves the right to dispose of all samples after a period of thirty (30) days, according to all state and federal guidelines, unless otherwise specified.

## PLM (Bulk) - Asbestos Analysis Report - Visual ID

EPA 600/R-93/116: Method for the Determination of Asbestos in Bulk Building Materials and EPA – 40 CFR Appendix E to Subpart E of Part 763, Interim Method of the Determination of Asbestos in Bulk Insulation Samples

ASE Services  
3331 Taft Ave.  
Groves, TX 77619  
409-963-2731

Contact: Jerry Sonier

Report Number: 5223-4119  
Report Date: September 27, 2023  
Samples Collected: September 22, 2023  
Date Received: September 22, 2023  
Turn-around time: 72 Hour

Job ID / Site: 23-262 / Old Medical Building – Limited Asbestos Survey, Interior Only / 1207 Oak St., La Marque

Client Sample Number	Lab Sample Number (by layer)	Color / Description / Fibrous / NonFibrous / Homogeneity	Asbestos Content Type & %	Non-Asbestos Fibrous Type & %	Matrix
15	5223-4119-15A	White / Texture / NonFibrous / Homogeneous	None Detected	None Detected	Binder
	5223-4119-15B	Green,Brown / Drywall / Fibrous / Homogeneous	None Detected	Cellulose 10% Fibrous Glass 2%	Binder
16	5223-4119-16	Off White,Grey / Material / NonFibrous / Homogeneous	None Detected	None Detected	Binder
17	5223-4119-17	Off White,Grey / Material / NonFibrous / Homogeneous	None Detected	None Detected	Binder
18	5223-4119-18	Off White,Grey / Material / NonFibrous / Homogeneous	None Detected	None Detected	Binder
19	5223-4119-19	Off White,Grey / Material / NonFibrous / Homogeneous	None Detected	None Detected	Binder
20	5223-4119-20	Off White,Grey / Material / NonFibrous / Homogeneous	None Detected	None Detected	Binder
21	5223-4119-21	Off White,Grey / Material / NonFibrous / Homogeneous	None Detected	None Detected	Binder
22	5223-4119-22	Off White,Grey / Material / NonFibrous / Homogeneous	None Detected	None Detected	Binder
23	5223-4119-23	Off White,Grey / Material / NonFibrous / Homogeneous	None Detected	None Detected	Binder

Analytical results and reports are generated by Apex Precision Analytical Services at the request of and for the exclusive use of the person or entity (client) named on such report. Result, reports or copies of same will not be released by Apex Precision Analytical Services to any third party without the written request from client. These results only represent the materials submitted. Supporting laboratory documentation is available upon request. This report cannot be used to represent conditions at any other location, date or time and does not imply that this space is free from these or any other contaminants. No responsibility or liability is assumed for the manner in which these results are used or interpreted. This must not be used to claim product endorsement by NVLAP or any government agency of the United States. Apex Precision Analytical Services reserves the right to dispose of all samples after a period of thirty (30) days, according to all state and federal guidelines, unless otherwise specified.

## PLM (Bulk) - Asbestos Analysis Report - Visual ID

EPA 600/R-93/116: Method for the Determination of Asbestos in Bulk Building Materials and EPA – 40 CFR Appendix E to Subpart E of Part 763, Interim Method of the Determination of Asbestos in Bulk Insulation Samples

**ASE Services**  
 3331 Taft Ave.  
 Groves, TX 77619  
 409-963-2731

**Report Number:** 5223-4119  
**Report Date:** September 27, 2023  
**Samples Collected:** September 22, 2023  
**Date Received:** September 22, 2023  
**Turn-around time:** 72 Hour

**Contact:** Jerry Sonier

**Job ID / Site:** 23-262 / Old Medical Building – Limited Asbestos Survey, Interior Only / 1207 Oak St., La Marque

Client Sample Number	Lab Sample Number (by layer)	Color / Description / Fibrous / NonFibrous / Homogeneity	Asbestos Content Type & %	Non-Asbestos Fibrous Type & %	Matrix
24	5223-4119-24A	Tan / Floor Tile / NonFibrous / Homogeneous	None Detected	None Detected	Binder
	5223-4119-24B	Black,Grey / Mastic,Material / Fibrous / Homogeneous	Chrysotile 2%	None Detected	Binder
25	5223-4119-25A	Tan / Floor Tile / NonFibrous / Homogeneous	None Detected	None Detected	Binder
	5223-4119-25B	Black,Grey / Mastic,Material / Fibrous / Homogeneous	Chrysotile 2%	None Detected	Binder
26	5223-4119-26A	Tan / Floor Tile / NonFibrous / Homogeneous	None Detected	None Detected	Binder
	5223-4119-26B	Black,Grey / Mastic,Material / Fibrous / Homogeneous	Chrysotile 2%	None Detected	Binder
27	5223-4119-27A	Green / Floor Tile / NonFibrous / Homogeneous	None Detected	None Detected	Binder
	5223-4119-27B	Yellow / Mastic / NonFibrous / Homogeneous	None Detected	None Detected	Binder
	5223-4119-27C	Tan / Floor Tile / NonFibrous / Homogeneous	None Detected	None Detected	Binder
	5223-4119-27D	Black / Mastic / Fibrous / Homogeneous	None Detected	Cellulose 2%	Binder

Analytical results and reports are generated by Apex Precision Analytical Services at the request of and for the exclusive use of the person or entity (client) named on such report. Result, reports or copies of same will not be released by Apex Precision Analytical Services to any third party without the written request from client. These results only represent the materials submitted. Supporting laboratory documentation is available upon request. This report cannot be used to represent conditions at any other location, date or time and does not imply that this space is free from these or any other contaminants. No responsibility or liability is assumed for the manner in which these results are used or interpreted. This must not be used to claim product endorsement by NVLAP or any government agency of the United States. Apex Precision Analytical Services reserves the right to dispose of all samples after a period of thirty (30) days, according to all state and federal guidelines, unless otherwise specified.

## PLM (Bulk) - Asbestos Analysis Report - Visual ID

EPA 600/R-93/116: Method for the Determination of Asbestos in Bulk Building Materials and EPA – 40 CFR Appendix E to Subpart E of Part 763, Interim Method of the Determination of Asbestos in Bulk Insulation Samples

**ASE Services**  
 3331 Taft Ave.  
 Groves, TX 77619  
 409-963-2731

**Report Number:** 5223-4119  
**Report Date:** September 27, 2023  
**Samples Collected:** September 22, 2023  
**Date Received:** September 22, 2023  
**Turn-around time:** 72 Hour

**Contact:** Jerry Sonier

**Job ID / Site:** 23-262 / Old Medical Building – Limited Asbestos Survey, Interior Only / 1207 Oak St., La Marque

Client Sample Number	Lab Sample Number (by layer)	Color / Description / Fibrous / NonFibrous / Homogeneity	Asbestos Content Type & %	Non-Asbestos Fibrous Type & %	Matrix
28	5223-4119-28A	Tan / Floor Tile / NonFibrous / Homogeneous	None Detected	None Detected	Binder
	5223-4119-28B	Black / Mastic / Fibrous / Homogeneous	None Detected	Cellulose 2%	Binder
29	5223-4119-29A	Off White,Grey / Floor Tile / NonFibrous / Homogeneous	None Detected	None Detected	Binder
	5223-4119-29B	Yellow / Mastic / NonFibrous / Homogeneous	None Detected	None Detected	Binder
30	5223-4119-30A	Brown / Cove Base / NonFibrous / Homogeneous	None Detected	None Detected	Binder
	5223-4119-30B	Yellow / Mastic / NonFibrous / Homogeneous	None Detected	None Detected	Binder
31	5223-4119-31A	Brown / Cove Base / NonFibrous / Homogeneous	None Detected	None Detected	Binder
	5223-4119-31B	Yellow / Mastic / NonFibrous / Homogeneous	None Detected	None Detected	Binder
32	5223-4119-32A	Brown / Cove Base / NonFibrous / Homogeneous	None Detected	None Detected	Binder
	5223-4119-32B	Yellow / Mastic / NonFibrous / Homogeneous	None Detected	None Detected	Binder

Analytical results and reports are generated by Apex Precision Analytical Services at the request of and for the exclusive use of the person or entity (client) named on such report. Result, reports or copies of same will not be released by Apex Precision Analytical Services to any third party without the written request from client. These results only represent the materials submitted. Supporting laboratory documentation is available upon request. This report cannot be used to represent conditions at any other location, date or time and does not imply that this space is free from these or any other contaminants. No responsibility or liability is assumed for the manner in which these results are used or interpreted. This must not be used to claim product endorsement by NVLAP or any government agency of the United States. Apex Precision Analytical Services reserves the right to dispose of all samples after a period of thirty (30) days, according to all state and federal guidelines, unless otherwise specified.

## PLM (Bulk) - Asbestos Analysis Report - Visual ID

EPA 600/R-93/116: Method for the Determination of Asbestos in Bulk Building Materials and EPA – 40 CFR Appendix E to Subpart E of Part 763, Interim Method of the Determination of Asbestos in Bulk Insulation Samples

**ASE Services**  
3331 Taft Ave.  
Groves, TX 77619  
409-963-2731

**Report Number:** 5223-4119  
**Report Date:** September 27, 2023  
**Samples Collected:** September 22, 2023  
**Date Received:** September 22, 2023  
**Turn-around time:** 72 Hour

**Contact:** Jerry Sonier

**Job ID / Site:** 23-262 / Old Medical Building – Limited Asbestos Survey, Interior Only / 1207 Oak St., La Marque

Client Sample Number	Lab Sample Number (by layer)	Color / Description / Fibrous / NonFibrous / Homogeneity	Asbestos Content Type & %	Non-Asbestos Fibrous Type & %	Matrix
33	5223-4119-33A	Tan / Cove Base / NonFibrous / Homogeneous	None Detected	None Detected	Binder
	5223-4119-33B	Yellow / Mastic / NonFibrous / Homogeneous	None Detected	None Detected	Binder
34	5223-4119-34A	Tan / Cove Base / NonFibrous / Homogeneous	None Detected	None Detected	Binder
	5223-4119-34B	Yellow / Mastic / NonFibrous / Homogeneous	None Detected	None Detected	Binder
35	5223-4119-35A	Tan / Cove Base / NonFibrous / Homogeneous	None Detected	None Detected	Binder
	5223-4119-35B	Yellow / Mastic / NonFibrous / Homogeneous	None Detected	None Detected	Binder
36	5223-4119-36	White,Grey / 2x2 Ceiling Tile / Fibrous / Homogeneous	None Detected	Cellulose 45% Fibrous Glass 15%	Binder
37	5223-4119-37	White,Grey / 2x2 Ceiling Tile / Fibrous / Homogeneous	None Detected	Cellulose 45% Fibrous Glass 15%	Binder
38	5223-4119-38	White,Grey / 2x2 Ceiling Tile / Fibrous / Homogeneous	None Detected	Cellulose 45% Fibrous Glass 15%	Binder
39	5223-4119-39A	White,Silver / Mastic Wrap / Fibrous / Homogeneous	None Detected	Cellulose 20% Fibrous Glass 5%	Binder

Analytical results and reports are generated by Apex Precision Analytical Services at the request of and for the exclusive use of the person or entity (client) named on such report. Result, reports or copies of same will not be released by Apex Precision Analytical Services to any third party without the written request from client. These results only represent the materials submitted. Supporting laboratory documentation is available upon request. This report cannot be used to represent conditions at any other location, date or time and does not imply that this space is free from these or any other contaminants. No responsibility or liability is assumed for the manner in which these results are used or interpreted. This must not be used to claim product endorsement by NVLAP or any government agency of the United States. Apex Precision Analytical Services reserves the right to dispose of all samples after a period of thirty (30) days, according to all state and federal guidelines, unless otherwise specified.

## PLM (Bulk) - Asbestos Analysis Report - Visual ID

EPA 600/R-93/116: Method for the Determination of Asbestos in Bulk Building Materials and EPA – 40 CFR Appendix E to Subpart E of Part 763, Interim Method of the Determination of Asbestos in Bulk Insulation Samples

**ASE Services**  
 3331 Taft Ave.  
 Groves, TX 77619  
 409-963-2731  
 Contact: Jerry Sonier

**Report Number:** 5223-4119  
**Report Date:** September 27, 2023  
**Samples Collected:** September 22, 2023  
**Date Received:** September 22, 2023  
**Turn-around time:** 72 Hour

**Job ID / Site:** 23-262 / Old Medical Building – Limited Asbestos Survey, Interior Only / 1207 Oak St., La Marque

Client Sample Number	Lab Sample Number (by layer)	Color / Description / Fibrous / NonFibrous / Homogeneity	Asbestos Content Type & %	Non-Asbestos Fibrous Type & %	Matrix
39	5223-4119-39B	Yellow / Insulation / Fibrous / Homogeneous	None Detected	Fibrous Glass 95%	Binder
40	5223-4119-40A	White,Silver / Mastic Wrap / Fibrous / Homogeneous	None Detected	Cellulose 20% Fibrous Glass 5%	Binder
	5223-4119-40B	Yellow / Insulation / Fibrous / Homogeneous	None Detected	Fibrous Glass 95%	Binder
41	5223-4119-41A	White,Silver / Mastic Wrap / Fibrous / Homogeneous	None Detected	Cellulose 20% Fibrous Glass 5%	Binder
	5223-4119-41B	Yellow / Insulation / Fibrous / Homogeneous	None Detected	Fibrous Glass 95%	Binder
42	5223-4119-42	Yellow / Glue / NonFibrous / Homogeneous	None Detected	None Detected	Binder
43	5223-4119-43	Yellow / Glue / NonFibrous / Homogeneous	None Detected	None Detected	Binder
44	5223-4119-44	Yellow / Glue / NonFibrous / Homogeneous	None Detected	None Detected	Binder
45	5223-4119-45A	Off White / Wrap / Fibrous / Homogeneous	None Detected	Cellulose 95%	Binder
	5223-4119-45B	Grey / Insulation / Fibrous / Homogeneous	None Detected	Cellulose 3% Fibrous Glass 10%	Binder

Analytical results and reports are generated by Apex Precision Analytical Services at the request of and for the exclusive use of the person or entity (client) named on such report. Result, reports or copies of same will not be released by Apex Precision Analytical Services to any third party without the written request from client. These results only represent the materials submitted. Supporting laboratory documentation is available upon request. This report cannot be used to represent conditions at any other location, date or time and does not imply that this space is free from these or any other contaminants. No responsibility or liability is assumed for the manner in which these results are used or interpreted. This must not be used to claim product endorsement by NVLAP or any government agency of the United States. Apex Precision Analytical Services reserves the right to dispose of all samples after a period of thirty (30) days, according to all state and federal guidelines, unless otherwise specified.



## PLM (Bulk) - Asbestos Analysis Report - Visual ID

EPA 600/R-93/116: Method for the Determination of Asbestos in Bulk Building Materials and EPA – 40 CFR Appendix E to Subpart E of Part 763, Interim Method of the Determination of Asbestos in Bulk Insulation Samples

**ASE Services**  
 3331 Taft Ave.  
 Groves, TX 77619  
 409-963-2731  
 Contact: Jerry Sonier

**Report Number:** 5223-4119  
**Report Date:** September 27, 2023  
**Samples Collected:** September 22, 2023  
**Date Received:** September 22, 2023  
**Turn-around time:** 72 Hour

**Job ID / Site:** 23-262 / Old Medical Building – Limited Asbestos Survey, Interior Only / 1207 Oak St., La Marque

Client Sample Number	Lab Sample Number (by layer)	Color / Description / Fibrous / NonFibrous / Homogeneity	Asbestos Content Type & %	Non-Asbestos Fibrous Type & %	Matrix
46	5223-4119-46A	Off White / Wrap / Fibrous / Homogeneous	None Detected	Cellulose 95%	Binder
	5223-4119-46B	Grey / Insulation / Fibrous / Homogeneous	None Detected	Cellulose 3% Fibrous Glass 10%	Binder
47	5223-4119-47A	Off White / Wrap / Fibrous / Homogeneous	None Detected	Cellulose 95%	Binder
	5223-4119-47B	Grey / Insulation / Fibrous / Homogeneous	None Detected	Cellulose 3% Fibrous Glass 10%	Binder
48	5223-4119-48	White / Insulation / Fibrous / Homogeneous	None Detected	Synthetic 3%	Binder
49	5223-4119-49	White / Insulation / Fibrous / Homogeneous	None Detected	Synthetic 3%	Binder
50	5223-4119-50	White / Insulation / Fibrous / Homogeneous	None Detected	Synthetic 3%	Binder
51	5223-4119-51	Brown / Insulation / Fibrous / Homogeneous	Chrysotile 3%	Cellulose 90%	Binder
52	5223-4119-52	Brown / Insulation / Fibrous / Homogeneous	Chrysotile 3%	Cellulose 90%	Binder
53	5223-4119-53	Brown / Insulation / Fibrous / Homogeneous	Chrysotile 3%	Cellulose 90%	Binder

Analytical results and reports are generated by Apex Precision Analytical Services at the request of and for the exclusive use of the person or entity (client) named on such report. Result, reports or copies of same will not be released by Apex Precision Analytical Services to any third party without the written request from client. These results only represent the materials submitted. Supporting laboratory documentation is available upon request. This report cannot be used to represent conditions at any other location, date or time and does not imply that this space is free from these or any other contaminants. No responsibility or liability is assumed for the manner in which these results are used or interpreted. This must not be used to claim product endorsement by NVLAP or any government agency of the United States. Apex Precision Analytical Services reserves the right to dispose of all samples after a period of thirty (30) days, according to all state and federal guidelines, unless otherwise specified.



Texas Department of State Health Services

SETX ENVIRONMENTAL INC DBA  
ASE SERVICES

*is certified to perform as an*

Asbestos Consultant Agency

*in the State of Texas and is hereby governed by the rights, privileges and responsibilities set forth in Texas Occupations Code, Chapter 1954 and Title 12, Texas Administrative Code, Chapter 295 relating to Texas Asbestos Health Protection, as long as this license is not suspended or revoked.*



**License Number: 100491**

**Expiration Date: 10/25/2024**

**Control Number: 97520**

*Jennifer Shuford, MD*  
**Jennifer Shuford, MD, MPH,**  
**Commissioner of Health**

**(Void After Expiration Date)**

VOID IF ALTERED NON-TRANSFERABLE

SEE BACK

Asbestos-containing Black Mastic/Floor Tile

Asbestos-containing Air Cell TSI

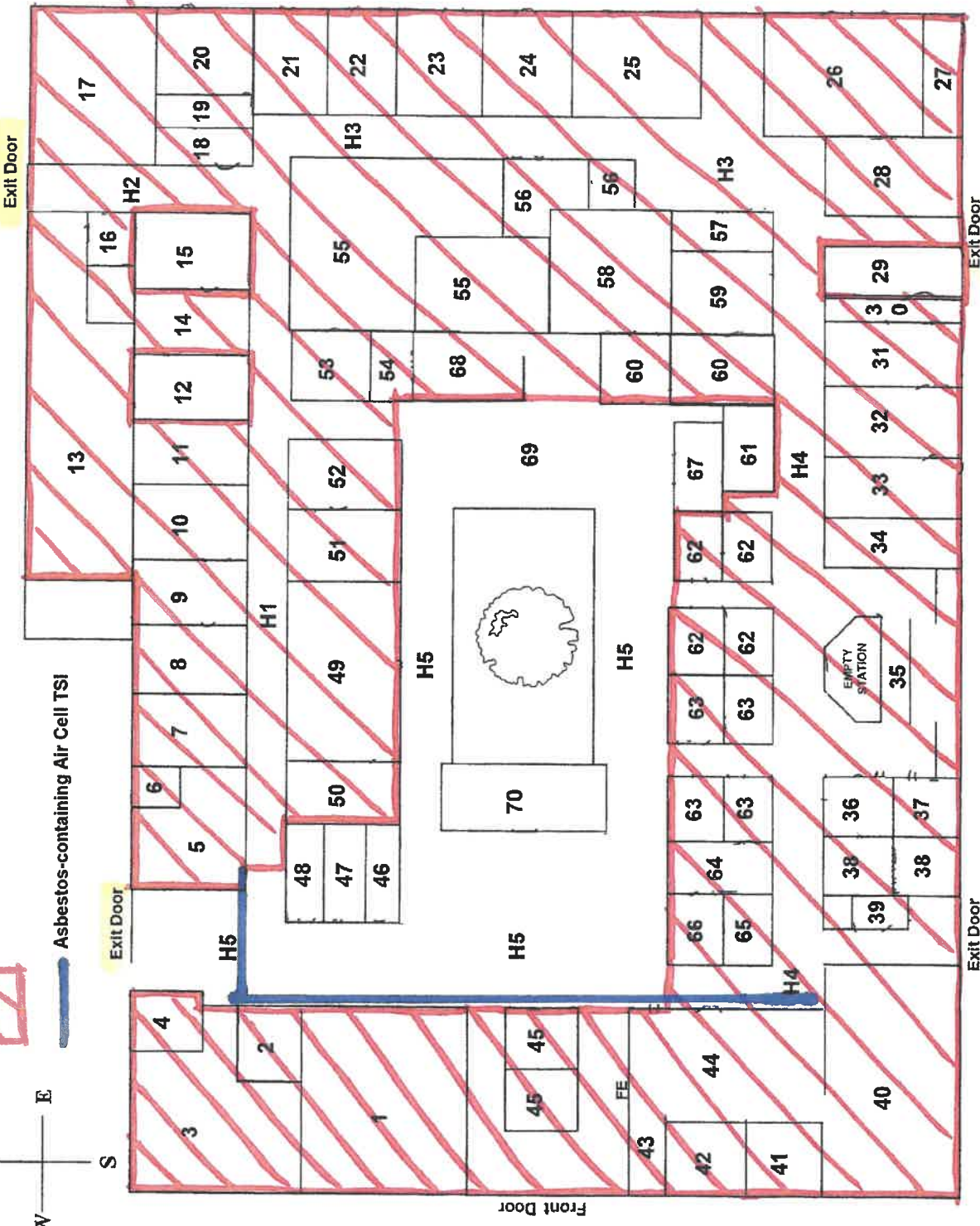
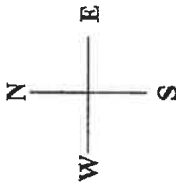

Vacant Structure - 1207 Oak St, La Marque, TX 77568

#23-274 9-29-23

*[Handwritten signature]*



Texas Department of State Health Services

SETX ENVIRONMENTAL INC DBA  
ASE SERVICES

*is certified to perform as an*

Asbestos Consultant Agency

*in the State of Texas and is hereby governed by the rights, privileges and responsibilities set forth in Texas Occupations Code, Chapter 1954 and Title 12, Texas Administrative Code, Chapter 295 relating to Texas Asbestos Health Protection, as long as this license is not suspended or revoked.*



*License Number: 100491*

*Expiration Date: 10/25/2024*

*Control Number: 97520*

*Jennifer Shuford, MD*  
**Jennifer Shuford, MD, MPH,**  
**Commissioner of Health**

*(Void After Expiration Date)*

VOID IF ALTERED NON-TRANSFERABLE

SEE BACK



Texas Department of State Health Services

SETX ENVIRONMENTAL INC DBA  
ASE SERVICES

*is certified to perform as an*

Asbestos Laboratory  
PCM

*in the State of Texas and is hereby governed by the rights, privileges and responsibilities set forth in Texas Occupations Code, Chapter 1954 and Title 12, Texas Administrative Code, Chapter 295 relating to Texas Asbestos Health Protection, as long as this license is not suspended or revoked.*



**License Number: 300432**

**Expiration Date: 10/04/2023**

**Control Number: 96563**

  
**John Hellerstedt, M.D.,  
Commissioner of Health**

**(Void After Expiration Date)**

VOID IF ALTERED NON-TRANSFERABLE

SEE BACK

# MENTAL HEALTH EXTENDED OBSERVATION UNIT

PROJECT NO.  
R316595.01

## CONSULTANTS

1. MEP & LOWVOLTAGE CONSULTANTS  
HUIITT ZOLLARS  
1001 FANNING ST., SUITE 4040  
HOUSTON, TX 77002  
CONTACT: LAM TALKOVICH  
713.589.8800



# INTERIOR DEMOLITION PACKAGE SUBMITTAL GALVESTON COUNTY 09/20/2023



**HUIITT  
ZOLLARS**

1001 FANNING ST., SUITE 4040  
HOUSTON, TX 77002 713.582.1180  
WWW.HUIITT-ZOLLARS.COM



**HUITT ZOLLARS**  
 ARCHITECTURAL  
 1000 FANNING STREET, SUITE 100  
 HOUSTON, TX 77002  
 713-462-1180  
 WWW.HUITTZOLLARS.COM

**ADVANCED DESIGN™**  
 CONSULTANT  
 1000 FANNING STREET, SUITE 100  
 HOUSTON, TX 77002  
 713-462-1180  
 WWW.HUITTZOLLARS.COM



GALVESTON COUNTY  
 222 North F. W. O'Connell, TX 77568

**MENTAL HEALTH  
 EXTENDED  
 OBSERVATION UNIT**

PROJECT NUMBER  
 1201 S. Oak Street  
 La Marque, TX 77568

NO.	DATE	DESCRIPTION
1	10/01/2010	ISSUED FOR PERMITS
2	10/01/2010	ISSUED FOR PERMITS
3	10/01/2010	ISSUED FOR PERMITS
4	10/01/2010	ISSUED FOR PERMITS
5	10/01/2010	ISSUED FOR PERMITS
6	10/01/2010	ISSUED FOR PERMITS
7	10/01/2010	ISSUED FOR PERMITS
8	10/01/2010	ISSUED FOR PERMITS
9	10/01/2010	ISSUED FOR PERMITS
10	10/01/2010	ISSUED FOR PERMITS
11	10/01/2010	ISSUED FOR PERMITS
12	10/01/2010	ISSUED FOR PERMITS
13	10/01/2010	ISSUED FOR PERMITS
14	10/01/2010	ISSUED FOR PERMITS
15	10/01/2010	ISSUED FOR PERMITS
16	10/01/2010	ISSUED FOR PERMITS
17	10/01/2010	ISSUED FOR PERMITS
18	10/01/2010	ISSUED FOR PERMITS
19	10/01/2010	ISSUED FOR PERMITS
20	10/01/2010	ISSUED FOR PERMITS

PROJECT NO. 111800-01  
 DRAWN BY: J. ZOLLARS  
 CHECKED BY: J. ZOLLARS  
 APPROVED BY: J. ZOLLARS  
 DATE: 10/01/2010

**ARCHITECTURAL  
 SITE PLAN**

**AS-101**  
 OF 100 SHEETS

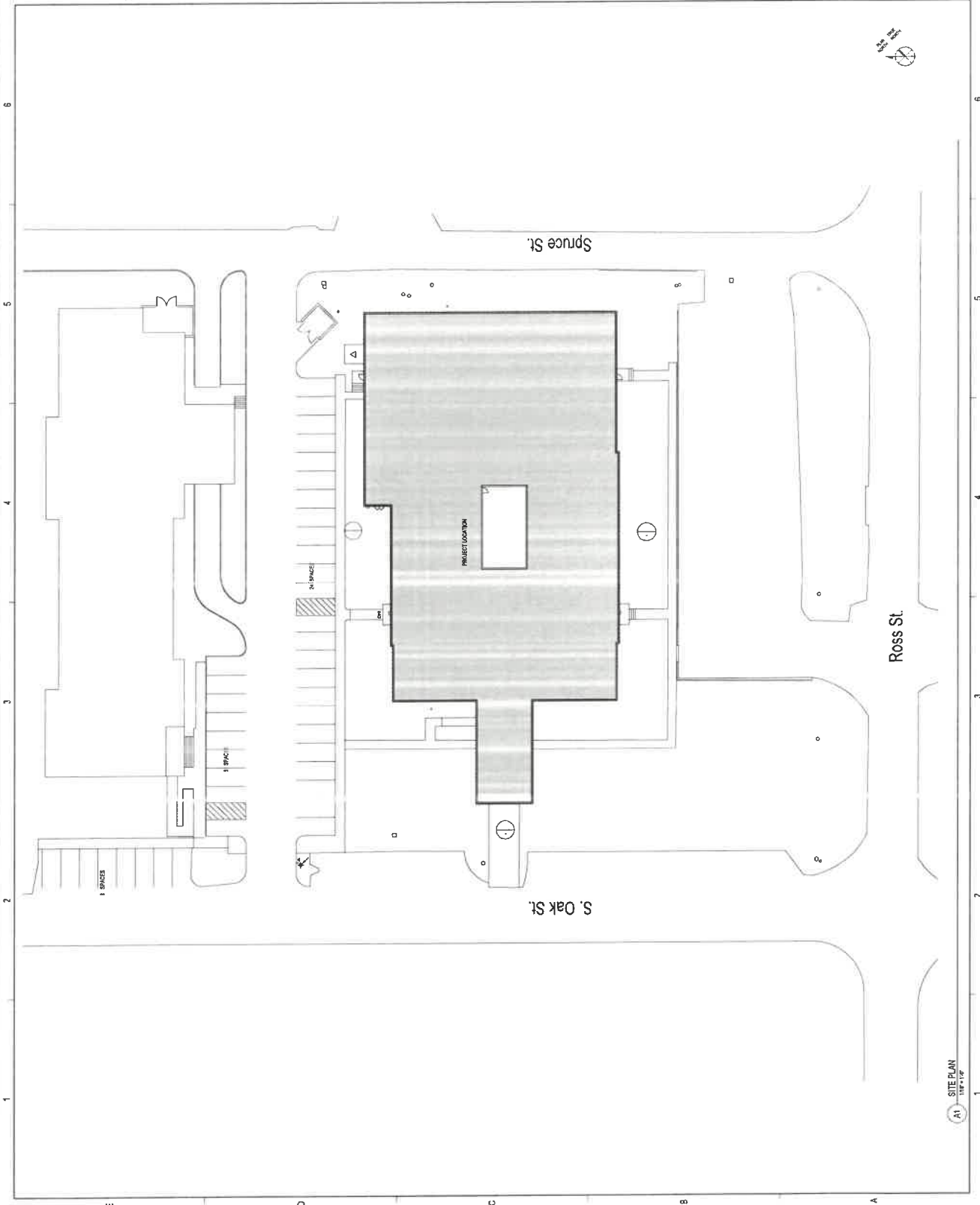

**101 SITE PLAN**  
 1/8" = 1' 0"



**HUITT ZOLLARS**  
 197 FARMAN ST. SUITE 4040  
 HOUSTON, TX 77002  
 713-672-1180  
 WWW.HUITT-ZOLLARS.COM

**ADVANCECESSION™**  
 1200 WEST WALKER STREET, SUITE 101  
 HOUSTON, TEXAS 77002  
 281-461-1000  
 CONTACT: LARRY HEDGECOCK  
 281-461-1000

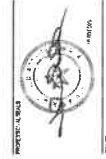

**GALVESTON COUNTY**  
 1200 West Walk, Seaworth, TX 77586

**MENTAL HEALTH  
 EXTENDED  
 OBSERVATION UNIT**

PROJECT LOCATION  
 1207 S Oak Street  
 La Marque, TX 77558

DATE: 11/15/2011  
 DRAWN BY: J. HUITT  
 CHECKED BY: J. HUITT  
 APPROVED BY: J. HUITT

NO.	DATE	DESCRIPTION
1	11/15/2011	ISSUED FOR PERMIT

PROJECT NO: 1207-01  
 DRAWN BY: J. HUITT  
 CHECKED BY: J. HUITT  
 APPROVED BY: J. HUITT

**DEMOLITION PLAN**

**AD-101**  
 DATE: 11/15/2011  
 DRAWN BY: J. HUITT

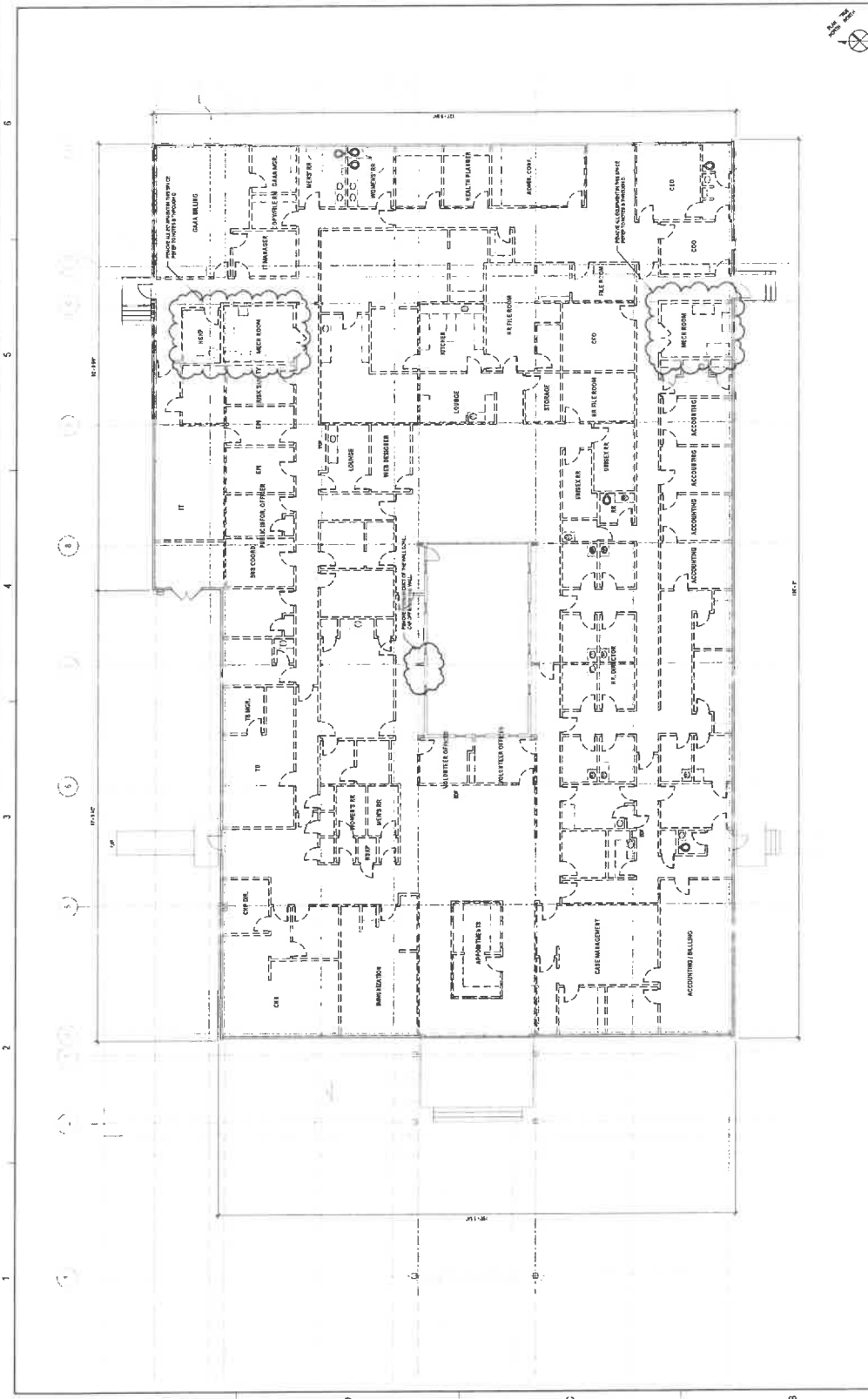

81 LEVEL 1 DEMOLITION PLAN  
 1/8" = 1'-0"

**DEMOLITION GRAPHIC LEGEND**

- ROOM TO BE DEMOLISHED
- EXISTING STRUCTURAL COLUMN
- EXISTING TO REMAIN
- TO BE DEMOLISHED

**GENERAL NOTES - DEMOLITION**

- A. GENERAL CONTRACTOR TO FIELD VERIFY EXISTING CONDITIONS AND REPORT TO THE ARCHITECT. ANY DISCREPANCIES SHALL BE REPORTED TO THE ARCHITECT IMMEDIATELY.
- B. REMOVE ALL EXISTING INTERIOR FINISHES (PAINTS, PLASTER, GYP SOFFIT, CEILING, PARTITION WALLS, ETC.) TO EXPOSE STRUCTURE TO BE DEMOLISHED.
- C. REMOVE ALL EXISTING INTERIOR MECHANICAL EQUIPMENT AND ALL EXISTING INTERIOR ELECTRICAL EQUIPMENT, WHICH SHALL BE DISPOSED OF BY THE CONTRACTOR. REMOVE ALL EXISTING INTERIOR WALLS, WHICH SHALL BE DISPOSED OF BY THE CONTRACTOR. REMOVE ALL EXISTING INTERIOR FLOORING, WHICH SHALL BE DISPOSED OF BY THE CONTRACTOR.
- D. REMOVE ALL EXISTING INTERIOR ELECTRICAL EQUIPMENT, WHICH SHALL BE DISPOSED OF BY THE CONTRACTOR. REMOVE ALL EXISTING INTERIOR WALLS, WHICH SHALL BE DISPOSED OF BY THE CONTRACTOR.
- E. REMOVE ALL EXISTING INTERIOR MECHANICAL EQUIPMENT, WHICH SHALL BE DISPOSED OF BY THE CONTRACTOR.
- F. REMOVE ALL EXISTING INTERIOR WALLS, WHICH SHALL BE DISPOSED OF BY THE CONTRACTOR. REMOVE ALL EXISTING INTERIOR FLOORING, WHICH SHALL BE DISPOSED OF BY THE CONTRACTOR.
- G. REMOVE INTERIOR OF THIS BUILDING TO EXPOSE ALL EXISTING STRUCTURE TO BE DEMOLISHED. REMOVE ALL EXISTING INTERIOR FINISHES TO EXPOSE STRUCTURE TO BE DEMOLISHED.
- H. REMOVE ALL INTERIOR FLOOR FINISHES TO EXPOSE CONCRETE SLAB.

















